

**NOTES CONTINUED:**  
 ⑤ SCRIBE, ENGRAVE, OR MECHANICALLY STAMP (NO INKS OR DYES) DRAWING PART NUMBER AND REVISION ON NOTED SURFACE FOLLOWED ON THE NEXT LINE BY A THREE DIGIT SERIAL NUMBER. SERIAL NUMBERS START AT 001 FOR THE FIRST ARTICLE AND PROCEED CONSECUTIVELY. USE .07" HIGH CHARACTERS. EXAMPLE: DXXXXXX-VY, S/N 001. A VIBRATORY TOOL MAY BE USED.

**POST-MANUFACTURING NOTES:**  
 P1. CLEAN TO LIGO STANDARDS, CLASS A (PER E0900047 AND E960022).

REV.	DATE	DCN #	DRAWING TREE #
V1	28 Apr 2009	-	-
-	-	-	-
-	-	-	-

D  
C  
B  
A

D  
C  
B  
A

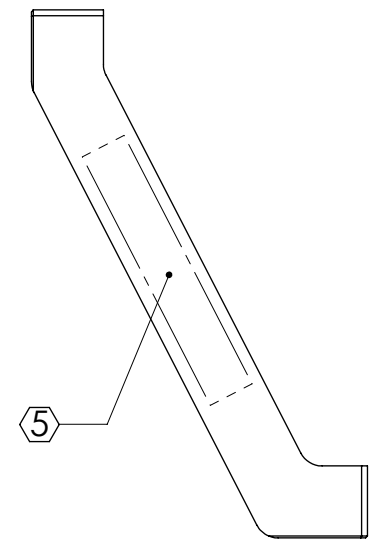
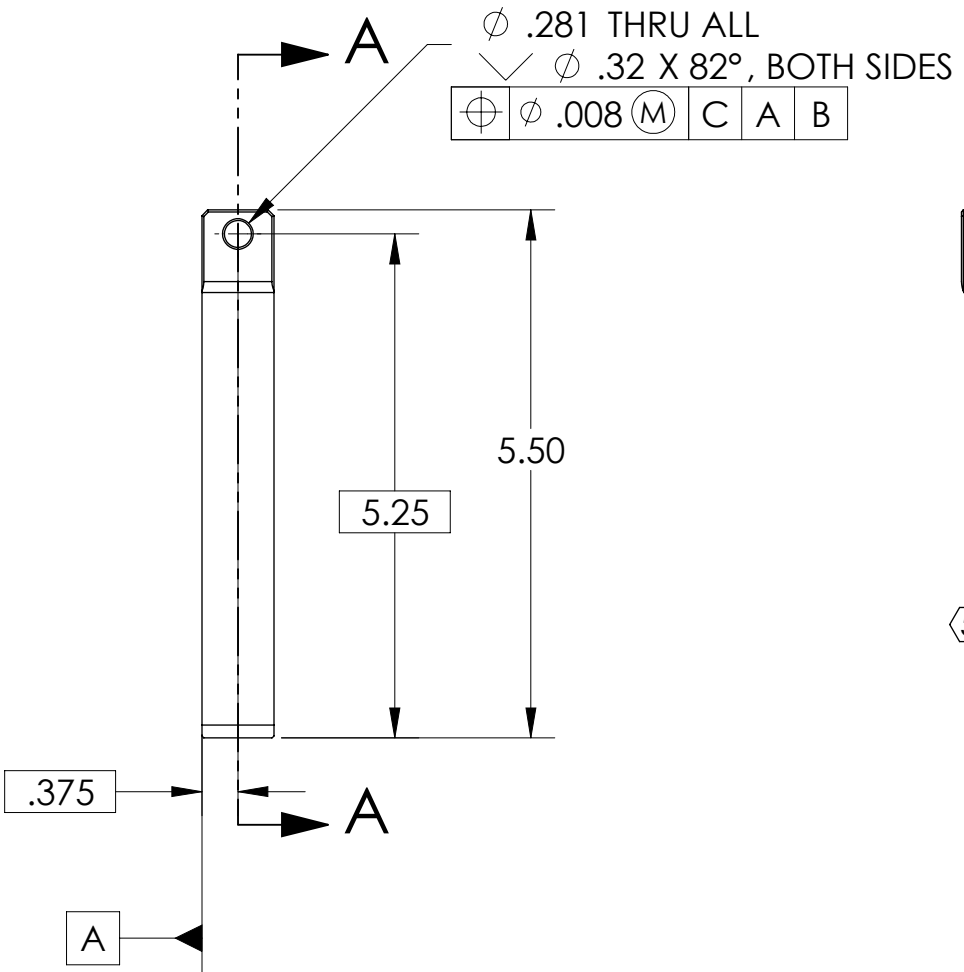
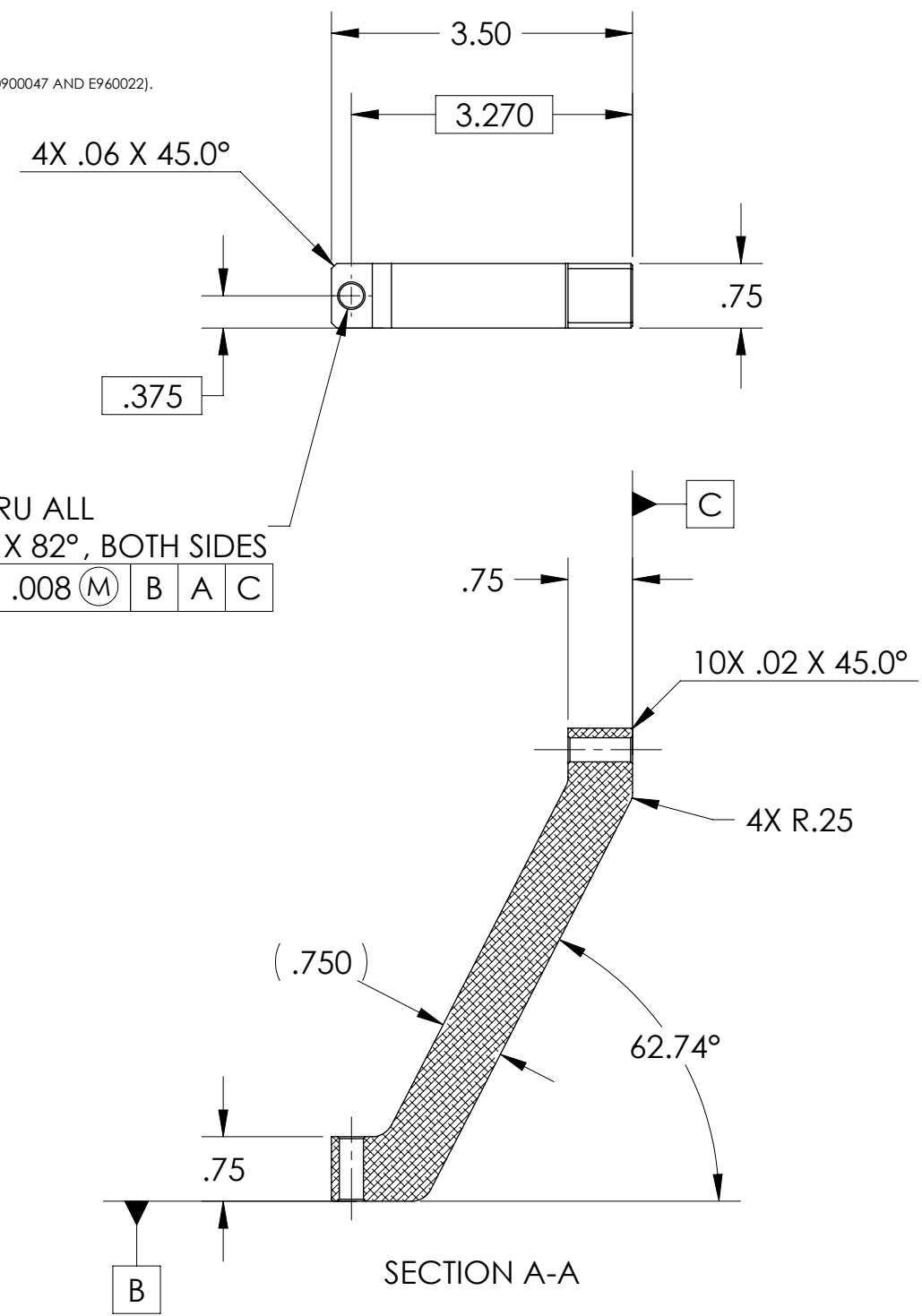

Mass = 0.35 lbs

**NOTES AND TOLERANCES: (UNLESS OTHERWISE SPECIFIED)**

DIMENSIONS ARE IN INCHES

TOLERANCES:  
 .XX ± .015  
 .XXX ± .005  
 ANGULAR ± 0.5°

1. INTERPRET DRAWING PER ASME Y14.5-1994.  
 2. REMOVE ALL SHARP EDGES, R.02 MIN.  
 3. DO NOT SCALE FROM DRAWING.  
 4. ALL MACHINING FLUIDS SHALL BE WATER SOLUBLE AND FREE OF SULFUR, CHLORINE AND SILICONE, SUCH AS CINCINNATI MILACRON'S CIMTECH 410.

**MATERIAL** 6061-T6 Al **FINISH** 63 μinch

**LIGO** CALIFORNIA INSTITUTE OF TECHNOLOGY  
 MASSACHUSETTS INSTITUTE OF TECHNOLOGY

**SYSTEM** ADVANCED LIGO **SUB-SYSTEM** SEI

**NEXT ASSY** D0900317

**PART NAME** Gusset, Horiz L4-C, HAM ISI

<b>DESIGNER</b>	astein	21 Apr 2009	<b>SIZE</b>	DWG. NO.	<b>REV.</b>
<b>DRAFTER</b>	sbarnum	27 Apr 2009	<b>B</b>	D0900320	v1
<b>CHECKER</b>	astein.32	27 Apr 2009	<b>SCALE:</b>	1:2	<b>PROJECTION:</b>
<b>APPROVAL</b>	astein	27 Apr 2009	SHEET 1 OF 1		

D0900320\_Gusset-Horz\_L4-C-HAM\_ISI, PART PDM REV: X-003, DRAWING PDM REV: X-001

8 7 6 5 4 3 2 1