

NOTES CONTINUED:
 ⑤ SCRIBE, ENGRAVE, OR MECHANICALLY STAMP (NO INKS OR DYES) DRAWING PART NUMBER AND REVISION ON NOTED SURFACE FOLLOWED ON THE NEXT LINE BY A THREE DIGIT SERIAL NUMBER. SERIAL NUMBERS START AT 001 FOR THE FIRST ARTICLE AND PROCEED CONSECUTIVELY. USE .07" HIGH CHARACTERS. EXAMPLE: D0901352-VY, S/N 001. A VIBRATORY TOOL MAY BE USED.
 ⑥ SCRIBE, ENGRAVE OR MECHANICALLY STAMP TEXT, APPROX. WHERE SHOWN, LETTERING APPROX. .125" HIGH
 ⑦ SCRIBE, ENGRAVE OR MECHANICALLY STAMP TEXT, APPROX. WHERE SHOWN, LETTERING APPROX. .500" HIGH

REV.	DATE	DCN #	DRAWING TREE #
-	-	REFER TO E0900200-v1	-
-	-	-	-
-	-	-	-

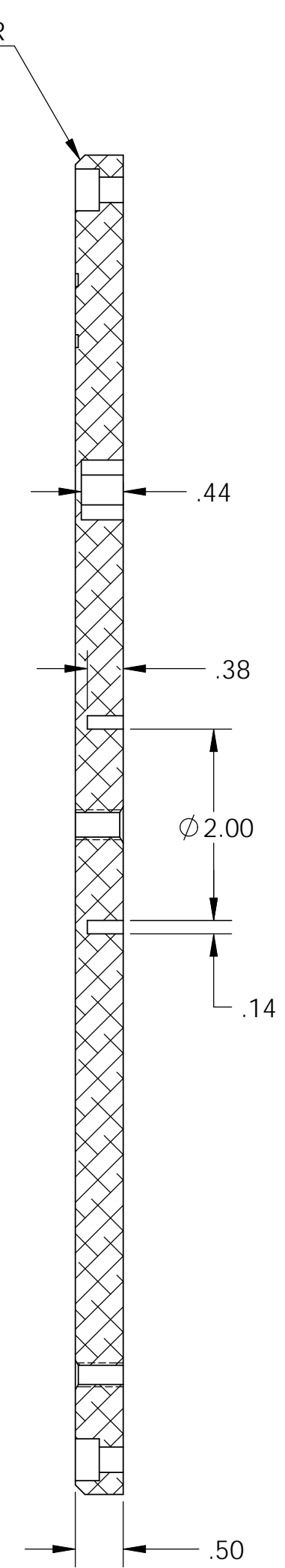

SECTION A-A
SCALE 1 : 1.5

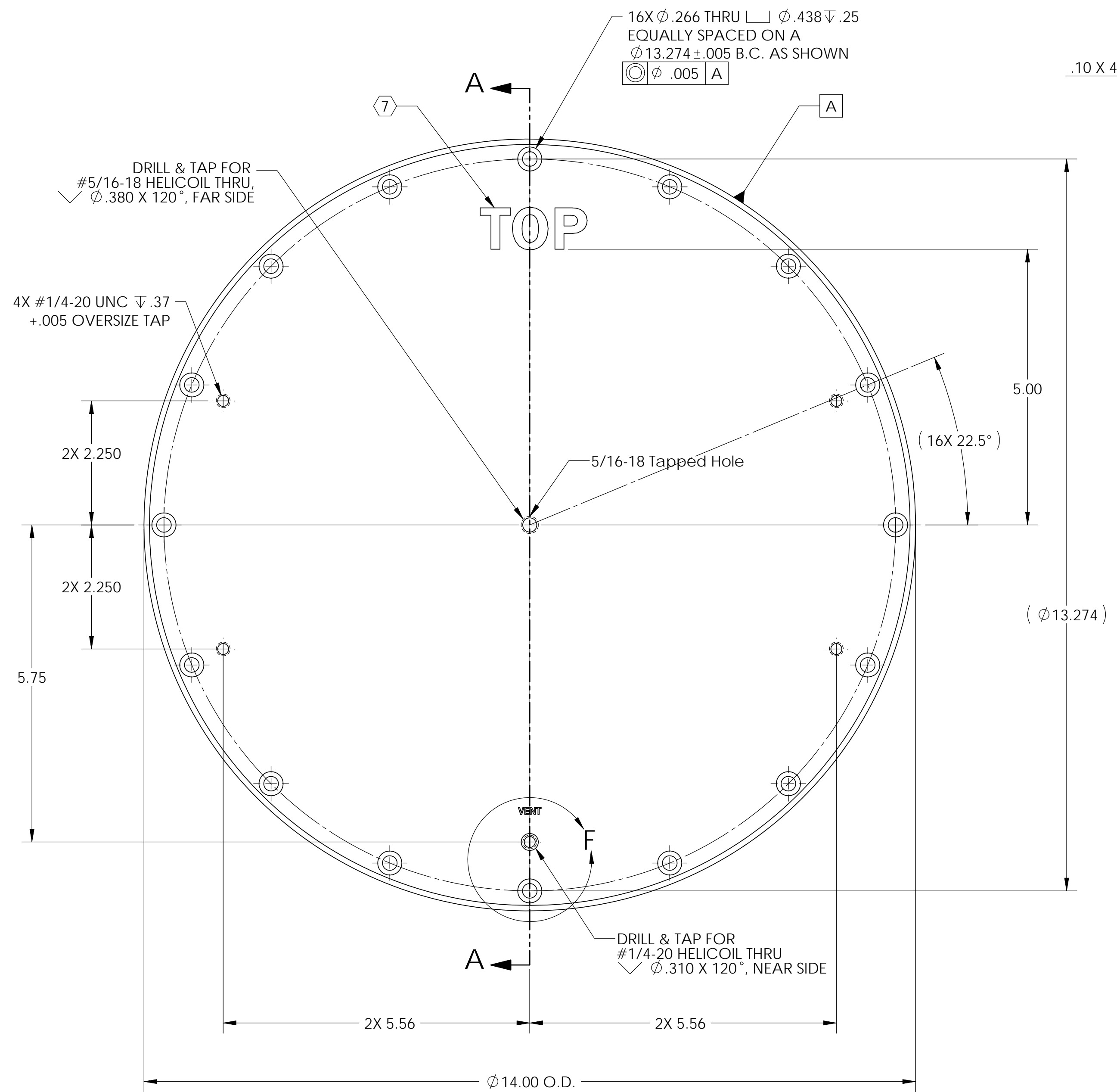
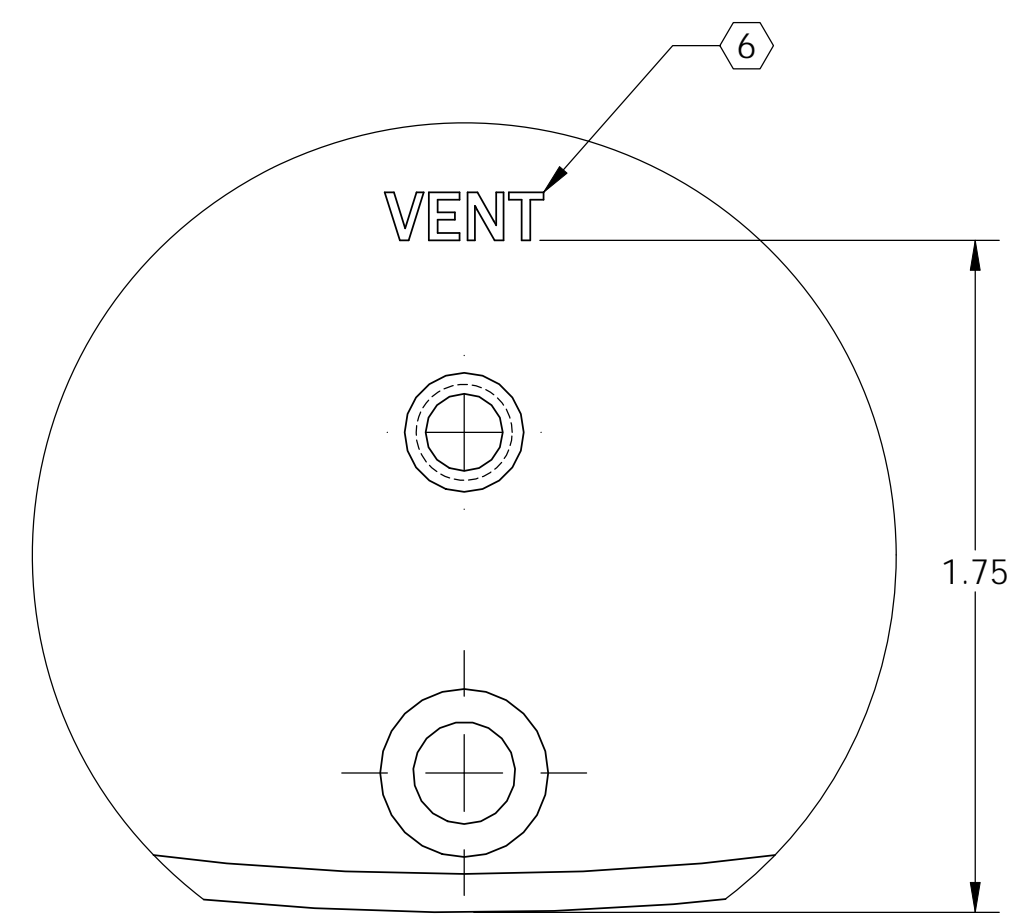
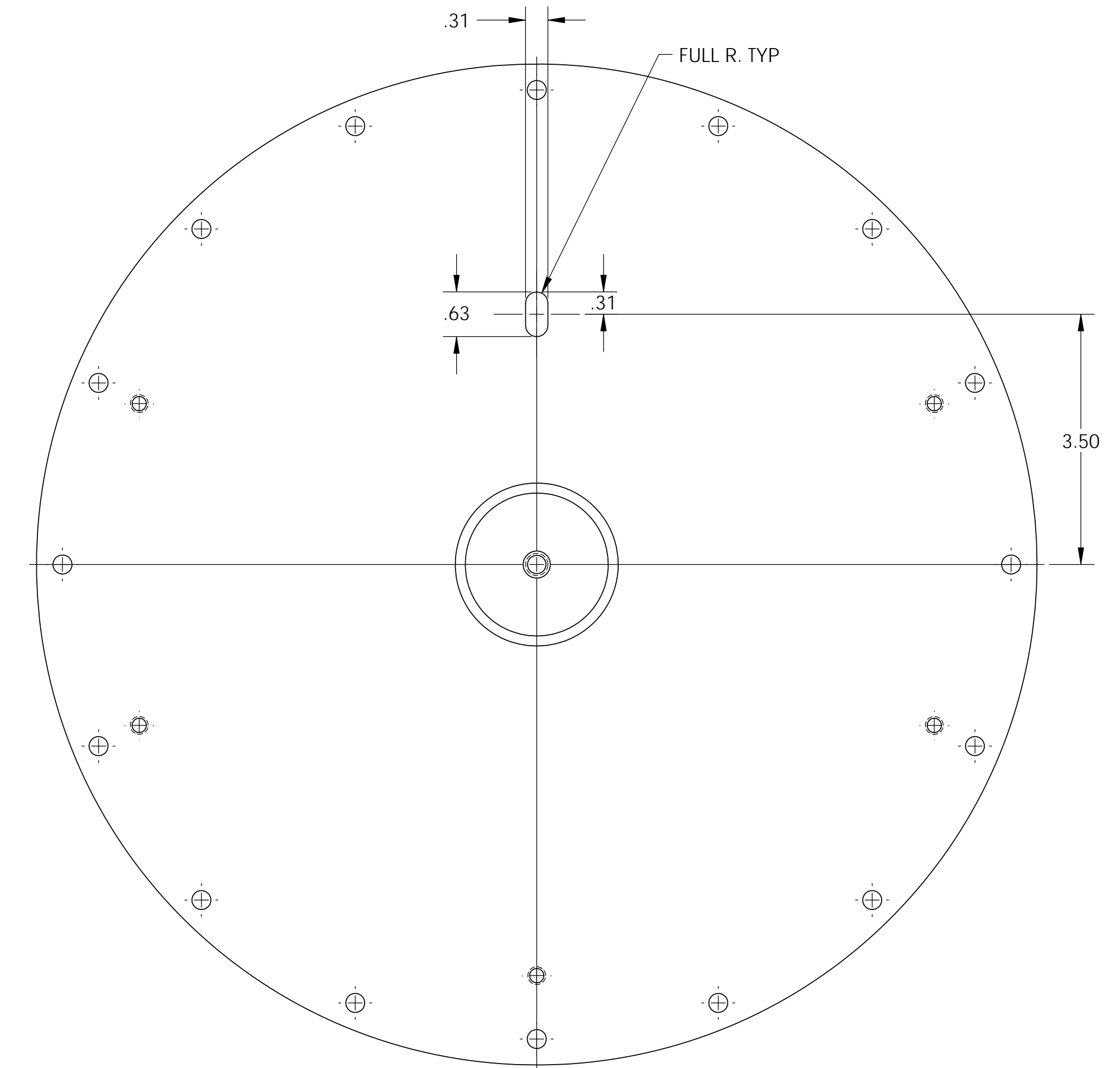

DETAIL F
SCALE 2 : 1

NOTES AND TOLERANCES: (UNLESS OTHERWISE SPECIFIED)	
1. INTERPRET DRAWING PER ASME Y14.5-1994.	
2. REMOVE ALL SHARP EDGES, R 02 MIN.	
3. DO NOT SCALE FROM DRAWING.	
4. ALL MACHINING FLUIDS SHALL BE WATER SOLUBLE AND FREE OF SULFUR, CHLORINE AND SILICONE, SUCH AS CINCINNATI MILACRON'S CIMTECH 410.	
DIMENSIONS ARE IN INCHES	
TOLERANCES:	
.XX ± 0.01	
.XXX ± 0.005	
ANGULAR ± 0.5°	
MATERIAL	6061-T6 Alum
FINISH	32 μinch

CALIFORNIA INSTITUTE OF TECHNOLOGY MASSACHUSETTS INSTITUTE OF TECHNOLOGY		PART NAME	
SYSTEM	ADVANCED LIGO	Cover, Lid, R Optic Container	
SUB-SYSTEM	COC	DESIGNER	ED CHAVEZ
NEXT ASSY	SR Optic Container	DRAFTER	ED CHAVEZ
		CHECKER	REFER TO E0900200-v1
		APPROVAL	REFER TO E0900200-v1
		DATE	15 JUN 2009
		SIZE	D
		DWG. NO.	D0901352
		REV.	v1
		SCALE	1:2
		PROJECTION	AS SHOWN
		SHEET 1 OF 1	

D0901352-Cover, Lid, Alum, Bore, Rnd, SR, PART PDM REV: X-002, DRAWING PDM REV: X-001