

NOTES CONTINUED:
 ⑤ SCRIBE, ENGRAVE, OR MECHANICALLY STAMP (NO INKS OR DYES) DRAWING PART NUMBER AND REVISION ON NOTED SURFACE FOLLOWED ON THE NEXT LINE BY A THREE DIGIT SERIAL NUMBER. SERIAL NUMBERS START AT 001 FOR THE FIRST ARTICLE AND PROCEED CONSECUTIVELY. USE .07" HIGH CHARACTERS. EXAMPLE: DXXXXXX-VY, S/N 001. A VIBRATORY TOOL MAY BE USED.

REV.	DATE	DCN #	DRAWING TREE #
-	-	REFER TO E0900200-v1	-
-	-	-	-
-	-	-	-

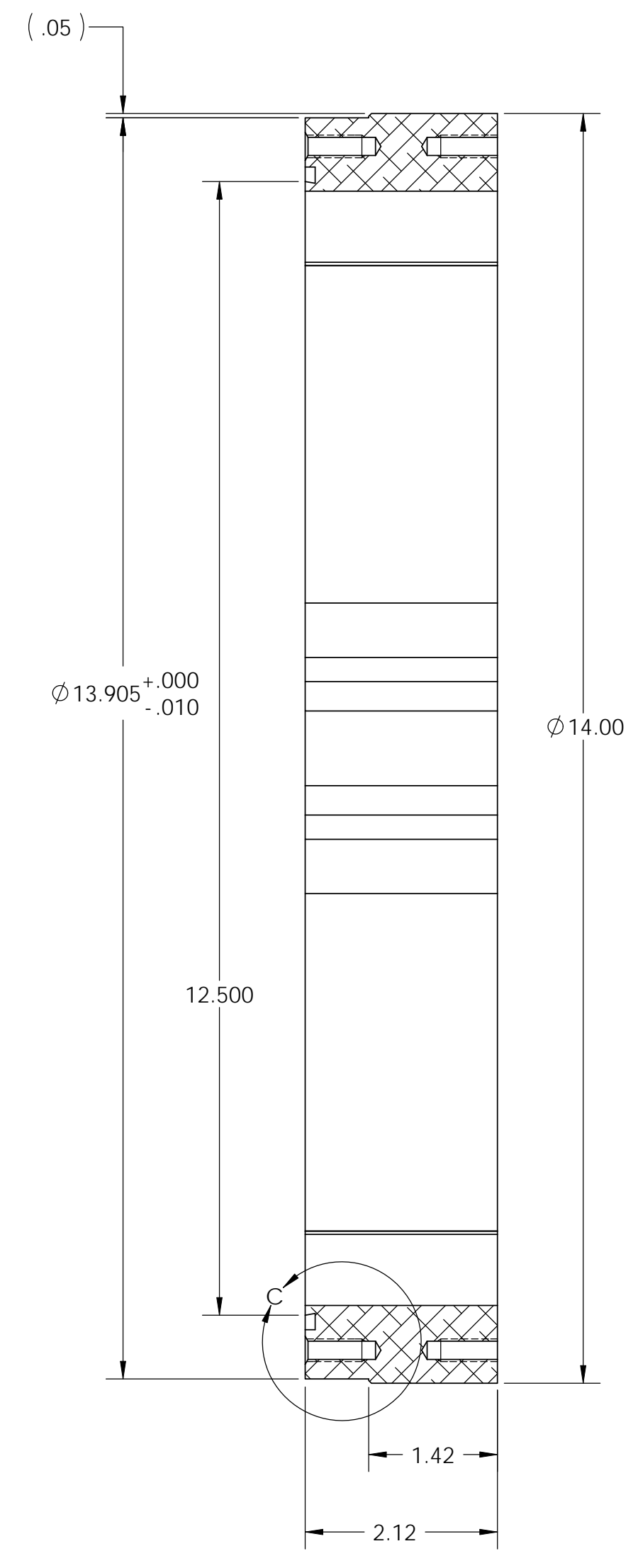

SECTION A-A
SCALE 1 : 1.5

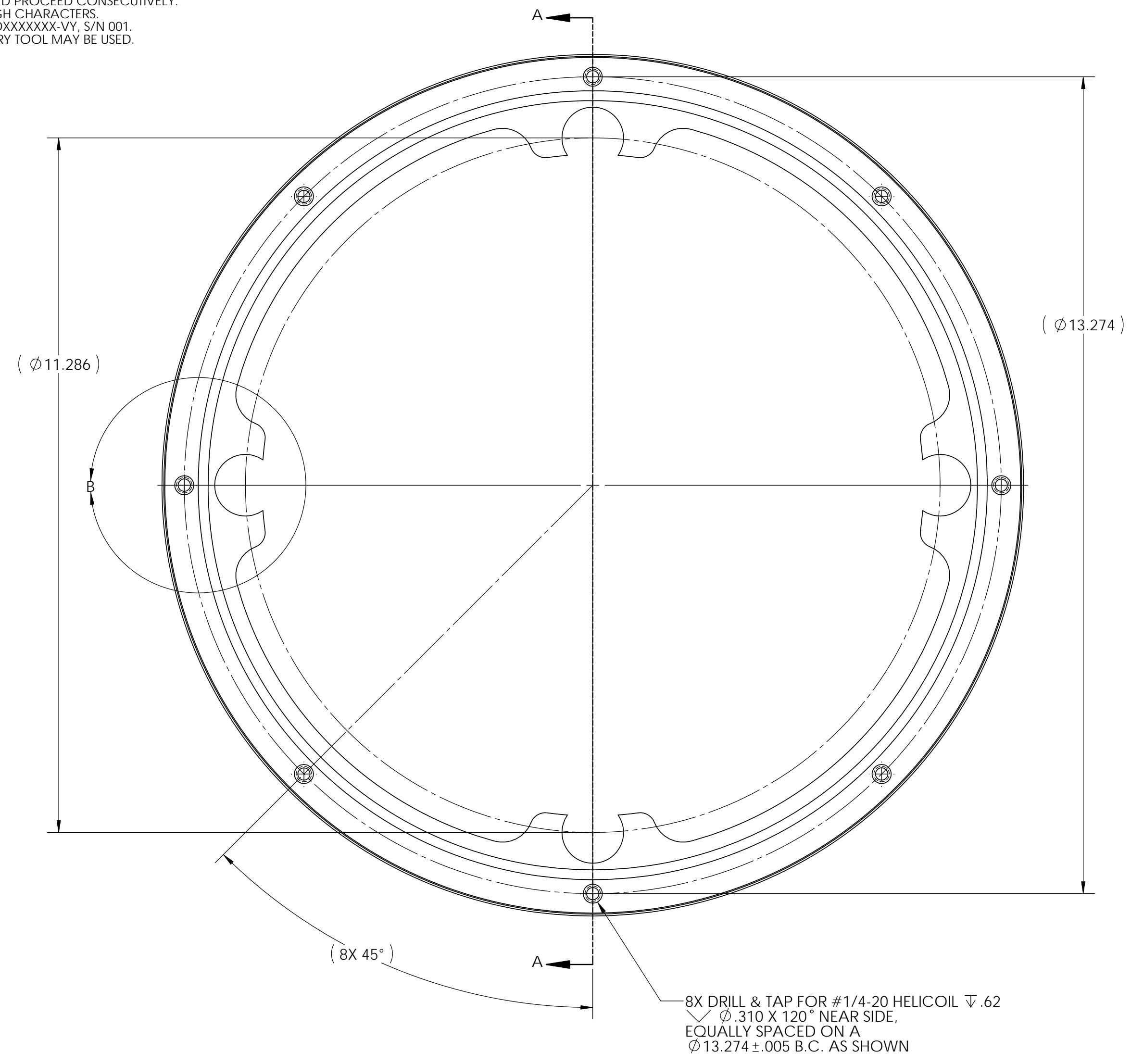
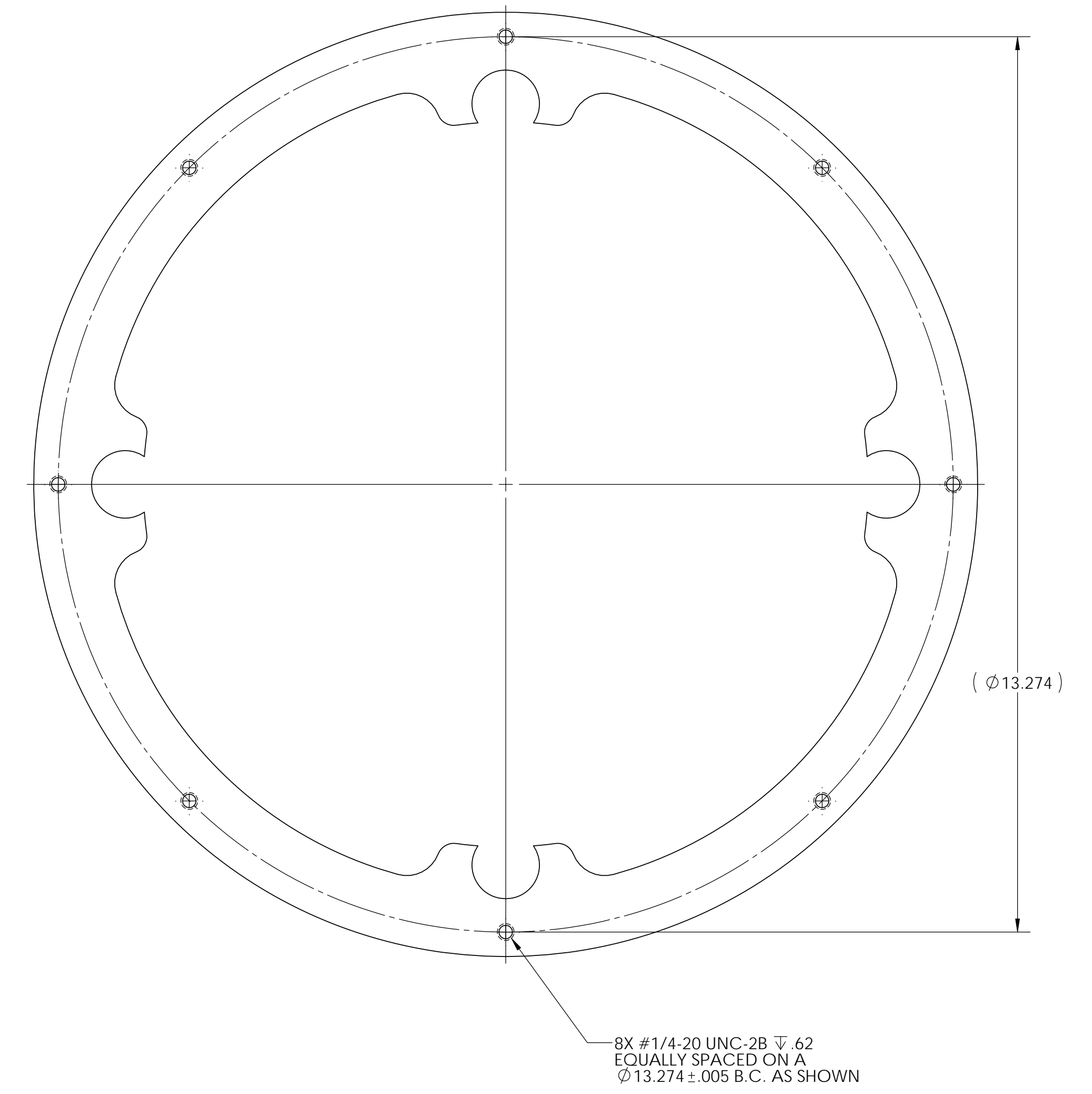

8X #1/4-20 UNC-2B ∇ .62
 EQUALLY SPACED ON A
 ϕ 13.274 \pm .005 B.C. AS SHOWN

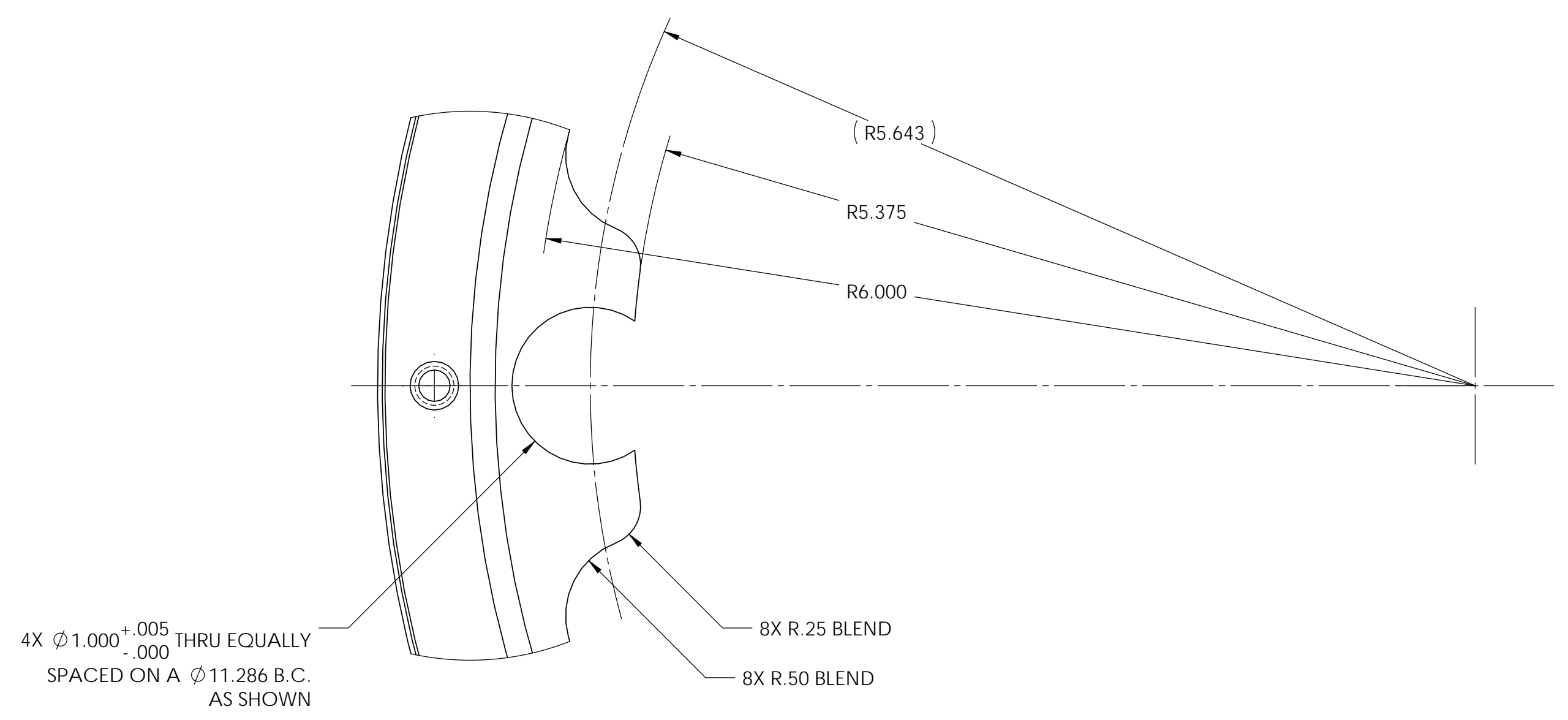

DETAIL B
SCALE 2 : 1.5

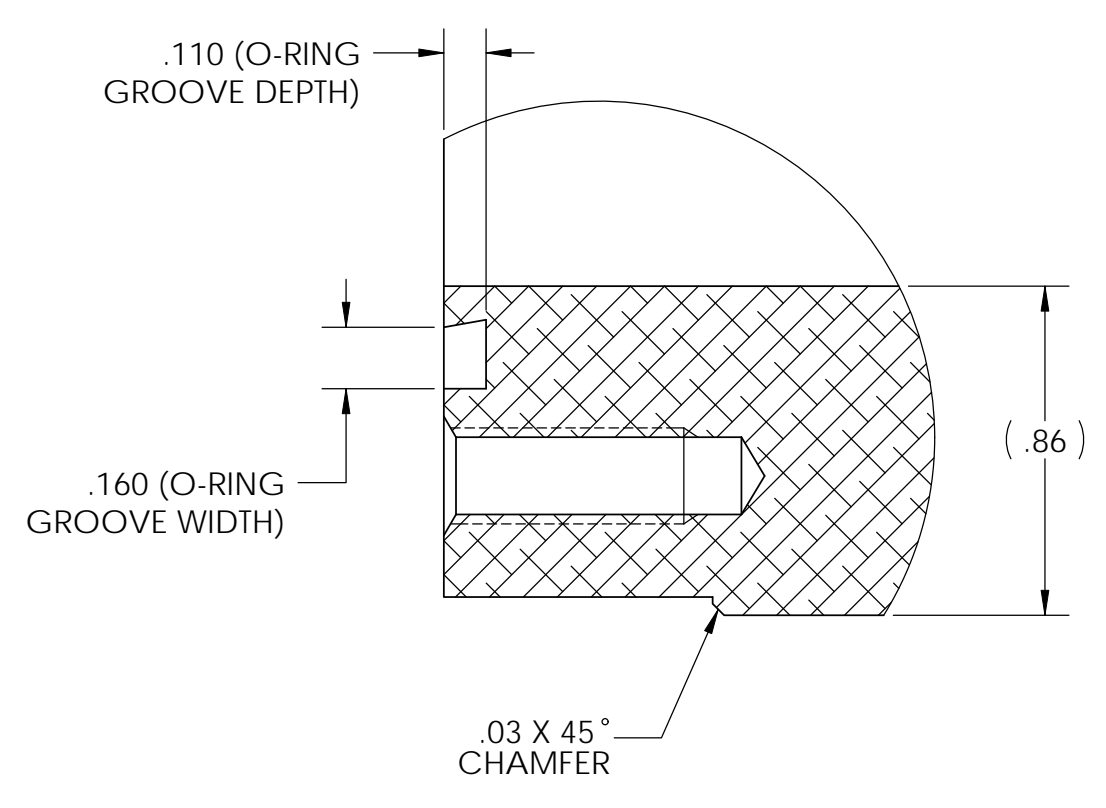

DETAIL C
SCALE 2 : 1

DIMENSIONS ARE IN UNITS		TOLERANCES:		ANGULAR \pm 0.5°		NOTES AND TOLERANCES: (UNLESS OTHERWISE SPECIFIED)		MATERIAL		FINISH		NEXT ASSY		PART NAME		DESIGNER		DRAFTER		CHECKER		APPROVAL	
XX \pm 0.01		XXX \pm 0.005				1. INTERPRET DRAWING PER ASME Y14.5-1994. 2. REMOVE ALL SHARP EDGES, R.02 MIN. 3. DO NOT SCALE FROM DRAWING. 4. ALL MACHINING FLUIDS SHALL BE WATER SOLUBLE AND FREE OF SULFUR, CHLORINE AND SILICONE, SUCH AS CINCINNATI MILACRON'S CIMTECH 410.		6061-T6 Alum		32 μ inch		SR Optic Container		Base, Ring, R Optic Container		ED CHAVEZ		ED CHAVEZ		REFER TO E0900200-v1		REFER TO E0900200-v1	

D0901355 Base, Ring, Alum Base, Rev. SR, PART PDM REV. X-002, DRAWING PDM REV. X-001