

SECTION A-A

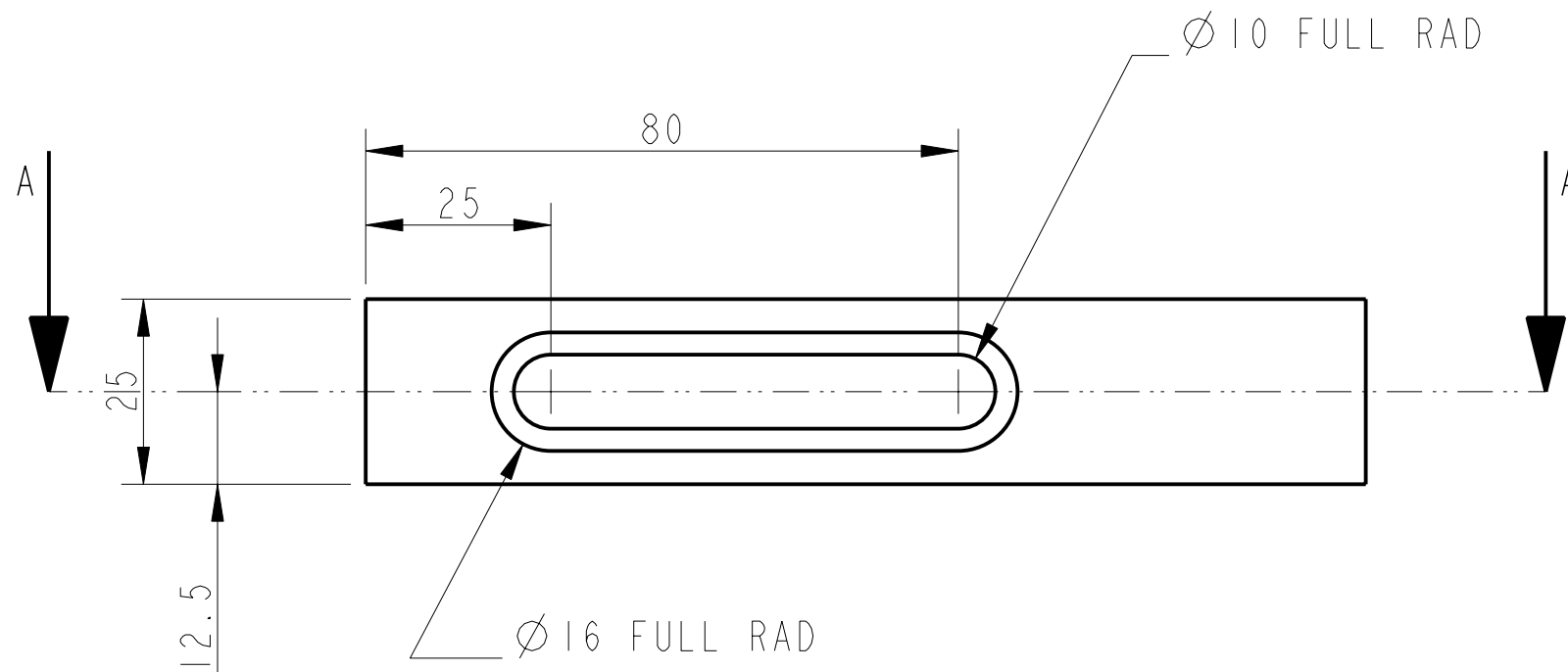

NOTES: (UNLESS OTHERWISE SPECIFIED)		CALIFORNIA INSTITUTE OF TECHNOLOGY MASSACHUSETTS INSTITUTE OF TECHNOLOGY IGR, GLASGOW UNIVERSITY GEO 600 GROUP RUTHERFORD APPLETON LABORATORIES		
1. REMOVE ALL SHARP EDGES, R.02 MIN. 2. DO NOT SCALE FROM DRAWING. 3. ALL MACHINING FLUIDS SHALL BE WATER SOLUBLE AND FREE OF SULFUR, CHLORINE AND SILICONE, SUCH AS CINCINNATI MILACRON'S CIMTECH 410 (STAINLESS STEEL) 4. SCRIBE, ENGRAVE OR STAMP DRAWING PARTNUMBER ON NOTED SURFACE OF PART AND A THREE DIGIT SERIAL NUMBER. SERIAL NUMBERS START AT 001 FOR THE FIRST PART AND PROCEED CONSECUTIVELY. USE .07" HIGH CHARACTERS. EXAMPLE: D020188- 001. A VIBRATORY TOOL MAY BE USED.	DIMENSIONS ARE IN mm [INCHES]		SYSTEM ADVANCED LIGO SUB-SYSTEM SUS NEXT ASSY QUAD N-PTYPE PART NAME QUAD DOG CLAMP	
	TOLERANCES:			
	MATERIAL: ST STEEL 300 SERIES			
	FINISH: CLEAN AND DEGREASED $\sqrt{\mu m}$ [μin] Ra = 1.6			
	DRAWN	I WILMUT	22/Feb/07	SIZE B DRG. NO. D070056 REV A.
	CHECKED	J'OD	22/FEB/07	
	APPROVED	IW	23/FEB/07	
SCALE 1:1		PROJECTION:		SHEET 1 OF 1