

8

7

6

5

4

3

2

1

INTRALINK NAME: D070236

REV.	DATE	DCN #	DRAWING TREE #

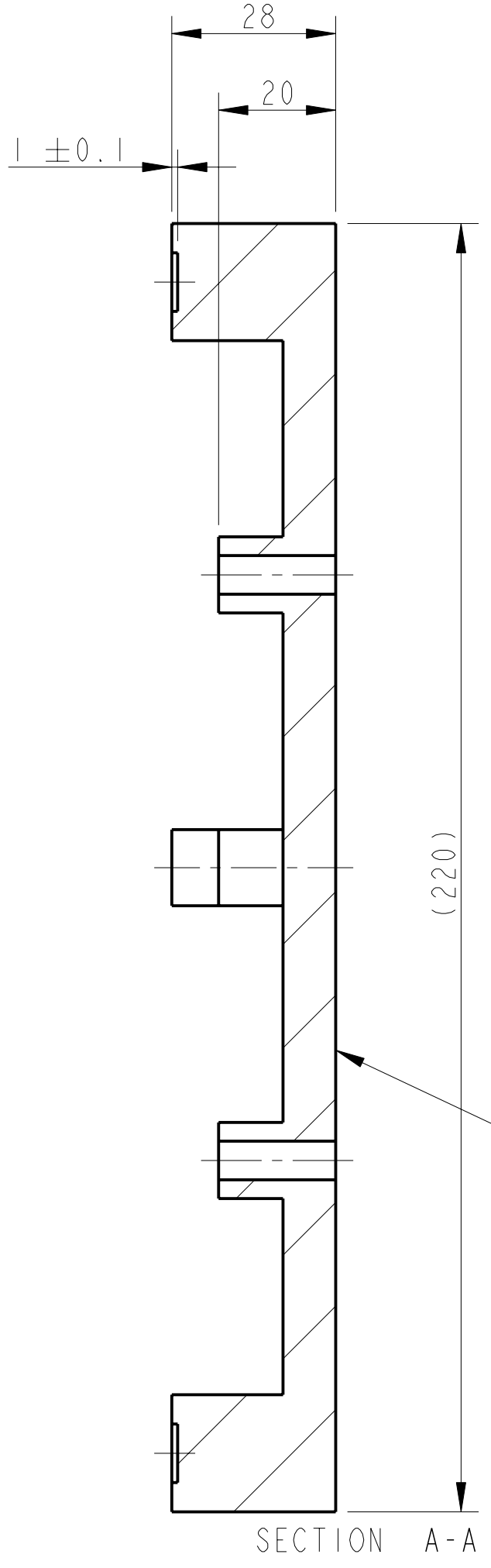
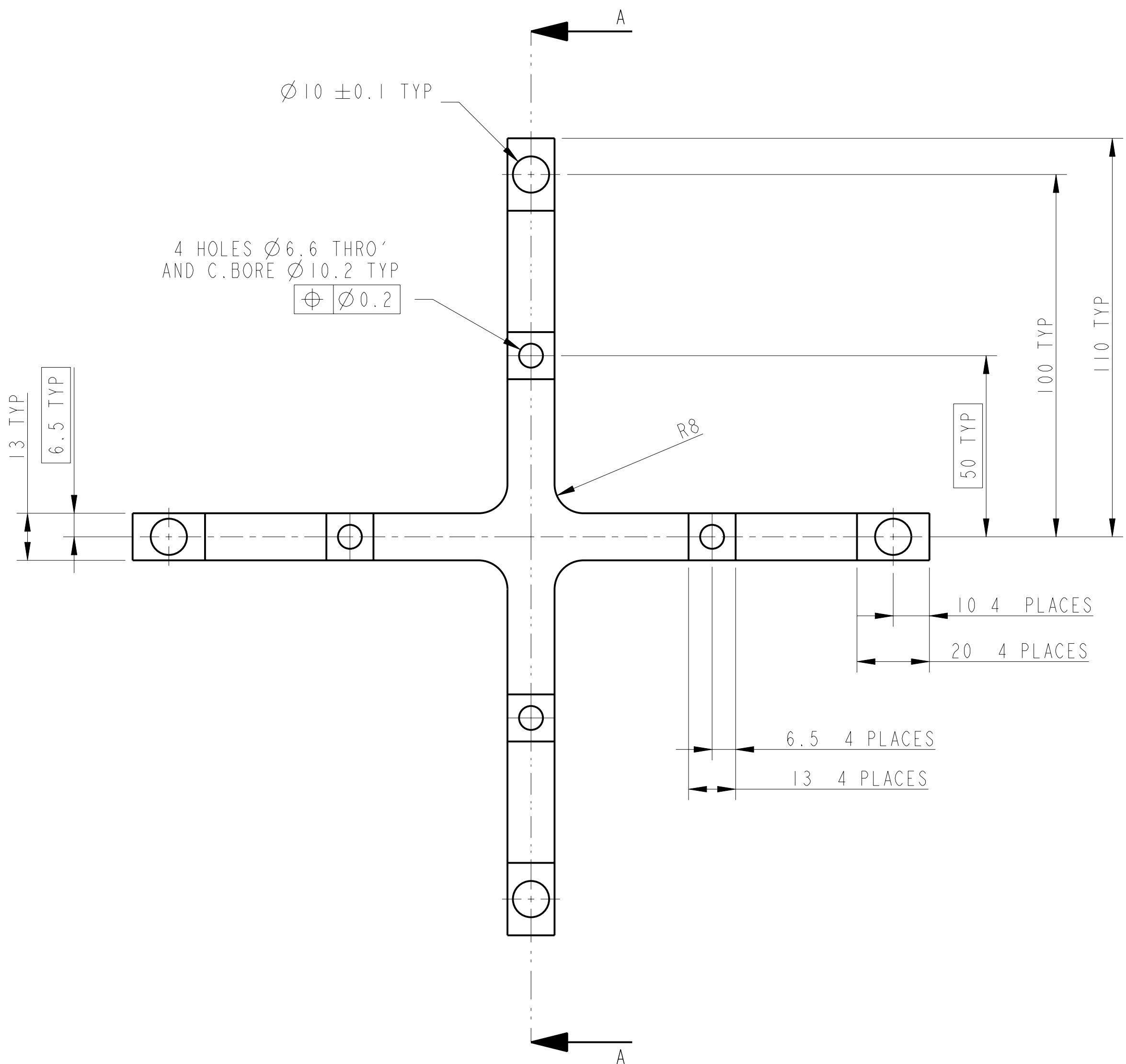

4 HOLES  $\varnothing 6.6$  THRO'  
AND C.BORE  $\varnothing 10.2$  TYP

$\varnothing 10 \pm 0.1$  TYP

$\varnothing 6.6$  TYP

$\varnothing 10.2$  TYP

R8

50 TYP

100 TYP

110 TYP

10 4 PLACES

20 4 PLACES

6.5 4 PLACES

13 4 PLACES

0.05

SECTION A-A

NOTES: (UNLESS OTHERWISE SPECIFIED)				DIMENSIONS ARE IN mm [INCHES]				TOLERANCES:			
1. REMOVE ALL SHARP EDGES, R.02 MIN.				X.XX ± mm [INCHES]				ANGULAR ±0.25°			
2. DO NOT SCALE FROM DRAWING.				MATERIAL: AL ALLOY 5083				FINISH: CLEAN Ra = 1.6			
3. ALL MACHINING FLUIDS SHALL BE WATER SOLUBLE AND FREE OF SULFUR, CHLORINE AND SILICONE, SUCH AS CINCINNATI MILACRON'S CIMTECH 410 (STAINLESS STEEL)				DRAWN: J O'DELL 30/JUN/09				CHECKED: AJB 30/JUN/09			
4. SCRIBE, ENGRAVE OR STAMP DRAWING PART NUMBER ON NOTED SURFACE OF PART AND A THREE DIGIT SERIAL NUMBER. SERIAL NUMBERS START AT 001 FOR THE FIRST PART AND PROCEED CONSECUTIVELY. USE .07" HIGH CHARACTERS. EXAMPLE: D020188-001. A VIBRATORY TOOL MAY BE USED.				APPROVED: JOD 30/JUN/09				SCALE: 1:1 PROJECTION:  SHEET 1 OF 1			
CALIFORNIA INSTITUTE OF TECHNOLOGY				MASSACHUSETTS INSTITUTE OF TECHNOLOGY				GLASGOW UNIVERSITY GEO 600 GROUP			
RUTHERFORD APPLETON LABORATORIES				SYSTEM: ADVANCED LIGO				SUB-SYSTEM: SUS			
NEXT ASSY: PENULTIMATE MASS FLAG ASSY				PART NAME: PENULTIMATE MASS FLAG MOUNT				(EXTERNAL SHIELDED MAGNETS)			
DRG. NO. D070236				SCALE: 1:1 PROJECTION:  SHEET 1 OF 1				REV. B			