

REV.	DATE	DCN #	DRAWING TREE #
B	21/DEC/07	E060260-B	
C	22/JULY/08	E080372	

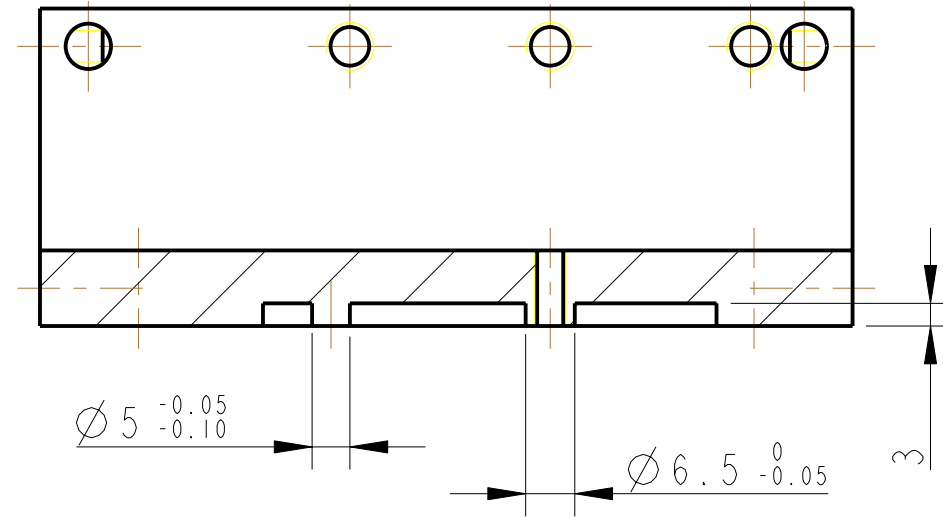

SECTION A-A

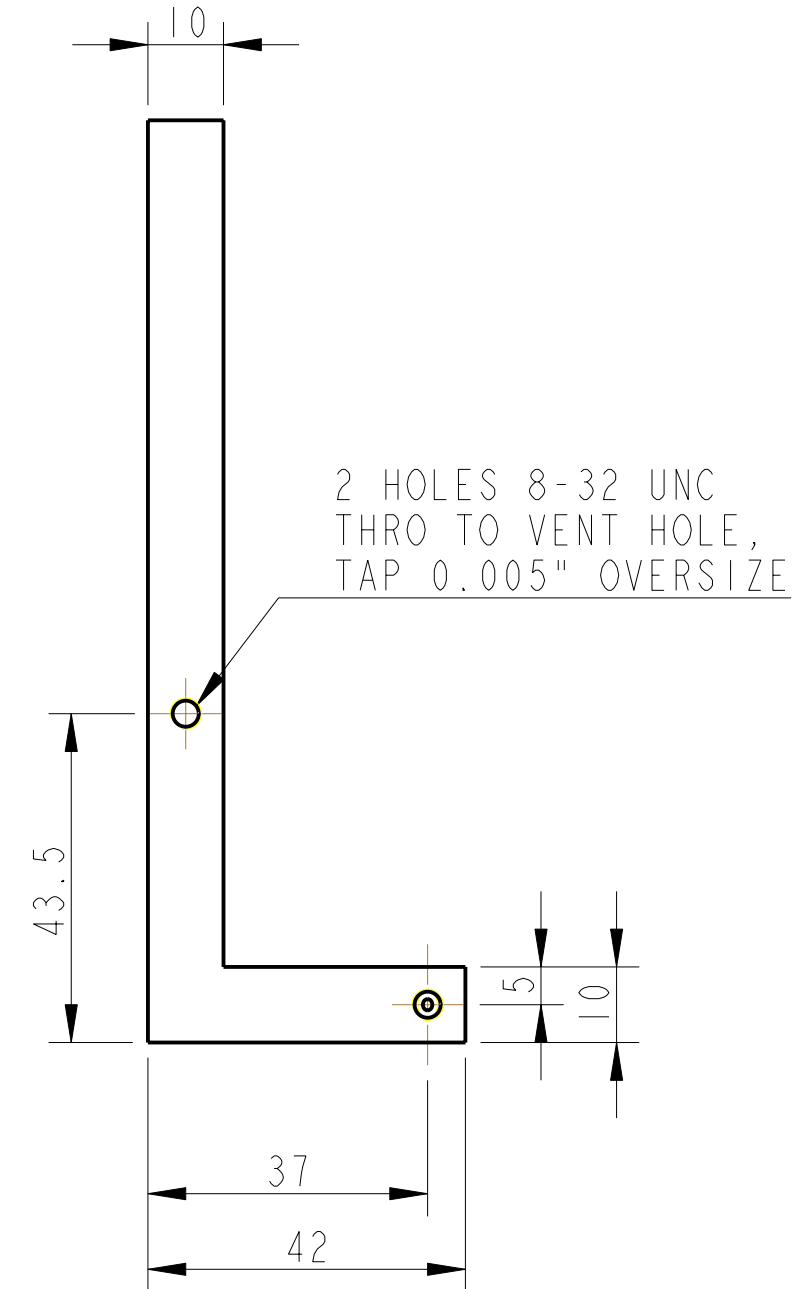
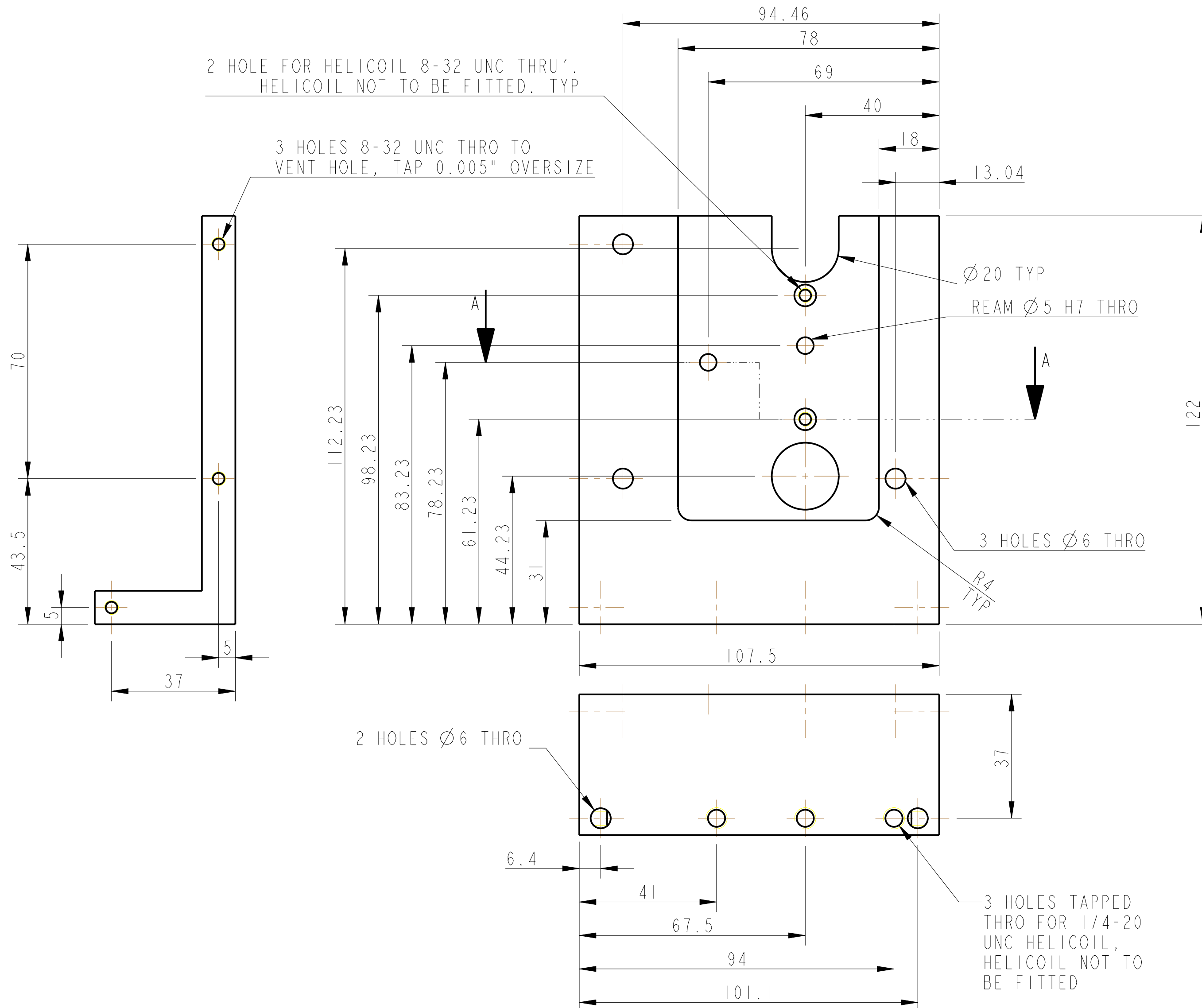

NOTES: (UNLESS OTHERWISE SPECIFIED)				CALIFORNIA INSTITUTE OF TECHNOLOGY	
1. REMOVE ALL SHARP EDGES, R.02 MIN.	DIMENSIONS ARE IN mm (INCHES)		IGOR, GLASGOW UNIVERSITY GEO 600 GROUP		
2. DO NOT SCALE FROM DRAWING.	TOLERANCES:		RUTHERFORD APPLETON LABORATORIES		
3. ALL MACHINING FLUIDS SHALL BE WATER SOLUBLE AND FREE OF SULFUR, CHLORINE AND SILICONE, SUCH AS CINCINNATI MILACRON'S CIMTECH 410 (STAINLESS STEEL)	X.XX ± mm (INCHES)		SYSTEM aLIGO		
4. SCRIBE, ENGRAVE OR STAMP DRAWING PART NUMBER ON NOTED SURFACE OF PART AND A THREE DIGIT SERIAL NUMBER. SERIAL NUMBERS START AT 001 FOR THE FIRST PART AND PROCEED CONSECUTIVELY. USE .07" HIGH CHARACTERS. EXAMPLE: D020188-001. A VIBRATORY TOOL MAY BE USED.	ANGULAR ±0.25°		SUB-SYSTEM SUS		
	MATERIAL: AL ALLOY 6061		NEXT ASSY D060454		
	FINISH: CLEAN AND DEGREASED √μm (μin) Ra = 1.6		PART NAME REACTION CHAIN UIM STOP		
	DRAWN: I WILMUT 29/NOV/07		LEFT HAND		
	CHECKED: MB 15/MAR/10		DRG. NO. D070546		
	APPROVED: JOD 15/MAR/10		SCALE 1:1 PROJECTION		
			SHEET 1 OF 1		