

REV.	DATE	DCN #	DRAWING TREE #

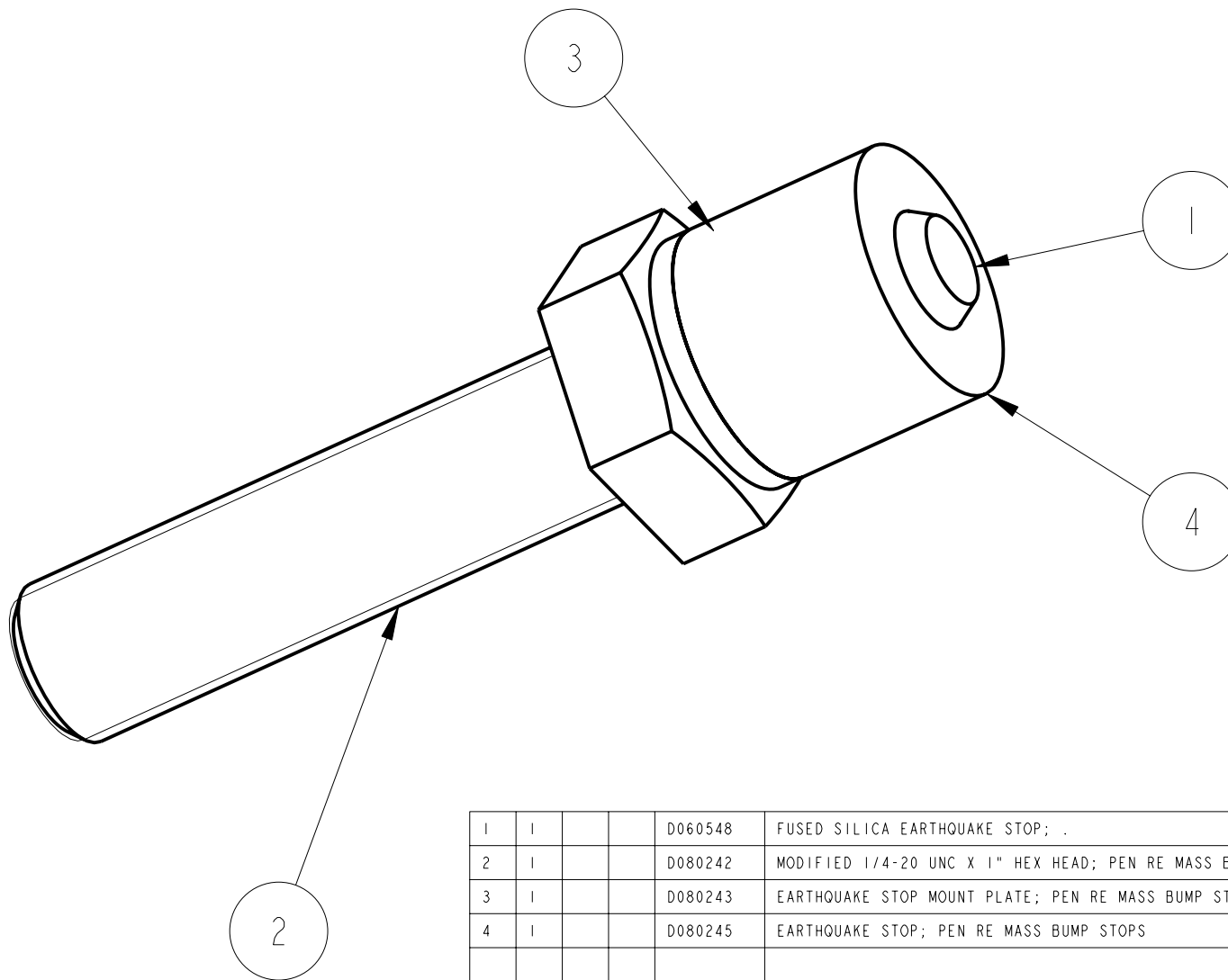

1	1			D060548	FUSED SILICA EARTHQUAKE STOP; .	FUSED SILICA: ANY GRADE
2	1			D080242	MODIFIED 1/4-20 UNC X 1" HEX HEAD; PEN RE MASS BUMP STOPS	ST. STEEL: 300 SERIES
3	1			D080243	EARTHQUAKE STOP MOUNT PLATE; PEN RE MASS BUMP STOPS	ST STEEL: 300 SERIES
4	1			D080245	EARTHQUAKE STOP; PEN RE MASS BUMP STOPS	FLOUREL: SEE NOTES
ITEM	QTY	SPARE	TOTAL	PART NUMBER	DESCRIPTION	MATERIALS
PARTS LIST						

NOTES: (UNLESS OTHERWISE SPECIFIED)

- REMOVE ALL SHARP EDGES, R.02 MIN.
- DO NOT SCALE FROM DRAWING.
- ALL MACHINING FLUIDS SHALL BE WATER SOLUBLE AND FREE OF SULFUR, CHLORINE AND SILICONE, SUCH AS CINCINNATI MILACRON'S CIMTECH 410 (STAINLESS STEEL)
- SCRIBE, ENGRAVE OR STAMP DRAWING PARTNUMBER ON NOTED SURFACE OF PART AND A THREE DIGIT SERIAL NUMBER. SERIAL NUMBERS START AT 001 FOR THE FIRST PART AND PROCEED CONSECUTIVELY. USE .07" HIGH CHARACTERS. EXAMPLE: D020188- 001. A VIBRATORY TOOL MAY BE USED.

DIMENSIONS ARE IN MM [INCHES]
TOLERANCES:

X.XX ± mm
ANGULAR ± °

MATERIAL: AS DRW

FINISH: Ra = AS DRW
√μm [μin]

	NAME	DATE
DRAWN	J O'DELL	24/APR/08
CHECKED	AJB	30/JUN/09
APPROVED	JOD	30/JUN/09



CALIFORNIA INSTITUTE OF TECHNOLOGY
MASSACHUSETTS INSTITUTE OF TECHNOLOGY
IGR, GLASGOW UNIVERSITY GEO 600 GROUP
RUTHERFORD APPLETON LABORATORIES

SYSTEM	ADVANCED LIGO
SUB-SYSTEM	ALIGO QUAD
NEXT ASSY	THIS
PART NAME	PEN RE MASS BUMP STOP ASM PENULTIMATE REACTION MASS

SIZE	DRG. NO.	REV
A	D080240	E.
SCALE 4:1	PROJECTION:	SHEET 1 OF 1