

8 7 6 5 4 3 2 1

NOTES CONTINUED:

5. PACKAGING SHALL INCLUDE DRAWING AND REVISION NUMBER, UNIQUE THREE DIGIT SERIAL NUMBER FOR EACH PART, AND QUANTITY. SERIAL NUMBERS START AT 001 FOR THE FIRST ARTICLE AND PROCEED CONSECUTIVELY. EXAMPLE (TAG): DXXXXXX-VY, TYPE-XX, QTY: TBD

6. APPROXIMATE WEIGHT = 0.365LB.

REV.	DATE	DCN #	DRAWING TREE #
-	-	E1100085	-
-	-	-	-
-	-	-	-

D  
C  
B  
A

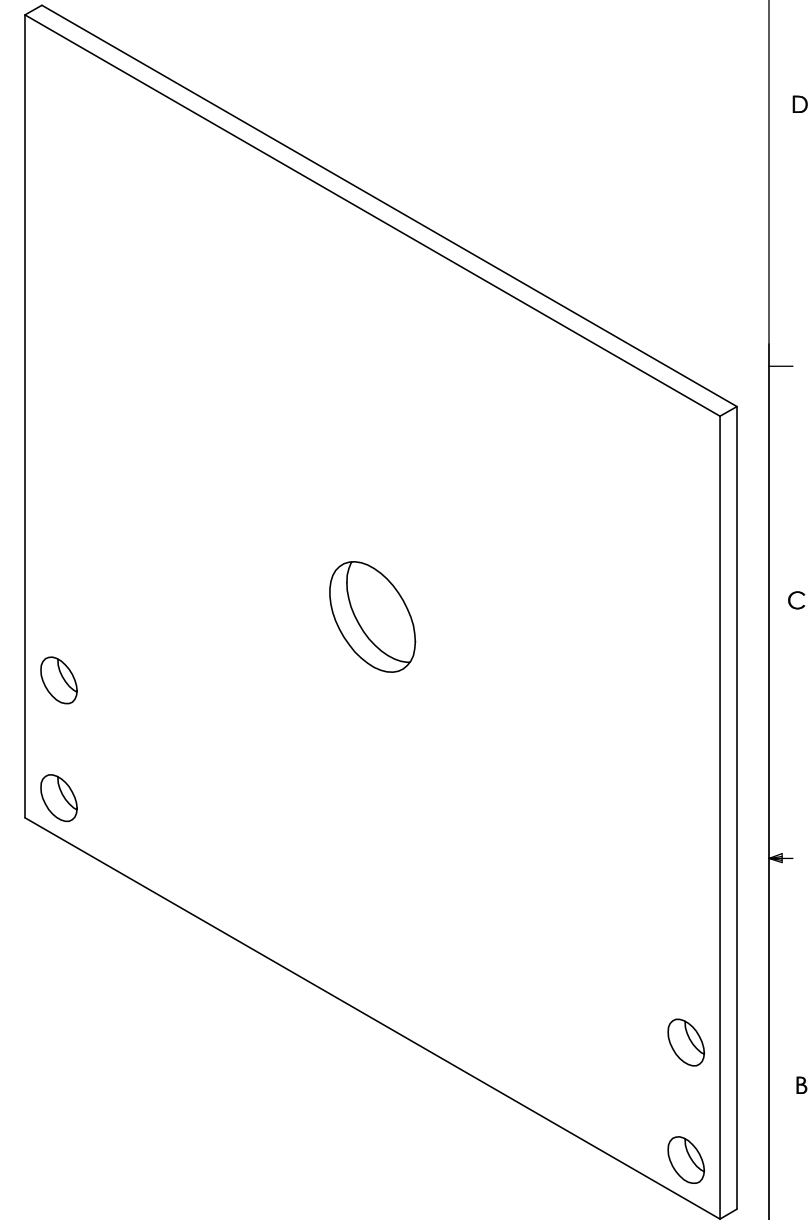
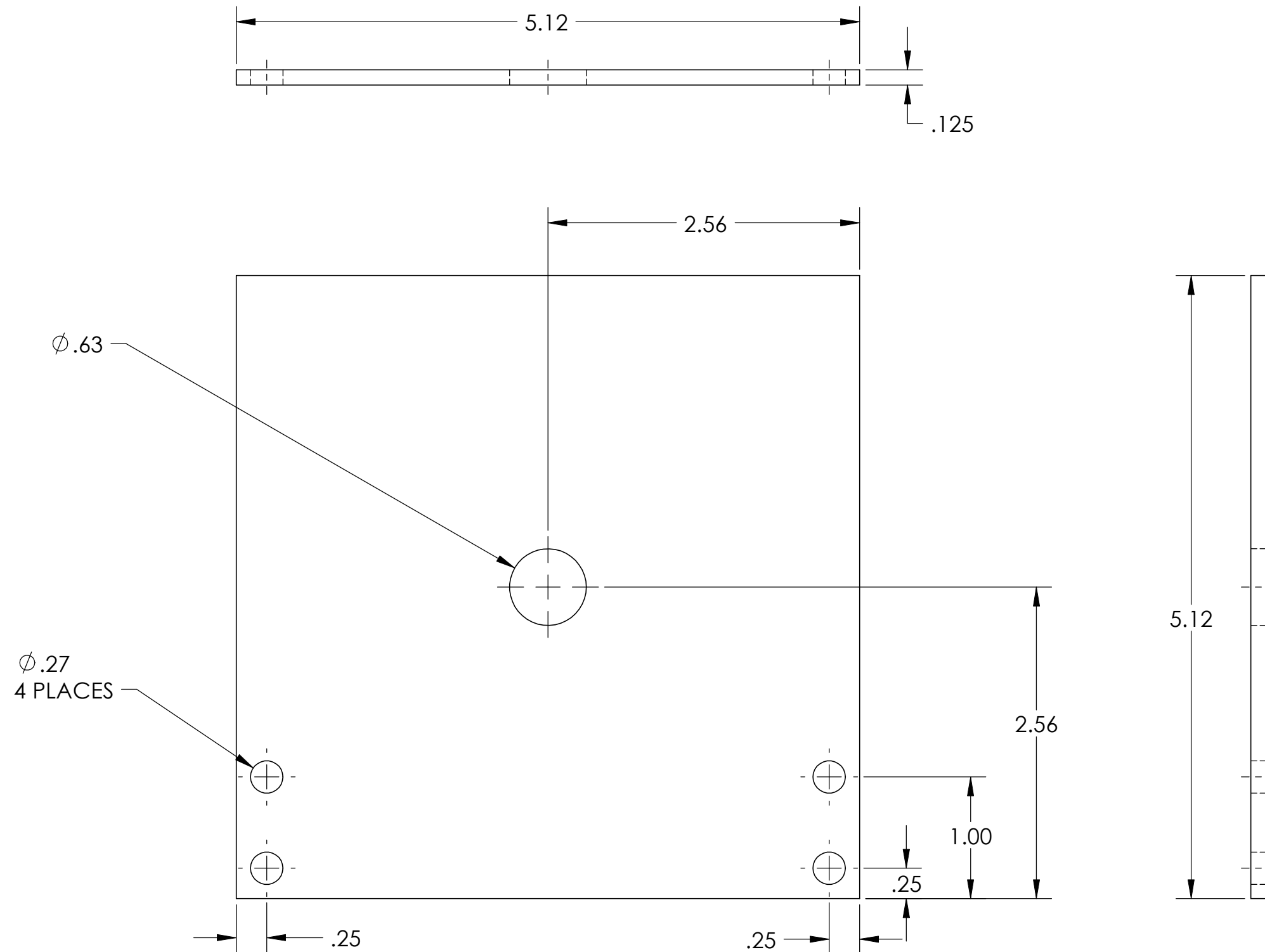

D  
C  
B  
A

D0902392 ALIGO IO STRAIGHT HA5 BAFFLE, PART PDM REV: X-004, DRAWING PDM REV: X-000

NOTES AND TOLERANCES: (UNLESS OTHERWISE SPECIFIED)	
DIMENSIONS ARE IN INCHES	1. INTERPRET DRAWING PER ASME Y14.5-1994.
TOLERANCES: .XX ± .01 .XXX ± .010	2. REMOVE ALL SHARP EDGES, R.02 MIN.
ANGULAR ± 0.1°	3. DO NOT SCALE FROM DRAWING.
	4. ALL MACHINING FLUIDS MUST BE FULLY SYNTHETIC, FULLY WATER SOLUBLE AND FREE OF SULFUR, SILICONE, AND CHLORINE.
MATERIAL DIRECT SINTERED SiC	FINISH N/A μinch

	UNIVERSITY OF FLORIDA	PART NAME STRAIGHT HA5 BAFFLE
	CALIFORNIA INSTITUTE OF TECHNOLOGY	
MASSACHUSETTS INSTITUTE OF TECHNOLOGY	DESIGNER L.WILLIAMS 19 NOV 2010 DRAFTER L.WILLIAMS 19 NOV 2010 CHECKER APPROVAL	SIZE DWG. NO. B D0902392 SCALE: 1:1 PROJECTION:
SYSTEM ADVANCED LIGO NEXT ASSY	SUB-SYSTEM IOO	REV. v2 SHEET 1 OF 1

8 7 6 5 4 3 2 1