

8

7

6

5

4

3

2

1

INTRALINK NAME: D060297

REV.	DATE	DCN #	DRAWING TREE #

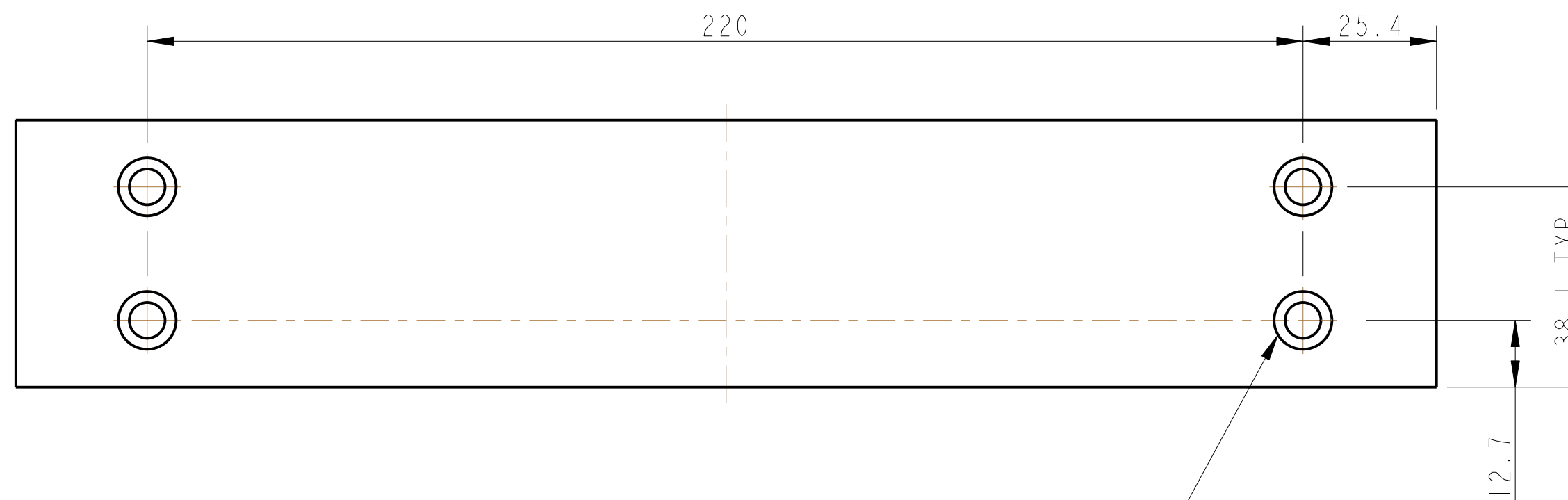
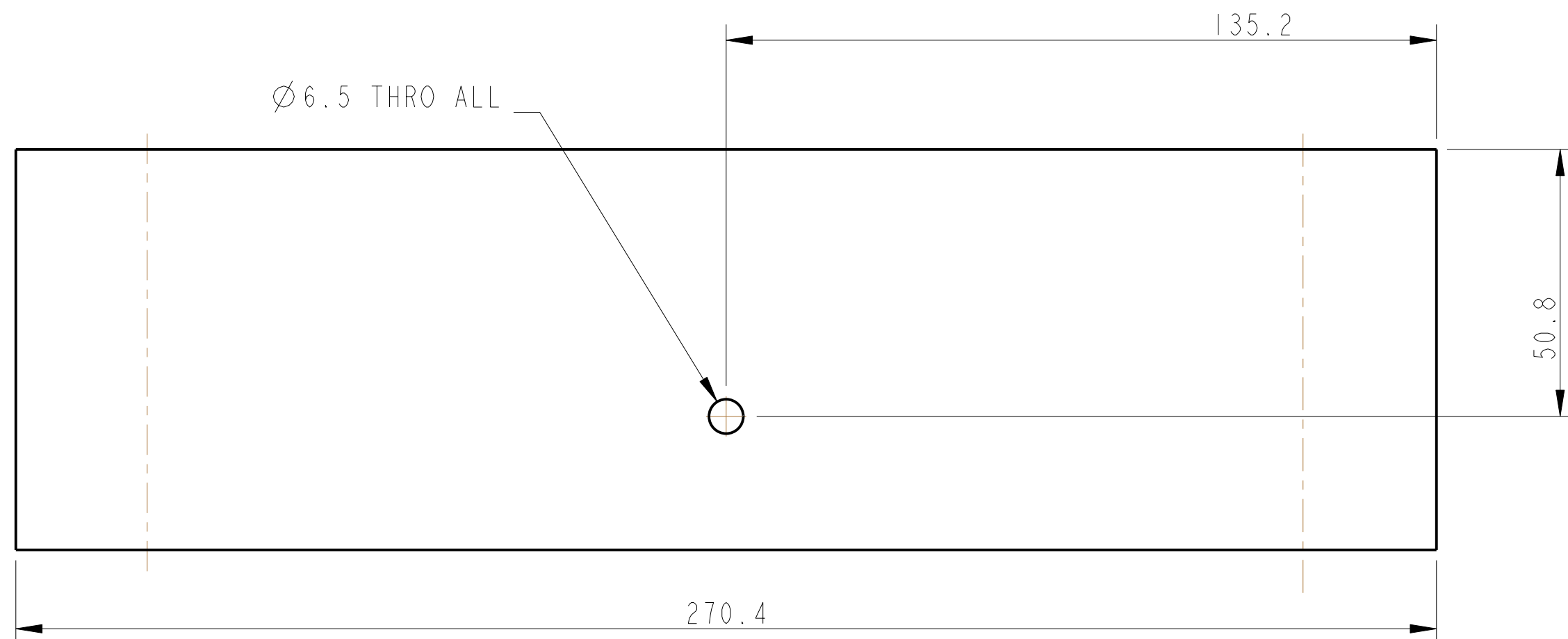

DRILL Ø11 THRO FIRST WALL
 DRILL Ø6.8 THRO SECONUD WALL

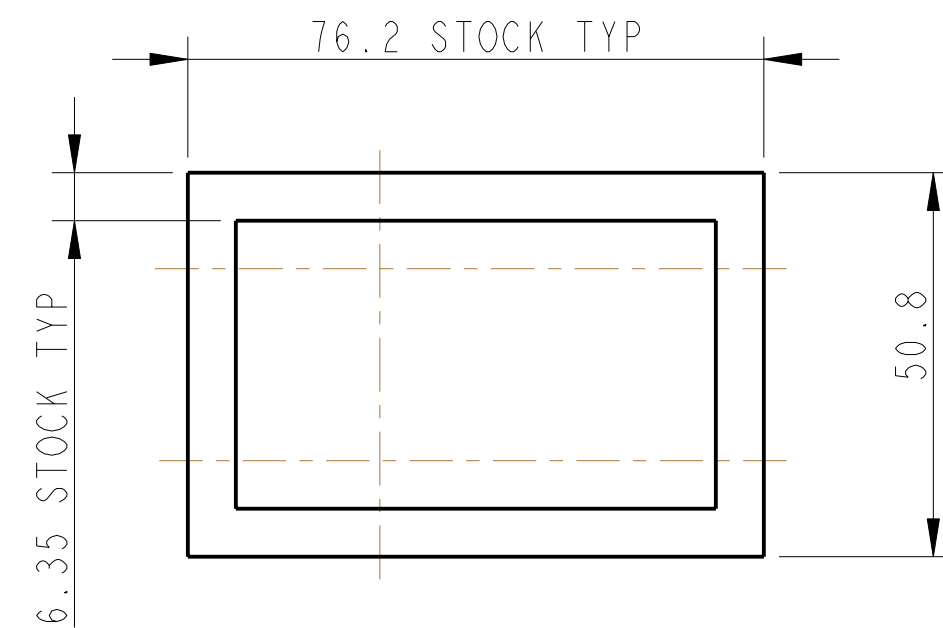

NOTES: (UNLESS OTHERWISE SPECIFIED)

- REMOVE ALL SHARP EDGES, R.02 MIN.
- DO NOT SCALE FROM DRAWING.
- ALL MACHINING FLUIDS SHALL BE WATER SOLUBLE AND FREE OF SULFUR, CHLORINE AND SILICONE, SUCH AS CINCINNATI MILACRON'S CIMTECH 410 (STAINLESS STEEL)
- SCRIBE, ENGRAVE OR STAMP DRAWING PART NUMBER ON NOTED SURFACE OF PART AND A THREE DIGIT SERIAL NUMBER. SERIAL NUMBERS START AT 001 FOR THE FIRST PART AND PROCEED CONSECUTIVELY. USE .07" HIGH CHARACTERS. EXAMPLE: D020188-001. A VIBRATORY TOOL MAY BE USED.

DIMENSIONS ARE IN mm (INCHES)
 TOLERANCES:
 X.XX ± 0.2 mm (INCHES)
 ANGULAR ± 0.25°

MATERIAL: AL ALLOY 5083

FINISH: CLEAN AND DEGREASE
 Ra ± 1.6 OR STOCK

NAME	DATE
DRAWN I WILMUT	22/SEP/06
CHECKED J'OD	21/FEB/07
APPROVED IW	22/FEB/07

SCALE 1:1 PROJECTION

CALIFORNIA INSTITUTE OF TECHNOLOGY
 MASSACHUSETTS INSTITUTE OF TECHNOLOGY
 RUTHERFORD APPLETON LABORATORIES

SYSTEM **ADVANCED LIGO**

SUB-SYSTEM **SUS**

NEXT ASSY **THIS**

PART NAME **LIFTING SECTION (LONG)**
(LOWER STRUCTURE TOOLING)

DRG. NO. **D060297**

SHEET 1 OF 1