

8 7 6 5 4 3 2 1

INTRALINK NAME: D060297

REV.	DATE	DCN #	DRAWING TREE #

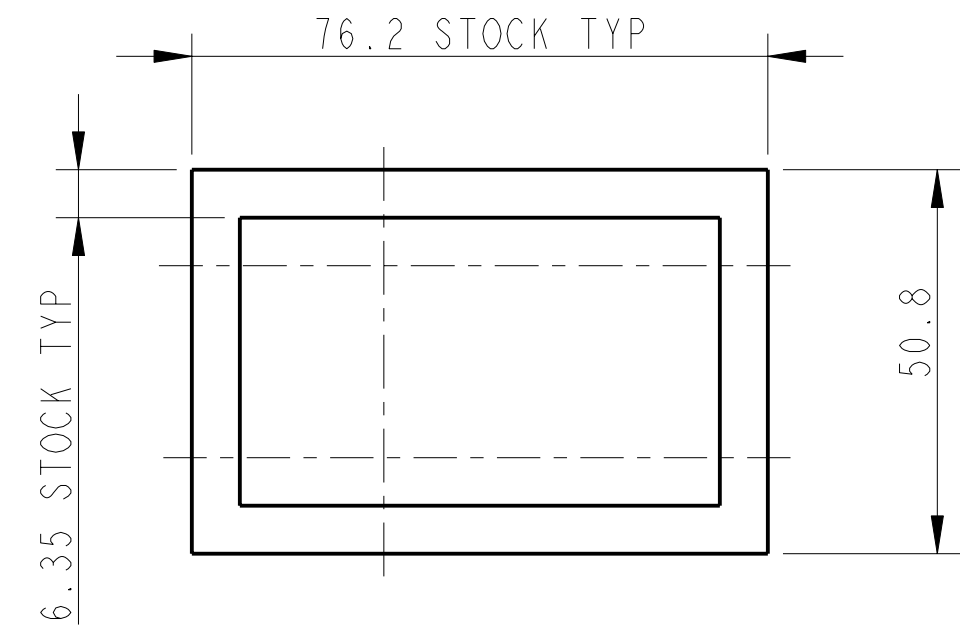
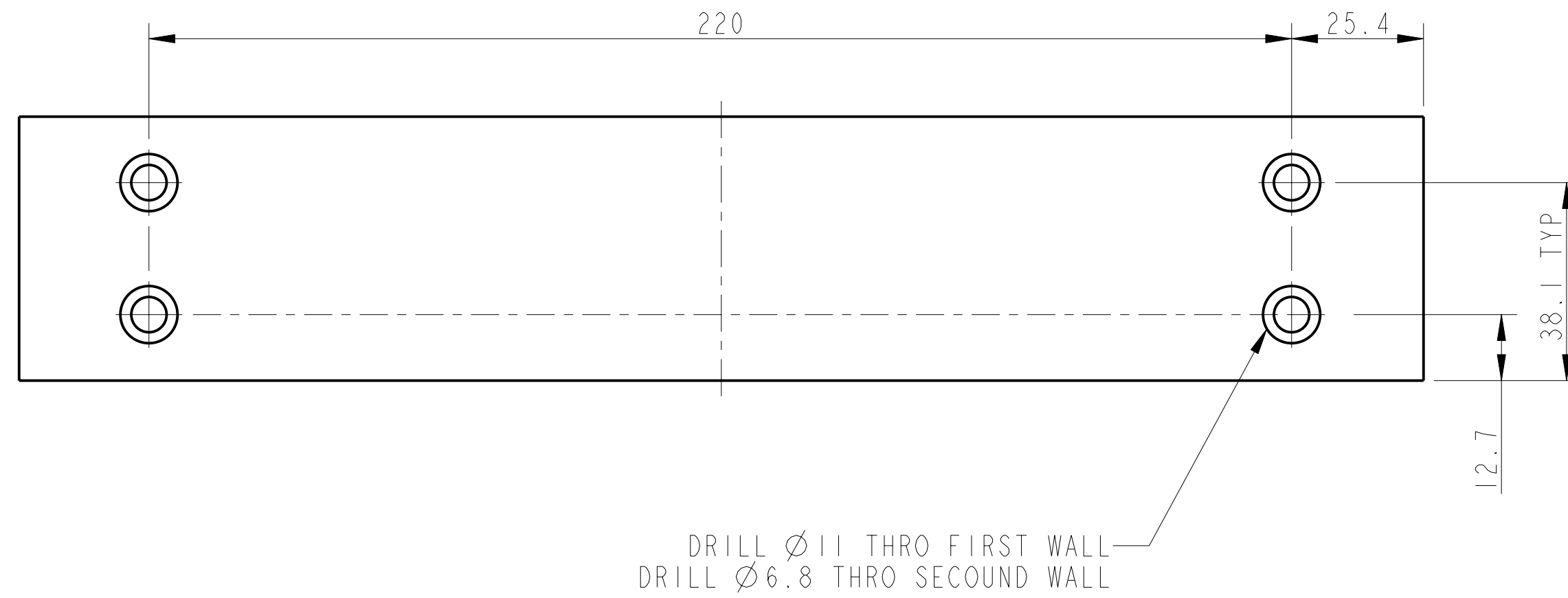
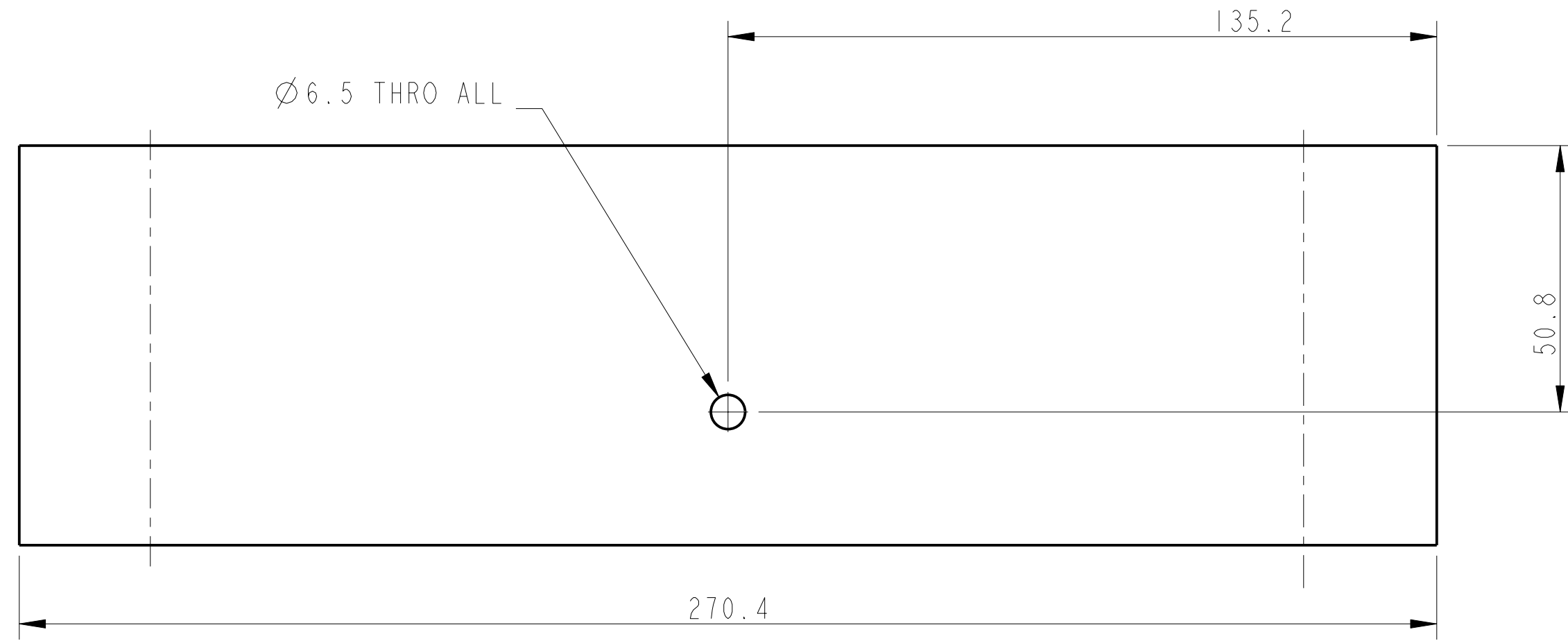

NOTES: (UNLESS OTHERWISE SPECIFIED)

- REMOVE ALL SHARP EDGES, R.02 MIN.
- DO NOT SCALE FROM DRAWING.
- ALL MACHINING FLUIDS SHALL BE WATER SOLUBLE AND FREE OF SULFUR, CHLORINE AND SILICONE, SUCH AS CINCINNATI MILACRON'S CIMTECH 410 (STAINLESS STEEL).
- SCRIBE, ENGRAVE OR STAMP DRAWING PART NUMBER ON NOTED SURFACE OF PART AND A THREE DIGIT SERIAL NUMBER. SERIAL NUMBERS START AT 001 FOR THE FIRST PART AND PROCEED CONSECUTIVELY. USE .07" HIGH CHARACTERS. EXAMPLE: D020188-001. A VIBRATORY TOOL MAY BE USED.

DIMENSIONS ARE IN mm (INCHES)  
TOLERANCES:  
X.XX ± 0.2 mm (INCHES)  
ANGULAR ± 0.25°

MATERIAL: AL ALLOY 5083

FINISH: CLEAN AND DEGREASE  
Ra (µm) = 1.6 OR STOCK

DRAWN	I WILMUT	22/SEP/06
CHECKED	J'OD	21/FEB/07
APPROVED	IW	22/FEB/07

CALIFORNIA INSTITUTE OF TECHNOLOGY  
MASSACHUSETTS INSTITUTE OF TECHNOLOGY  
RUTHERFORD APPLETON LABORATORIES

SYSTEM: aLIGO  
SUB-SYSTEM: SUS  
NEXT ASSY: QUAD TOOLING  
PART NAME: LIFTING SECTION (LONG)  
(LOWER STRUCTURE TOOLING)  
DRG. NO.: D060297  
SCALE: 1:1 PROJECTION: FIRST ANGLE SHEET 1 OF 1