

LLO HAM6-ISI Mass Layout (As-Leveled)

Mass Legend					
Drawing	Type	Mass (lb)	Mass (kg)	Qty	Location
D980375-1	Green	10	4.5	2	Top
D980375-2	Blue	20	9.1	6	Top
	Orange	40	18.2	17	Top
D071201	Spacer	0.10	0.05	38	Side
D071200	Type 00	0.57	0.26	3	Side
	Type 01	1.15	0.52	1	
	Type 02	2.25	1.02	-	
	Type 03	4.50	2.04	9	Side
	Type 04	8.25	3.74	12	Side
	Type 05	15.98	7.25	3 / 3	Side / Keel
	Type 06	27.56	12.50	6 / 3	Side / Keel
D080001	Trim Mass	2.58	1.17	1	Top
D080002	Trim Mass	0.59	0.27	1	Top

Mass Totals	
Top	823.2 lb / 373.4 kg
Sides	359.8 lb / 163.19 kg
Keel	130.62 lb / 59.25 kg
Total	1313.62 lb / 595.84 kg

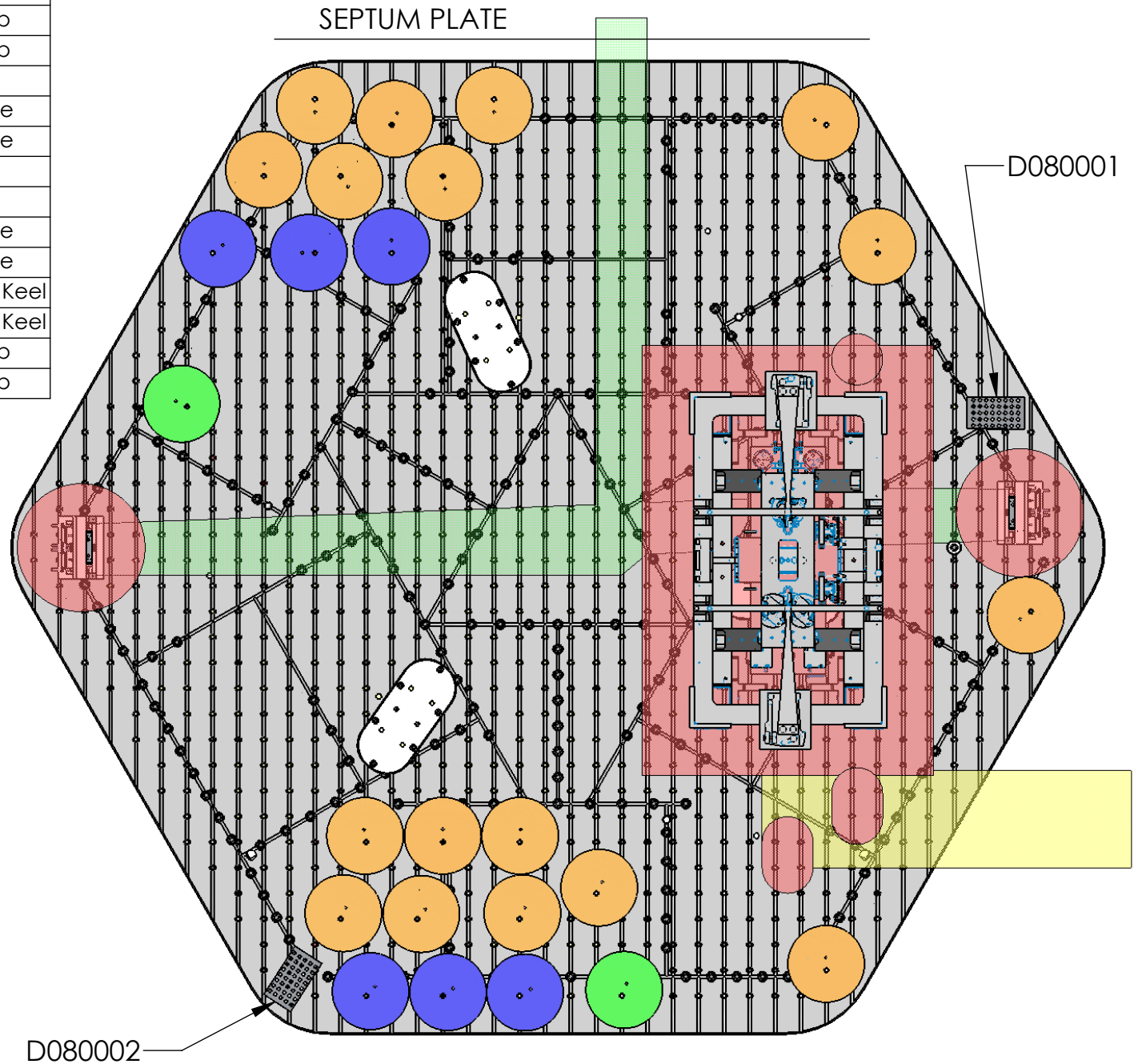

Notes:

1. Optics table removed for clarity.
2. All masses are stacked with the heaviest masses closest to the wall.
3. Spacers are used between each mass.
4. For the side walls, spacers are used between the wall and the first mass. Spacers also are used on the outside of the mass stack where noted in Table 1.
5. For the keel, no spacers are used between the wall and the first mass.

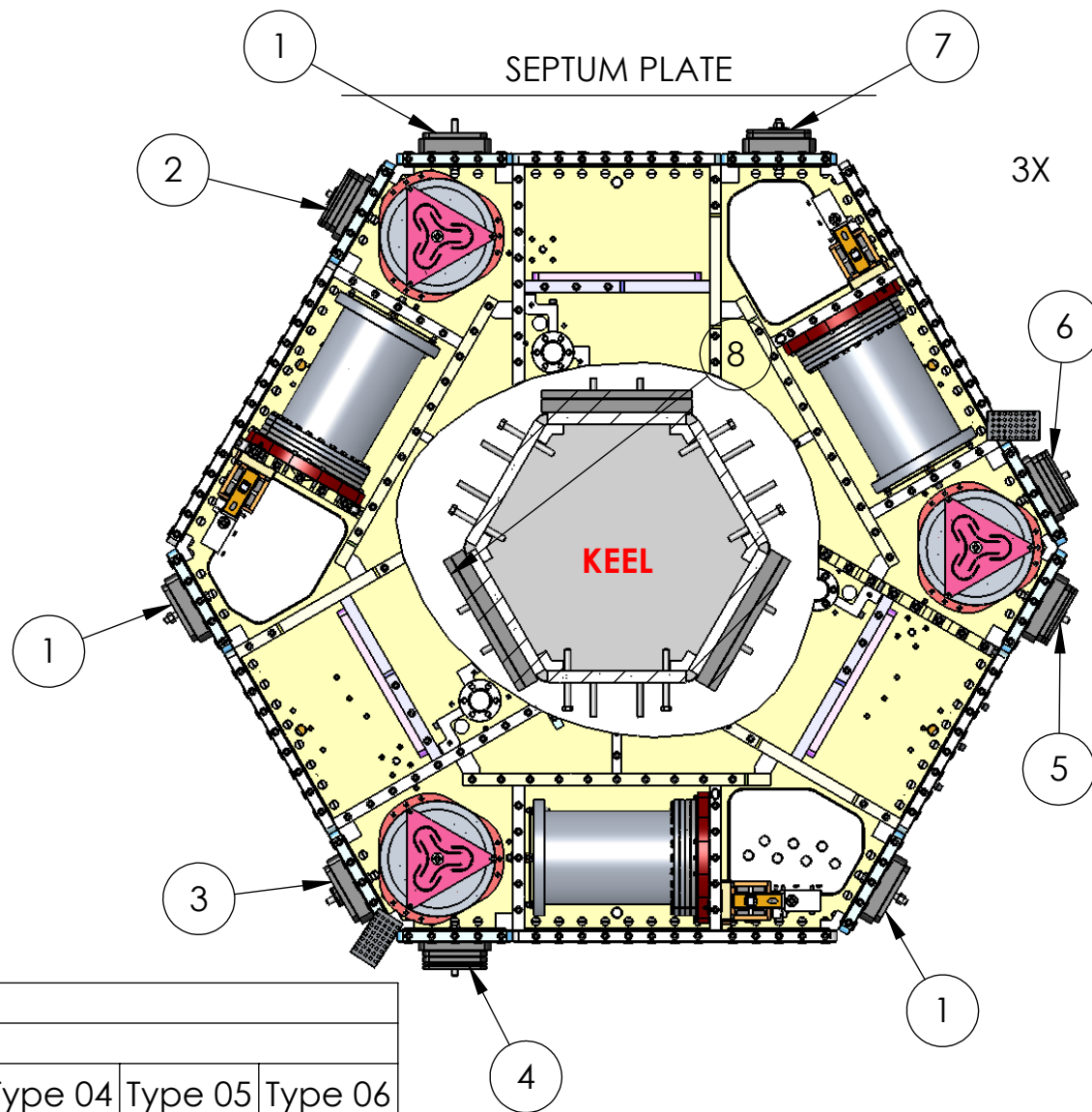

Table 1
Qty Required

Callout Number	Qty Required							
	Spacers	Outside Spacer	Type 00	Type 01	Type 03	Type 04	Type 05	Type 06
1	2	No	-	-	-	1	-	1
2	6	No	1	-	2	2	1	-
3	4	No	1	1	-	1	-	1
4	5	No	-	-	2	2	1	-
5	5	Yes	-	-	2	1	-	1
6	5	No	-	-	2	2	1	-
7	4	No	1	-	1	1	-	1
8	1	No	-	-	-	-	1	1

Stage 1 - CG, LZMP, Actuators, GS-13 Locations

[8.563]
217.49 mm
Horizontal
Actuators

[9.875]
250.83 mm
Horizontal
GS-13

[8.527]
216.59 mm
Stage1 CG

[8.547]
217.09 mm
Flexure LZMP
(From HPD)

[.016]
0.40 mm
Flexure will
stretch this
amount
(From HPD)

