

8 7 6 5 4 3 2 1

NOTES CONTINUED:
 Ⓢ SCRIBE, ENGRAVE, OR MECHANICALLY STAMP (NO INKS OR DYES) DRAWING PART NUMBER AND REVISION ON NOTED SURFACE FOLLOWED ON THE NEXT LINE BY A THREE DIGIT SERIAL NUMBER. SERIAL NUMBERS START AT 001 FOR THE FIRST ARTICLE AND PROCEED CONSECUTIVELY. USE .07" HIGH CHARACTERS. EXAMPLE: DXXXXXX-VY, S/N 001. A VIBRATORY TOOL MAY BE USED.

REV.	DATE	DCN #	DRAWING TREE #
v1	21/10/2010	-	-
v2	23/11/2010	-	-
-	-	-	-

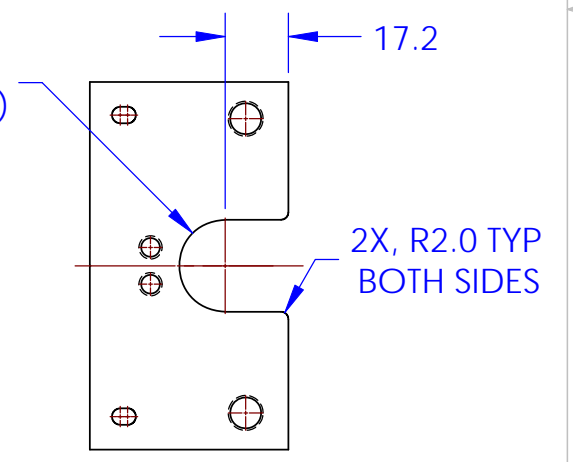
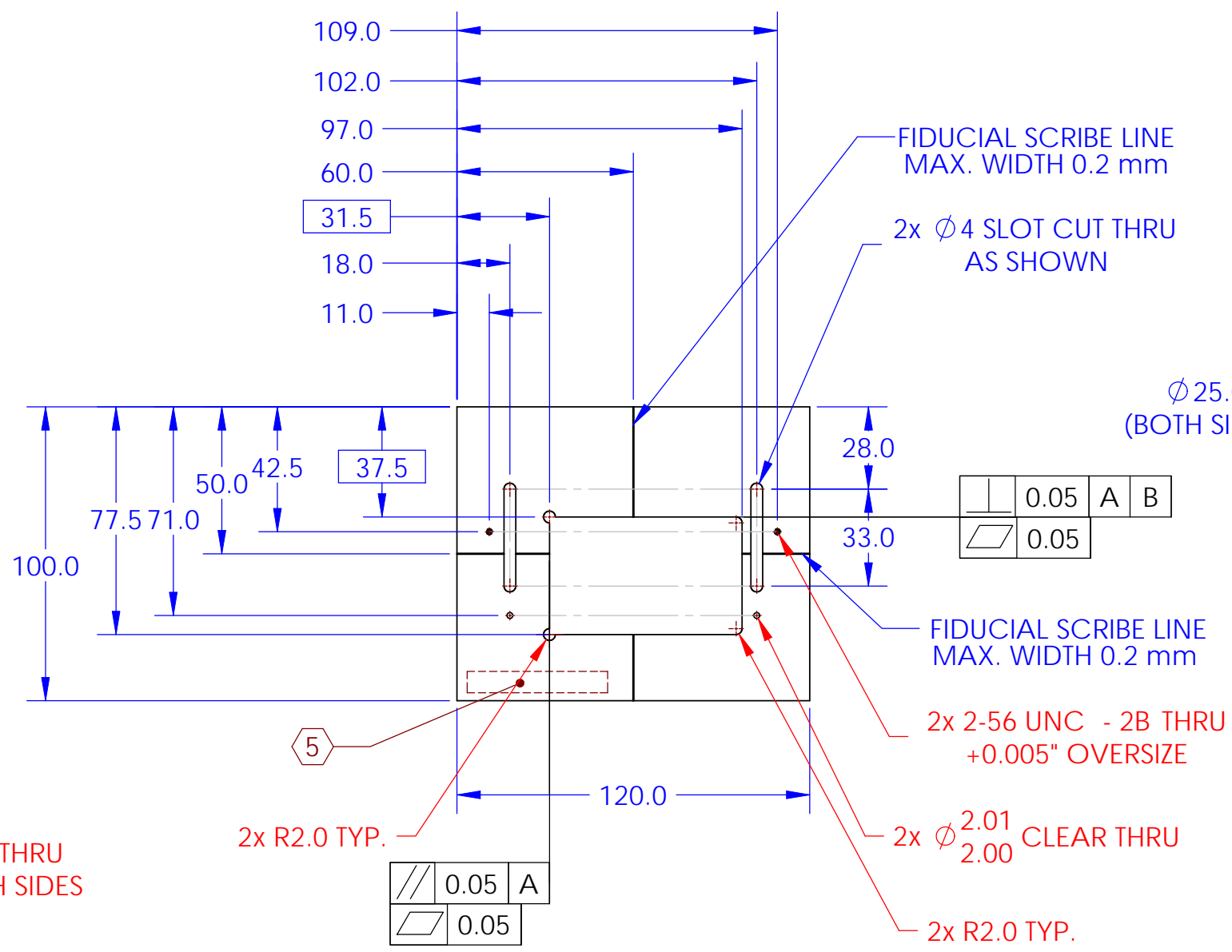
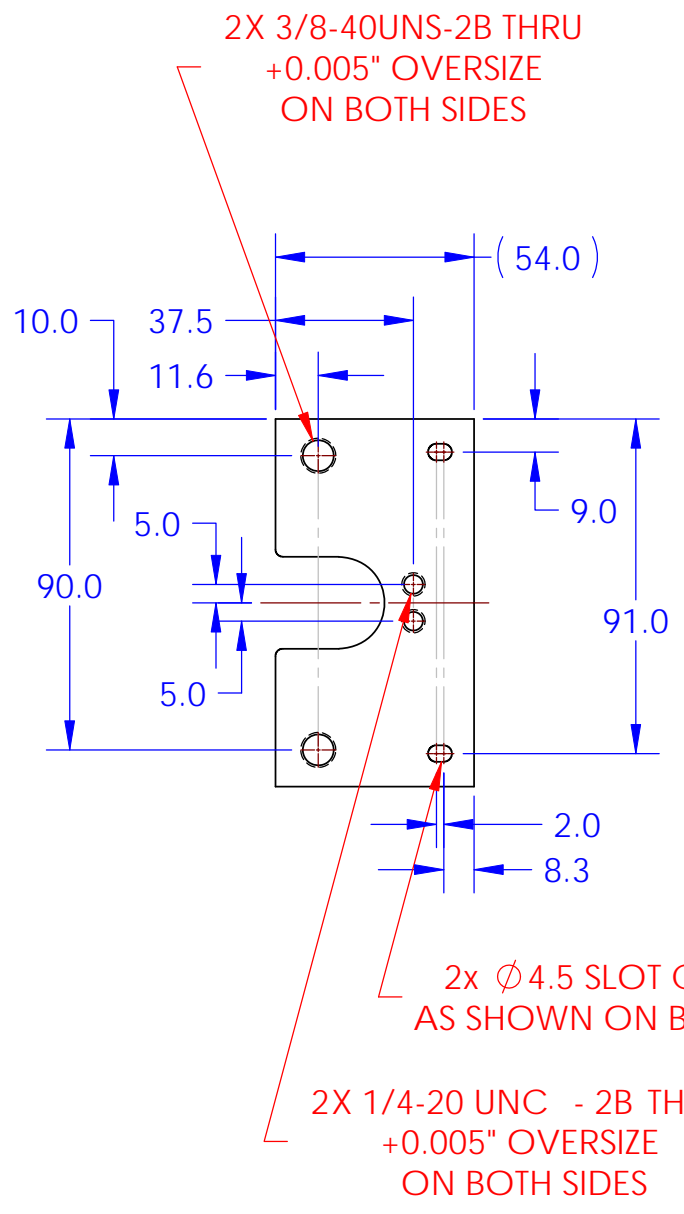
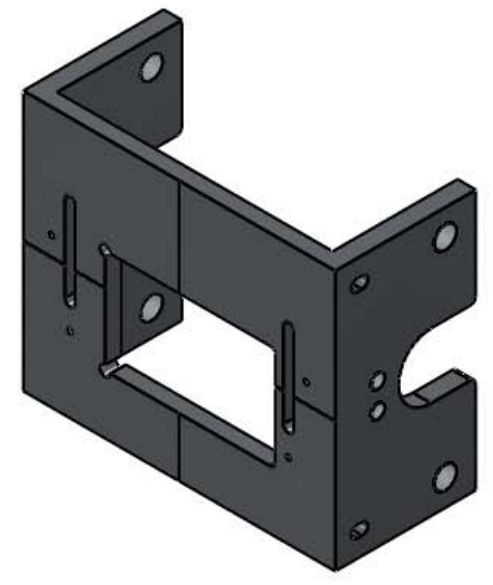
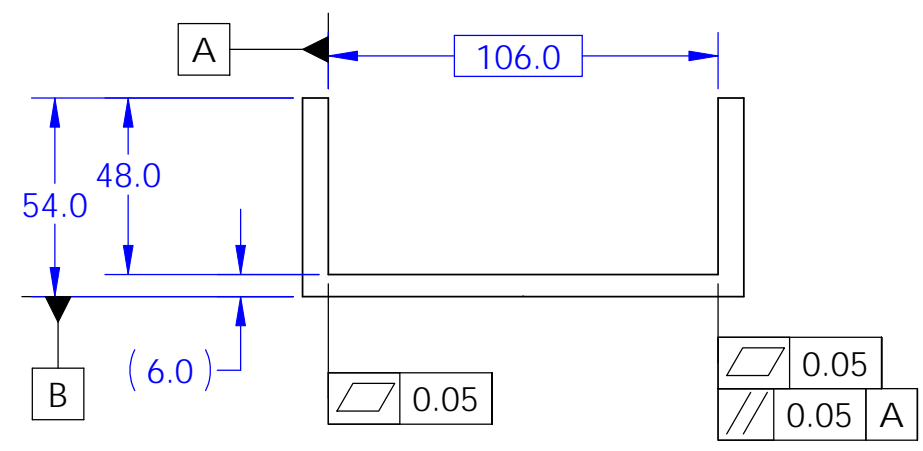

NOTES AND TOLERANCES: (UNLESS OTHERWISE SPECIFIED)				CALIFORNIA INSTITUTE OF TECHNOLOGY MASSACHUSETTS INSTITUTE OF TECHNOLOGY		PART NAME	
DIMENSIONS ARE IN mm TOLERANCES: .X ± 0.1 .XX ± 0.01 ANGULAR ± 0.2°				1. INTERPRET DRAWING PER ASME Y14.5-1994. 2. REMOVE ALL SHARP EDGES, R.5 MIN. 3. DO NOT SCALE FROM DRAWING. 4. ALL MACHINING FLUIDS MUST BE FULLY SYNTHETIC, FULLY WATER SOLUBLE AND FREE OF SULFUR, SILICONE, AND CHLORINE.		aLIGO TCP PRISM BONDING BASEPLATE	
MATERIAL 6061 Alloy				SYSTEM aLIGO		SUB-SYSTEM SUS	
FINISH 1.6 µm				NEXT ASSY D1002141		DESIGNER M. van Veggel 13/08/2010	
				DRAFTER M.v. Veggel 11/10/2010		SIZE DWG. NO. B D1002142	
				CHECKER R. Jones 14/10/2010		REV. v2	
				APPROVAL		SCALE: 1:2 PROJECTION: SHEET 1 OF 1	

8 7 6 5 4 3 2 1

D1002142_aligo_tcp_prism_bonding_baseplate, PART PDM REV: v2, DRAWING PDM REV: