

NOTES: (UNLESS OTHERWISE SPECIFIED)

1. DIMENSIONS IN INCHES
2. REMOVE ALL SHARP EDGES, R.02 MIN
3. ALL MACHINING FLUIDS SHALL BE WATER SOLUBLE AND FREE OF SULFUR, CHLORINE AND SILICONE, SUCH AS CINCINNATI MILACRON'S CIMTECH 410 (STAINLESS STEEL)

REV.	DATE	DCN #	DRAWING TREE #
A	24 JUNE 2004	E040303-00	



D020204\_SHIM.step

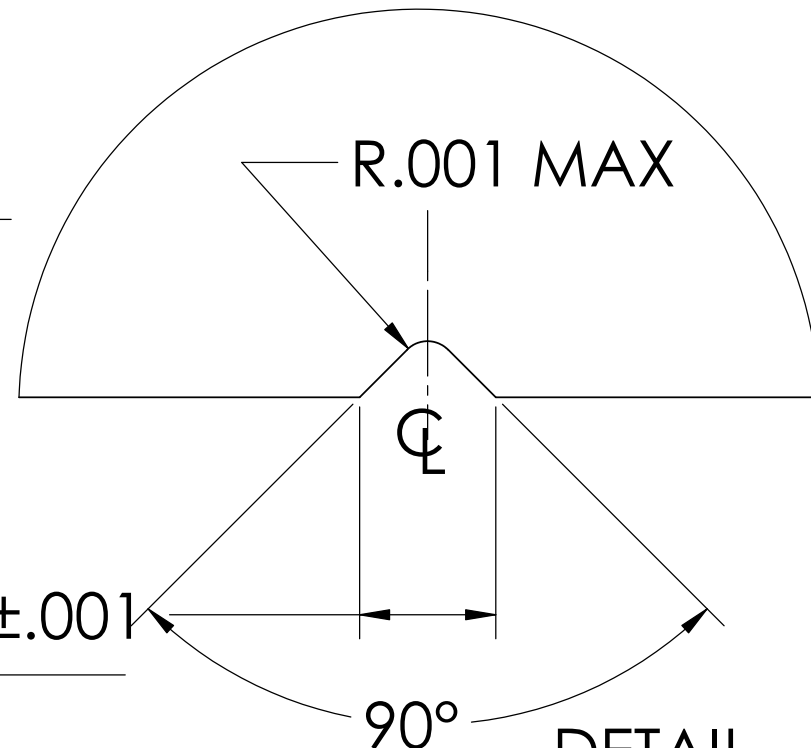
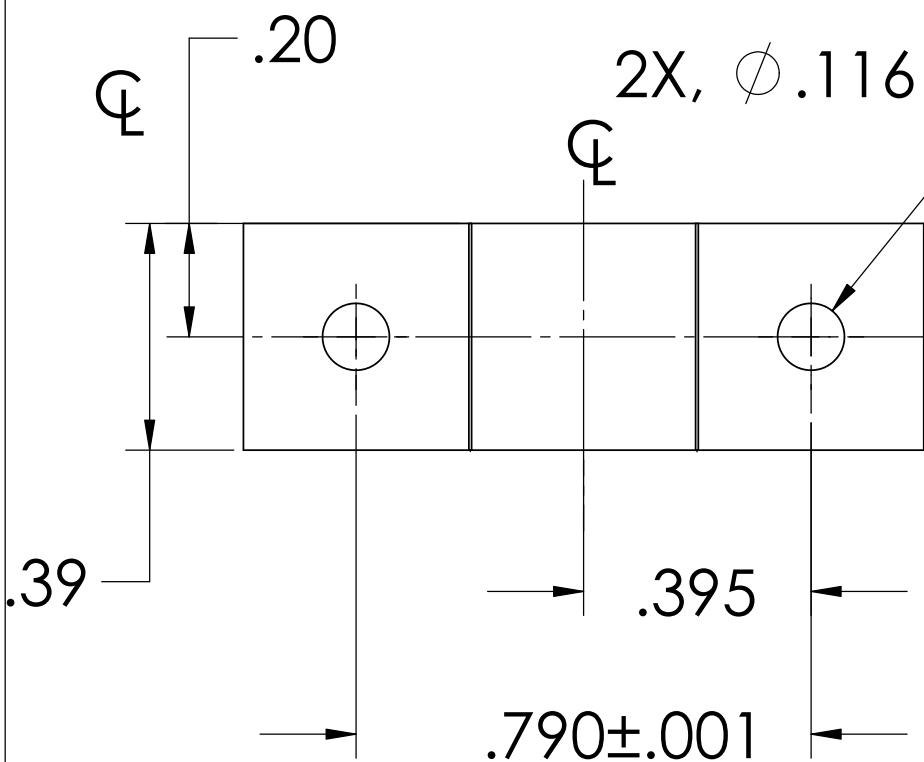
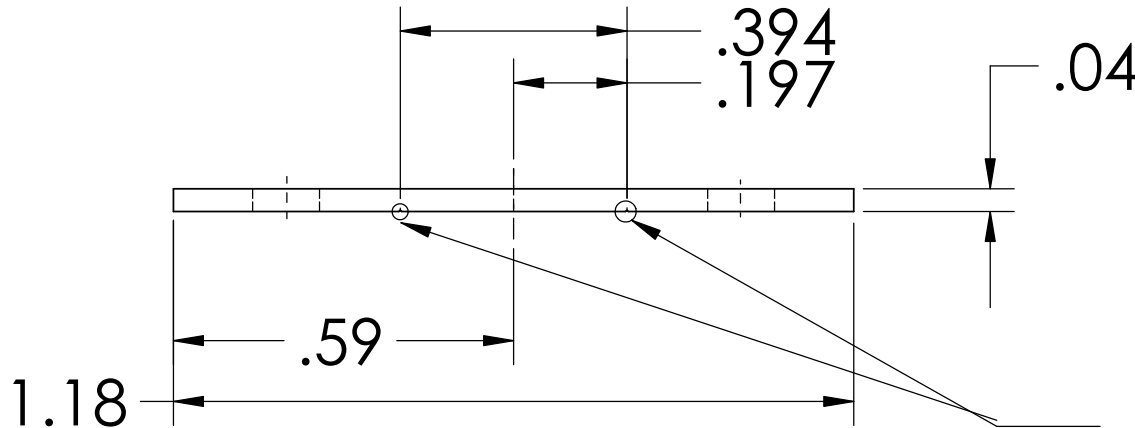

DETAIL  
SCALE 150 : 1

DIMENSIONS ARE IN INCHES		NAME	DATE	CALIFORNIA INSTITUTE OF TECHNOLOGY MASSACHUSETTS INSTITUTE OF TECHNOLOGY
TOLERANCES: .XX ±0.01 .XXX ±0.005 ANGULAR ±1°		CIT	04/02	
MATERIAL		CHECKED		SYSTEM ADVANCED LIGO
300 SERIES STAINLESS				SUB-SYSTEM SUS
FINISH				NEXT ASSY MC: INT+LOWER MASS
		COMMENTS:		PART NAME LOWER WIRE CLAMP SHIM
		SIZE	DWG. NO.	REV.
		A	D020204	A
		SCALE: NTS		SHEET 1 OF 1