

REV.	DATE	DCN #	DRAWING TREE #
A	24 JUNE 2004	E040303-00	

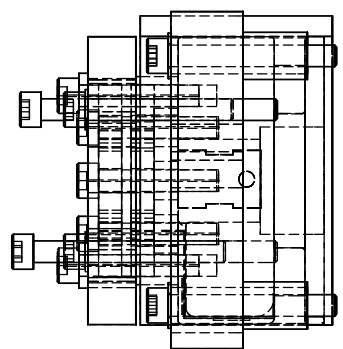
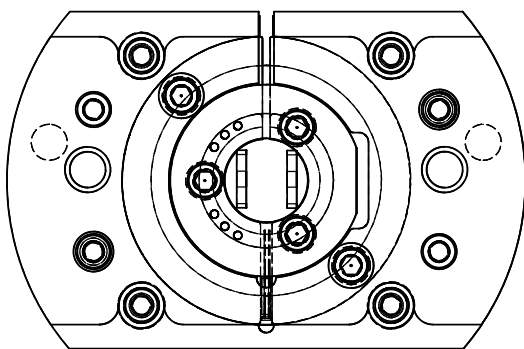
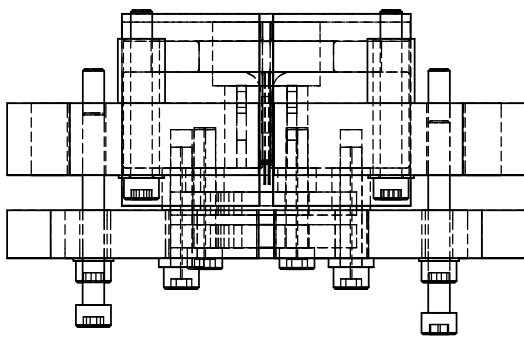
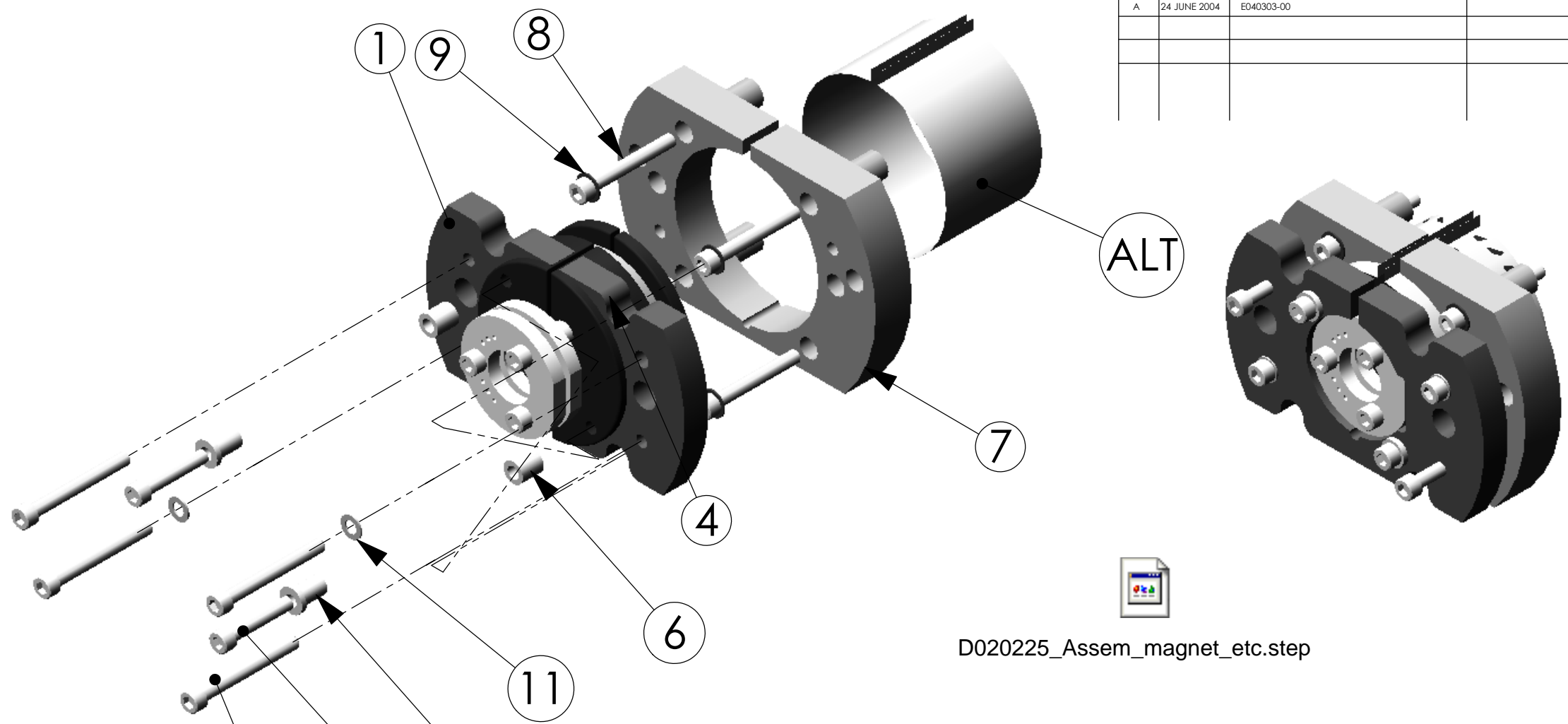

ITEM NO	REQ.	SPARE	TOT.	PART NUMBER	DESCRIPTION	MATERIAL
ALT	1	1	2	D030710	COIL FORMER CLAMP ONE PIECE ALT	6061-T6-AI
11	2	2	4		FLAT WASHERS NAS 620-C4L (OR EQUIV.)	300 SSSL
10	2	2	4		SST VENTED SOCKET HEAD CAP SCREW #4-40 UNC-3A X 0.625 LONG	Ag 300 SST
9	4	4	8		FLAT WASHERS NAS 620-5L (OR EQUIV.)	300 SSSL
8	4	4	8		Ag-SST SOCKET HEAD CAP SCREW #4-40 UNC-3A X 0.875 LONG	Ag-300 SST
7	1	1	2	D030183	COIL FORMER CLAMP ONE PIECE	6061-T6-AI
6	2	2	4	D030123	SPACER FOR COIL FORMER BRACKET	TEFLON
ALT	1	1	2	D030124	KAPTON FILM 0.002" THICK (FOR COIL FORMER) 1.0" WIDE BY 4.7" LONG	KAPTON
4	1	1	2	D030105	ASSEMBLY COIL HEAD	
3	2	2	4	D030122	SHOULDER FOR COIL FORMER BRACKET	MACOR
2	4	4	8		SST SOCKET HEAD CAP SCREW #4-40 UNC-3A X 1 LONG	300 SSSL
1	1	1	2	D020282	COIL FORMER BRACKET	6061-T6 AI

NOTES: (UNLESS OTHERWISE SPECIFIED)

- DIMENSIONS IN INCHES.
- REMOVE ALL SHARP EDGES, R.02 MIN.
- ALL MACHINING FLUIDS SHALL BE WATER SOLUBLE AND FREE OF SULFUR, CHLORINE AND SILICONE, SUCH AS CINCINNATI MILACRON'S CIMTECH 410 (STAINLESS STEEL).
- ASSEMBLE ACCORDING TO HYBRID OSEM ASSEMBLY SPECIFICATION, LIGO E030084-00-D.
- ADDITIONAL ISOLATION OF THE COIL HEAD ASSEMBLY, D030105, SUPPLIED BY A COMBINATION OF D030122, D030123, D030124 SHOULD BE USED AS REQUIRED.

PARTS LIST

NAME	DATE
DRAWN CIT	02/12/02
CHECKED	

DIMENSIONS ARE IN INCHES
TOLERANCES:
.XX ± 0.01
.XXX ± 0.005
ANGULAR ± 0.5 °

LIGO CALIFORNIA INSTITUTE OF TECHNOLOGY
MASSACHUSETTS INSTITUTE OF TECHNOLOGY
IGR, GLASGOW UNIVERSITY GEO 600 GROUP

SYSTEM ADVANCED LIGO

SUB-SYSTEM SUS

NEXT ASSY MC: COIL

PART NAME COIL ASSEMBLY

SIZE DWG. NO. REV.
B D020225 **A**

SCALE: NTS PROJECTION: SHEET 1 OF 1