

D1002368\_ALIGO\_IO\_HAM\_AUX\_SUS\_EDDY\_CURRENT\_MAGNET, PART PDM REV: X-005, DRAWING PDM REV: X-001

NOTES CONTINUED:  
⑤ SCRIBE, ENGRAVE, LASER MARK OR MECHANICALLY STAMP (NO DYES OR INKS) A UNIQUE THREE DIGIT SERIAL NUMBER & REVISION NUMBER ON EACH PART. SERIAL NUMBERS START AT 001 FOR THE FIRST ARTICLE AND PROCEED CONSECUTIVELY. BAG AND TAG PARTS WITH THEIR DRAWING PART NUMBER, REVISION, VARIANT OR "TYPE" (IF APPLICABLE), AND QUANTITY. IF PARTS ARE TOO SMALL TO SCRIBE, BAGGING AND TAGGING ALONE IS SUFFICIENT.  
EXAMPLE (PART): 001-v1  
EXAMPLE (TAG): DXXXXXX-VY, TYPE-XX, QTY: TBD

6. MAGNETS SHALL BE COATED WITH EITHER NICKEL OR A NICKEL-COPPER-NICKEL PLATING

REV.	DATE	DCN #	DRAWING TREE #
-	-	-	-
-	-	-	-
-	-	-	-

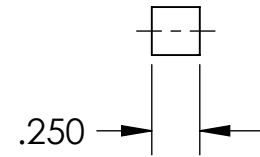
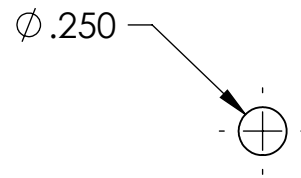

NOTES AND TOLERANCES: (UNLESS OTHERWISE SPECIFIED)				UNIVERSITY OF FLORIDA CALIFORNIA INSTITUTE OF TECHNOLOGY MASSACHUSETTS INSTITUTE OF TECHNOLOGY		PART NAME	
DIMENSIONS ARE IN INCHES		1. INTERPRET DRAWING PER ASME Y14.5-1994. 2. REMOVE ALL SHARP EDGES, R.02 MIN. 3. DO NOT SCALE FROM DRAWING. 4. ALL MACHINING FLUIDS SHALL BE WATER SOLUBLE AND FREE OF SULFUR, CHLORINE AND SILICONE, SUCH AS CINCINNATI MILACRON'S CIMTECH 410.		LIGO		EDDY CURRENT MAGNET	
TOLERANCES: .XX ± .01 .XXX ± .004		MATERIAL NEO 42		SYSTEM ADVANCED LIGO		DESIGNER L. WILLIAMS 16 SEPT 2010	
ANGULAR ± 0.1°		FINISH 63 μinch		SUB-SYSTEM 100		DRAFTER L. WILLIAMS 16 SEPT 2010	
		NEXT ASSY D1000120				SIZE DWG. NO. B D1002368	
						CHECKER	
						APPROVAL	
						SCALE: 1:1 PROJECTION:  SHEET 1 OF 1	