

NOTES: (UNLESS OTHERWISE SPECIFIED)

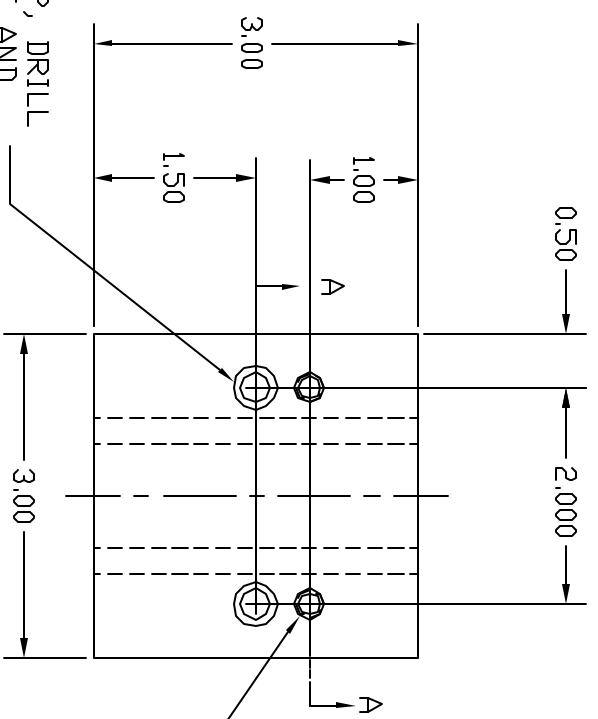

DRILL 0.281 THRU TOP CLAMP, TAP
1/4-20 UNC-2B THRU BOTTOM BASE
2 PLCS

DRILL 0.406 THRU TOP CLAMP, DRILL
0.281 DIA THRU BOTTOM BASE AND
C/BORE 0.406 TO DEPTH SHOWN 2
PLCS

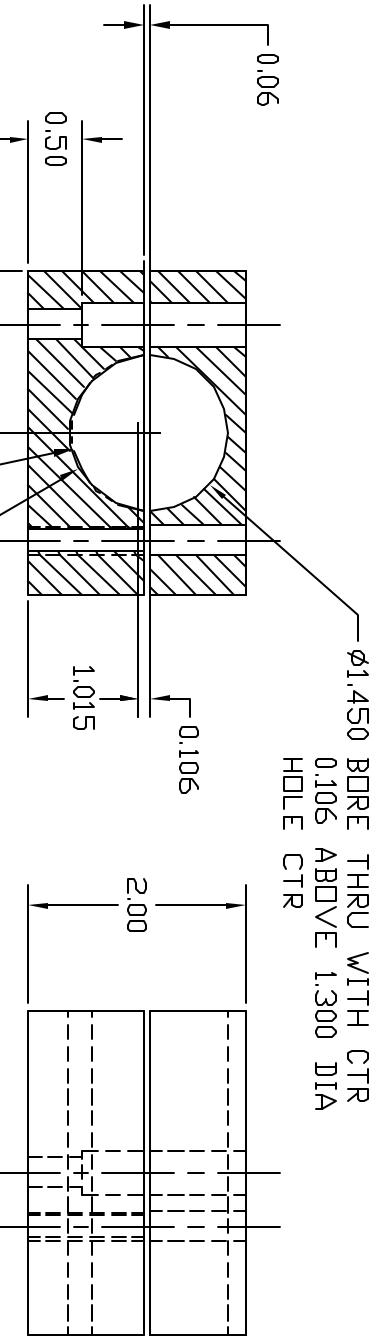

Ø1.450 BORE THRU WITH CTR
0.106 ABOVE 1.300 DIA
HOLE CTR

Ø1.300 BORE THRU WITH
CTR 1.015 ABOVE
BASE

SECTION A-A

REV.	DATE	DCN #	DRAWING TREE #
A	3/24/03	E030143-00-D	-
B	3/31/03	E030143-01-D	
C	4/14/03	E030143-02-D	

ITEM NO.	REQ.	SPARE	TOT. QUANTITY	PART NUMBER	DESCRIPTION	SUPPLIER
UNLESS OTHERWISE SPECIFIED						
DIMENSIONS ARE IN INCHES						
TOLERANCES:						
XX ± 0.01						
XXX ± 0.005						
ANGULAR						
X ± 1 DEG						
XX ± 0.2 DEG						
MATERIAL: 6061 T6 ALUM						
FINISH: BLACK ANODIZE						

DATE	NAME	DESCRIPTION
3/24/03	M.R. SMITH	DRAWN
		CHECKED

DATE	3/24/03	NAME	M.R. SMITH
CHECKED			
SCALE	1		
SIZE	DWG. NO. D030167-C-D		
REV	C		
SHEET	1 OF 1		