

166 flame cut OK

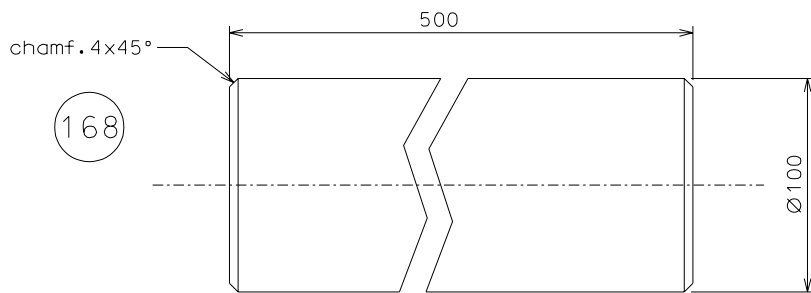

168

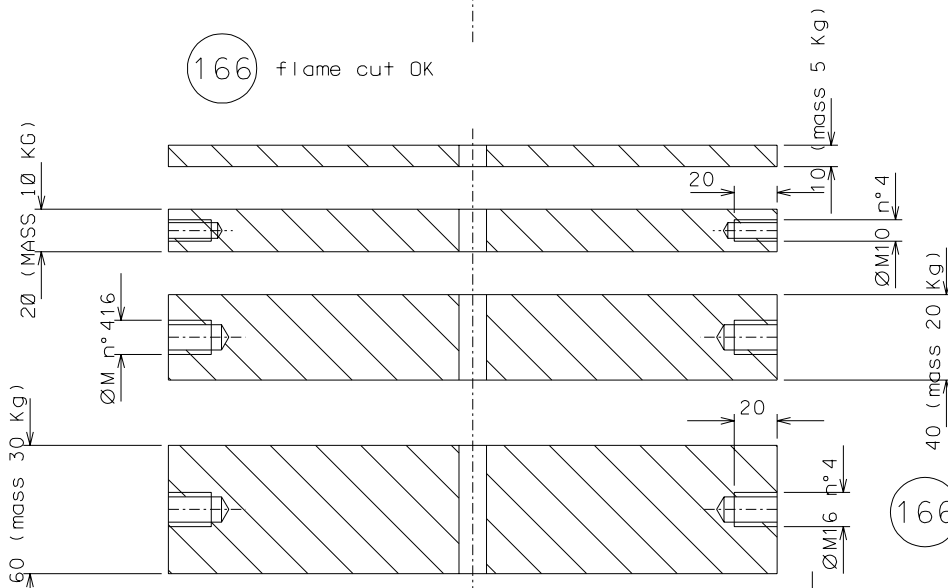
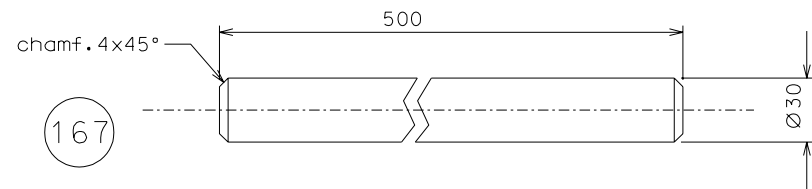

167

ref.	note	date	signature				
	modified part 166 as built	29-06-06					
	modified n° parts detail 166	08-04-06					
	modified ref. assembly	26-02-06					
modifications							
166.2	2 Fe 340	1/2.5	168 17 inox 1/2.5				
166.1	2 Fe 340	1/2.5	167 16 inox 1/2.5				
166	2 Fe 340	1/2.5	166.3 2 Fe 340 1/2.5				
ref.	pieces	mat. and treatments	scale	ref.	pieces	mat. and treatments	scale

166.3

166.2

166.1

166 flame cut OK

General machining tolerances UNI 5307-63

Dimensions	< 6	>6-30	>30-120	>120-315	>315-1000	>1000-2000	>2000-4000	>4000
linear Toll.	± 0.1	± 0.2	± 0.3	± 0.5	± 0.8	± 1.2	± 2	± 3
angular Toll.	± 1	± 30'	± 20'	± 10' referred to the shortest side				

	LIGO PROJECT	designed for	
		R.De Salvo	
HAM-OPTICAL BENCH BALLAST	draw. by G. Gennaro-PROMEC	date	scale
		26-10-05	1/2.5
title HAM-OPTICAL BENCH BALLAST		LIGO-D051175-03-D	
detail from		103-176	A 3