

TOP VIEW

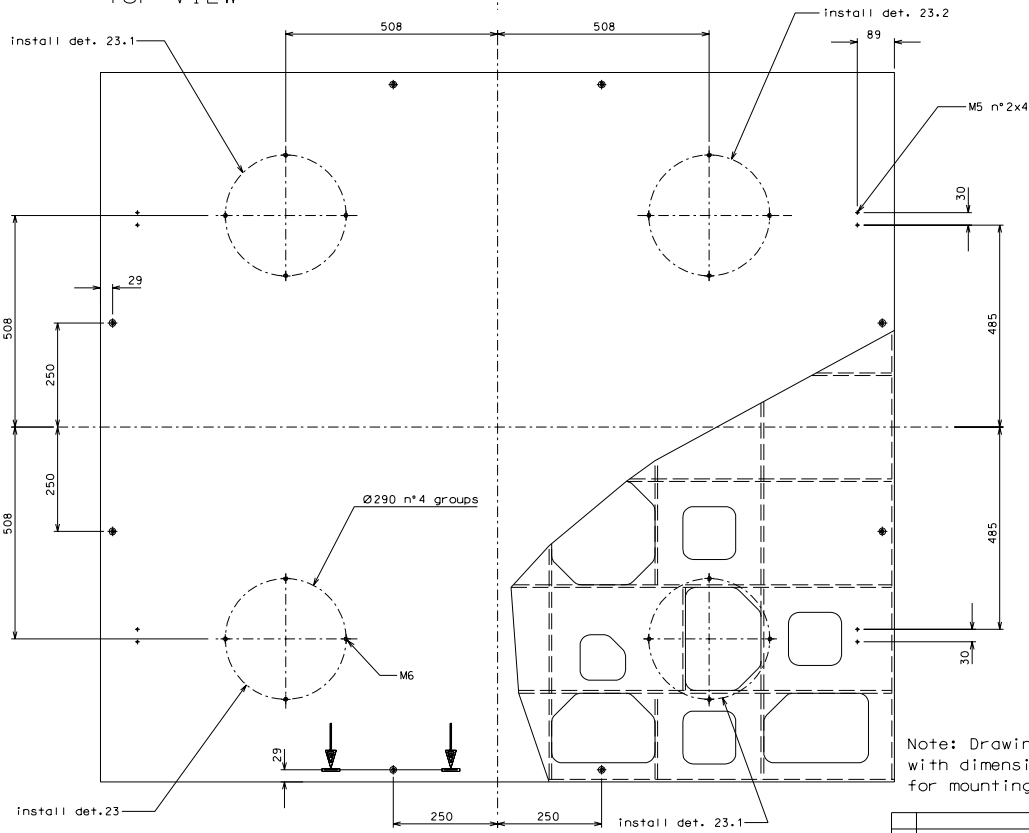

BOTTOM VIEW

Note: Drawing of old table with dimensions of new holes for mounting on filter's system

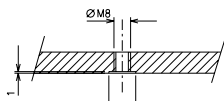

Ø16 n°4 on 4 sides
If it is necessary to fix up perpendicular rod

ref.	date	signature						
modifications								
ref.	date	signature						
ref.	date	signature						
General machining tolerances UNI 5307-63								
Dimension	< 6	6-30	30-120	120-315	315-1000	1000-2000	2000-4000	> 4000
Linear Tol.	±0.1	±0.2	±0.3	±0.5	±1.0	±1.5	±2	±3
Angular Tol.	±1'	±30'	±20'	±10'	refer to the shortest side			
designed by			R.De Salvo					
checked by			G. Gennaro-PROMEC					
date			4-02-06					
scale			1/6					
Title			HAM-OPTICAL BENCH					
Project			LIGO-D051206-00-D					
Sheet			A 1					