

PROFILE
 SCALES: HORIZ: 1" = 50'
 VERT: 1" = 5'

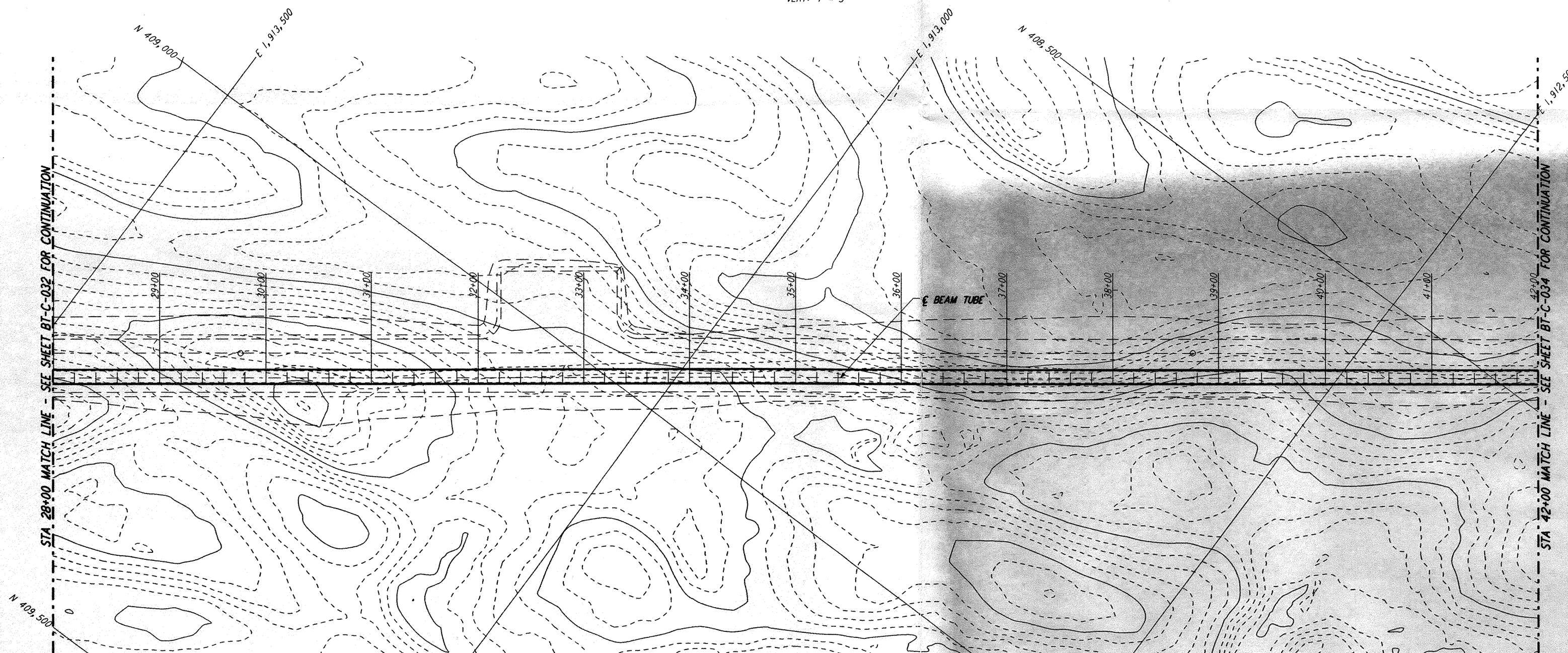

PLAN
 SCALE: 1" = 50'

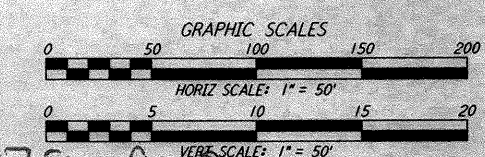
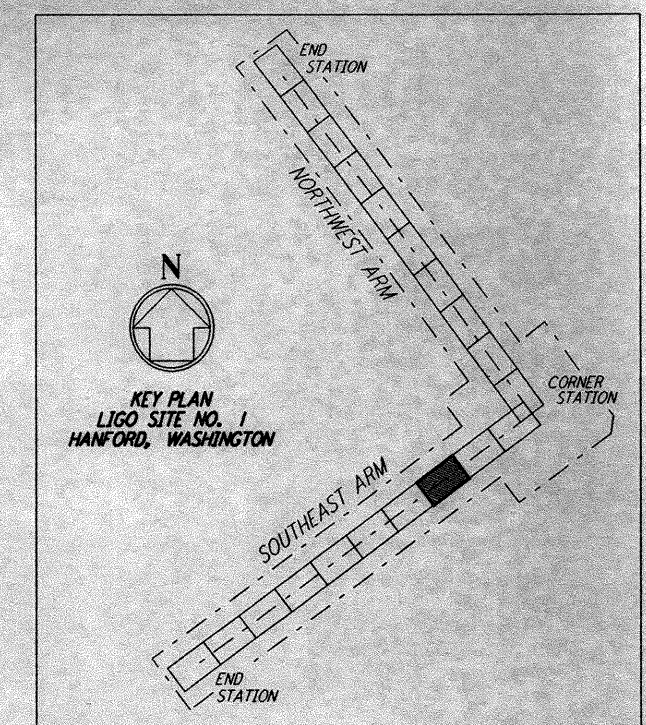

D960178-A-0

REVISION		ISSUE		DATE	
NO.	DATE	APRD BY	DESCRIPTION OF REVISION	NO.	DATE
9				9	8-10-95
8				8	
7				7	
6				6	
5				5	
4				4	
3				3	
2				2	
1	8-14-95		PRELIMINARY DESIGN REPORT	1	8-14-95

PARSONS
 100 WEST WALNUT STREET
 PASADENA, CALIFORNIA

LIGO
 CALIFORNIA INSTITUTE OF TECHNOLOGY
 MASSACHUSETTS INSTITUTE OF TECHNOLOGY

**LASER INTERFEROMETER
 GRAVITATIONAL-WAVE OBSERVATORY
 BEAM TUBE ENCLOSURE - HANFORD, WA**

TITLE: **SOUTHWEST ARM
 PLAN AND PROFILE
 STA 28+00 TO STA 42+00**

SCALE: AS NOTED
 CONTRACT NUMBER: PPI50969
 PROJECT NUMBER: 8094
 SHEET NUMBER: **BT-C-033**

This document and the design it covers are the property of PARSONS. They are loaned only with the borrower's expressed written agreement that they will not be reproduced, copied, loaned, exhibited, or used in any other way, except by written consent from PARSONS to the borrower.

Thu Aug 10 17:21:57 1995 s3-v18h2 KAPLINTS\OUEIFIS\VI8R2\CEM33C.PRF