

**NOTES:**  
 1. SEE SHEET WA-C-002 FOR GENERAL NOTES, LEGEND AND ABBREVIATIONS.

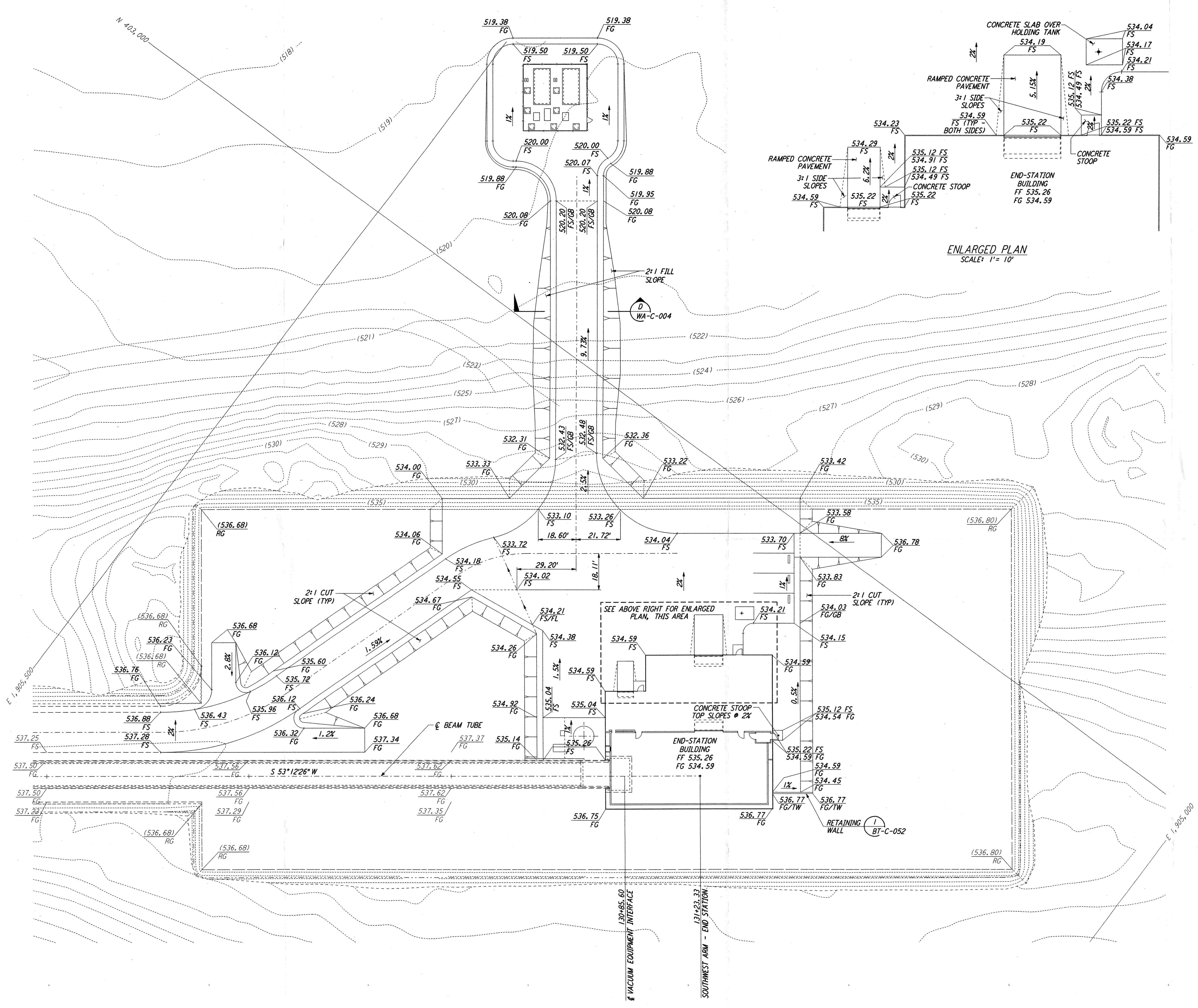

**ENLARGED PLAN**  
 SCALE: 1" = 10'

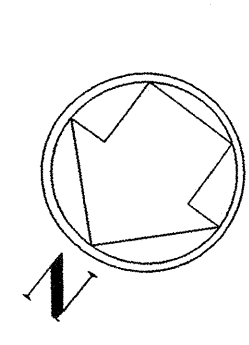
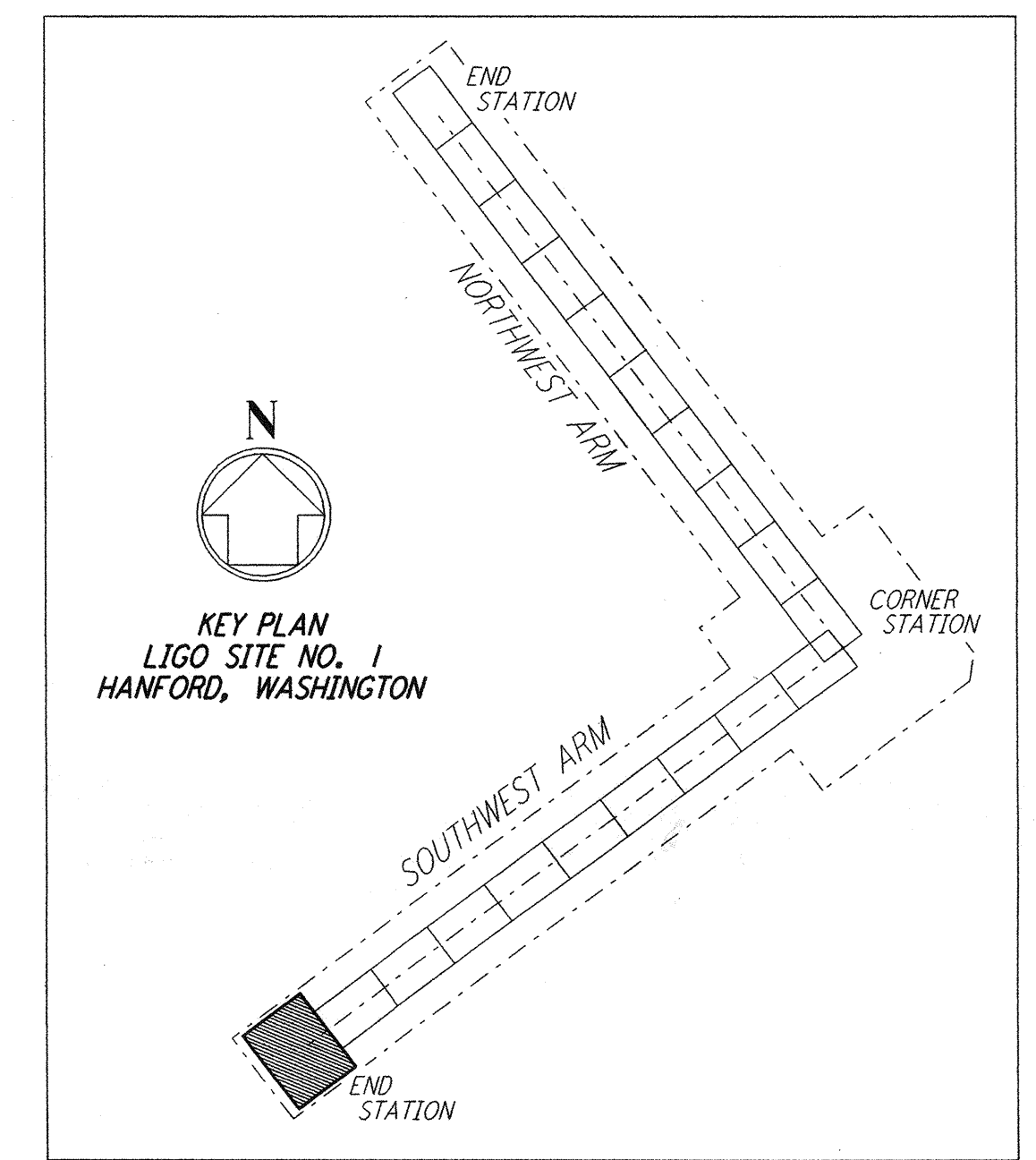

**KEY PLAN**  
 LIGO SITE NO. 1  
 HANFORD, WASHINGTON

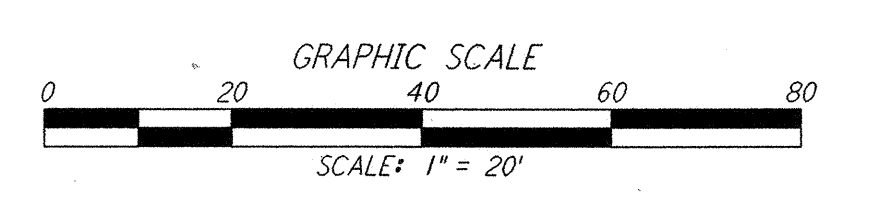

**LIGO-D960232-01-0**

NO.	DATE	BY	CHKD	ENGR	PROJ	DESCRIPTION
1	5/15/98	WRB				ISSUED FOR AS-BUILT

FOR CONSTRUCTION	
DRAWN	WRB 9/28/95
CHECKED	ML 7/9/96
ENGINEER	JB 7/9/96
PROJ	MDW 7/9/96
<b>AS-BUILT DRAWINGS</b>	

**PARSONS**  
 100 WEST WALNUT STREET  
 PASADENA, CALIFORNIA

**LIGO**  
 CALIFORNIA INSTITUTE OF TECHNOLOGY  
 MASSACHUSETTS INSTITUTE OF TECHNOLOGY

<b>LASER INTERFEROMETER GRAVITATIONAL-WAVE OBSERVATORY SITE NO. 1 - HANFORD, WASHINGTON</b>			
TITLE	CIVIL SOUTHWEST ARM END-STATION GRADING PLAN	SCALE 1" = 20'	CONTRACT NUMBER PP150969
			PROJECT NUMBER 8094
			REVISIONS <b>WA-C-046</b>

This document and the design it covers are the property of **PARSONS**. They are loaned only with the borrower's expressed written agreement that they will not be reproduced, copied, loaned, exhibited, or used in any other way, except by written consent from **PARSONS** to the borrower.