

6

5

4

3

2

1

NOTES: (UNLESS OTHERWISE SPECIFIED)

- 1. ALL DIMENSIONS ARE IN MILLIMETERS AND DEGREES-MINUTES.
- 2. DRAWING TO BE INTERPRETED PER ANSI Y14.5M-1982.
- 3. POLISH ALL FACES, EDGES AND CHAMFERS PER SPECIFICATION LIGO-E960100-D.
- 4. REGISTRATION MARK IS LOCATED COINCIDENT WITH THE REGISTRATION MARK DRAWN ON THE BLANK ±5mm.

REV	DATE	DRAWN BY	CHECKED	DCC	DCN/DESCRIPTION
A	9-8-96	C CONLEY	D COYNE		E960113/INITIAL RELEASE
B	10-9-97	C CONLEY			E970065

D

D

C

C

B

B

A

A

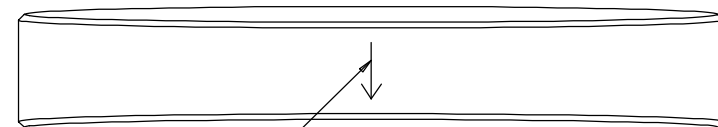
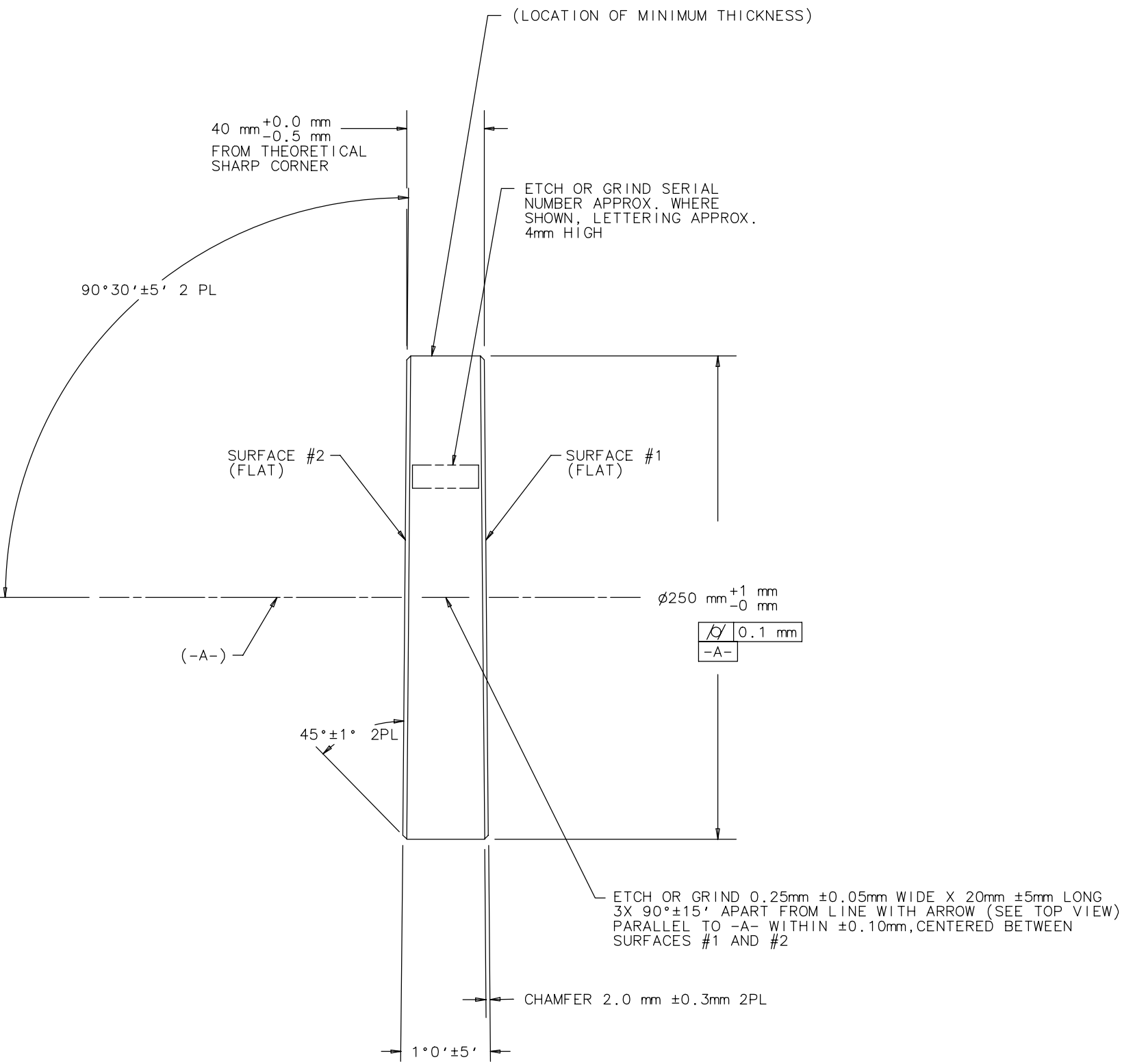

ETCH OR GRIND 0.25mm ± 0.05mm WIDE X 20mm ± 5mm LONG LINE WITH ARROW POINTING TOWARD SURFACE #1, PARALLEL TO -A- WITHIN ± 0.10mm, CENTERED BETWEEN SURFACES #1 AND #2, AND AT LOCATION OF MINIMUM PART THICKNESS ± 1° 0'.

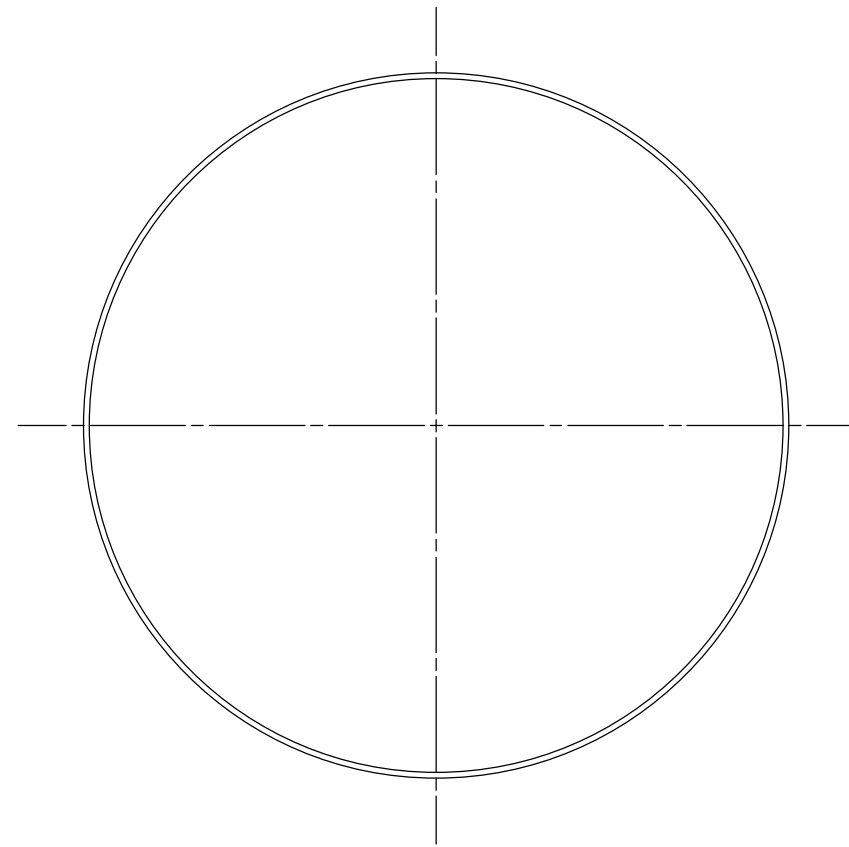

DRWN C CONLEY		DATE 9-8-96	CALIFORNIA INSTITUTE OF TECHNOLOGY		LIGO PROJECT
CHKD			MASSACHUSETTS INSTITUTE OF TECHNOLOGY		
ENGR			CAD FILE: D960789_B.asc		
APPD			dcc file: /home/dcc/docs/D960789-B.pdf		
MATERIAL: FUSED SILICA PER LIGO-E960094-D			BEAM SPLITTER SUBSTRATE		
DO NOT SCALE DRAWING		SCALE: NTS	SIZE B	DRAWING NUMBER D960789-B-D	SHEET 1 OF 1

6

5

4

3

2

1