

This document and the design it covers are the property of PARSONS. They are loaned only with the borrower's expressed written agreement that they will not be reproduced, copied, loaned, exhibited, or used in any other way, except by written consent from PARSONS to the borrower.

5

4

3

2

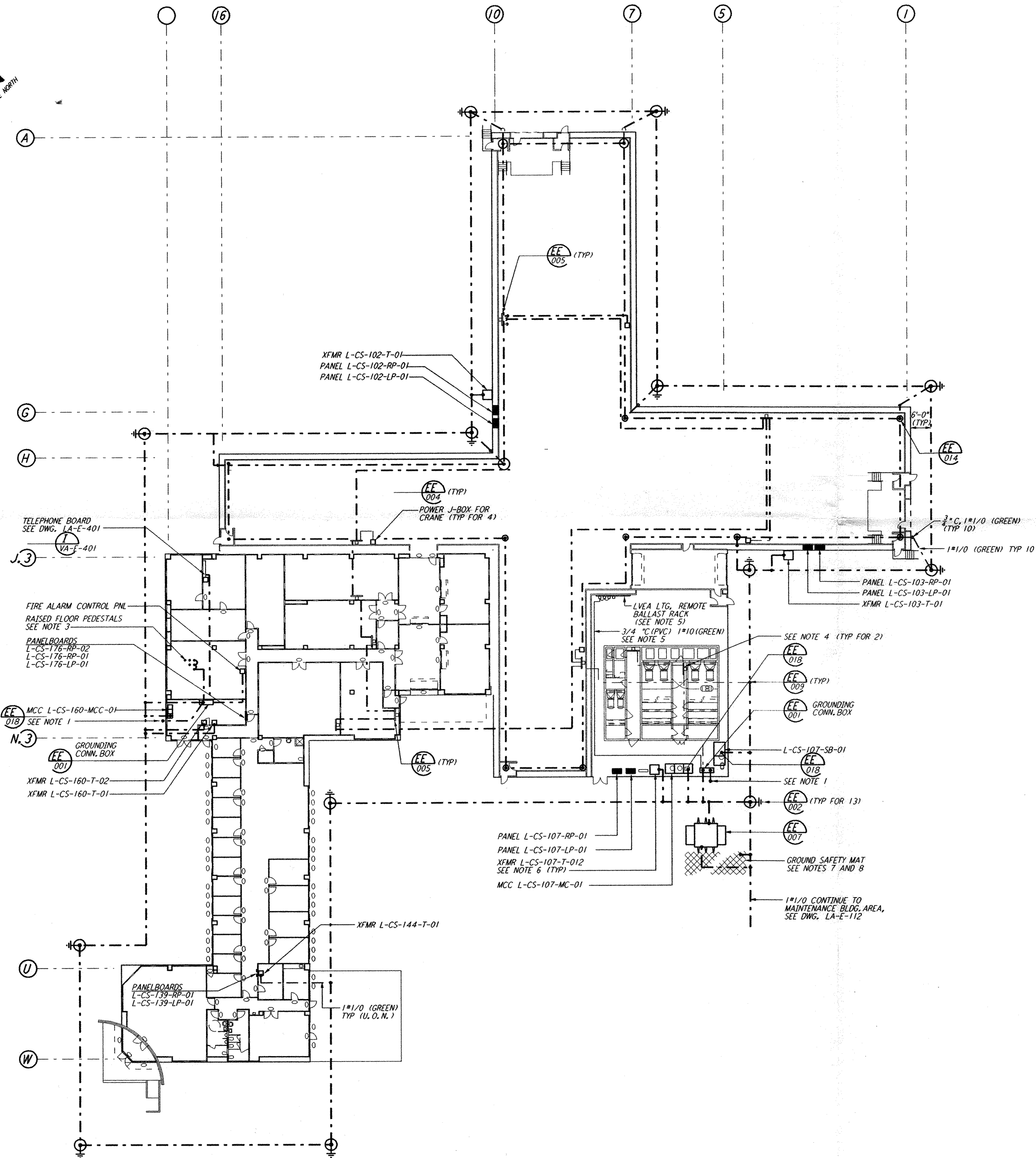
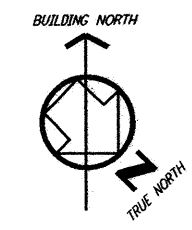

**GENERAL NOTES:**

1. FOR SYMBOLS, ABBREVIATIONS AND ACRONYMS SEE DWG. LA-E-001.
2. FOR PLAN SYMBOLS SEE DWG. LA-E-002.
3. FOR GROUNDING STANDARD INSTALLATION DETAILS SEE DWG. LA-E-406, LA-E-407, AND LA-E-408.
4. PANELBOARDS SHOWN FOR REFERENCE ONLY.

**GENERAL NOTES (LIGHTNING PROTECTION):**

1. INSTALLATION SHALL COMPLY IN ALL RESPECTS WITH LIGHTNING PROTECTION INSTITUTE (LPI) CODE 175 AS REQUIRED PER NFPA 78.
2. FOR LIGHTNING PROTECTION INSTALLATION DETAILS, SEE DWG. LA-E-408.  
 BLDG. METAL WITH CORRUGATED SIDING ROOF FINISH SINGLE PLY MEMBRANE  
 GABLE. ROOF (CENTERED RIDGE) LESS THAN 75'H. LOWER ROOF PROTECTION FOR 50' OR LESS (NFPA 78-10)
3. LOCATE AIR TERMINALS AS SHOWN.
4. SUPPORT ALL EXPOSED ROOF. DOWNLEAD AND BONDING CABLE AT 3'-0\"/>

**NOTES:**

1. CONNECT GROUNDING CONDUCTOR TO FOUNDATION BAR AT BOTTOM. BAR SHALL BE AT LEAST 20 FT. LONG, 1/2\"/>

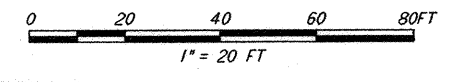

LIGO-D961005-A-0

NO.	DATE	APRD BY	DESCRIPTION OF REVISION
1	10-31-95	TDM	PRELIMINARY DESIGN REVIEW ISSUED FOR

DATE	10-31-95
DRAWN	J. G.
CHECKED	
ENGINEER	
PROJ MGR	

**PARSONS**  
 100 WEST WALNUT STREET  
 PASADENA, CALIFORNIA

**LIGO**  
 CALIFORNIA INSTITUTE OF TECHNOLOGY  
 MASSACHUSETTS INSTITUTE OF TECHNOLOGY

LASER INTERFEROMETER  
 GRAVITATIONAL-WAVE OBSERVATORY  
 SITE NO. 2 - LIVINGSTON, LOUISIANA

TITLE	SHEET NUMBER	CONTRACT NUMBER	PROJECT NUMBER
ELECTRICAL CORNER STATION LVEA GROUNDING PLAN	AS NOTED	PP150969	8094
			REVISION
			<b>LA-E-103</b>

Tue Oct 31 01:22:26 1995 s3-v18b2 J:\PLOTS\QUEUES\18B2\EE103B.PR