

DETAIL 1 REF
 $\frac{1}{4}'' = 1'-0''$
 LA-S-505 LA-S-504 LA-S-504A

DETAIL 2 REF
 $\frac{1}{4}'' = 1'-0''$
 LA-S-505 LA-S-504 LA-S-504A

DETAIL 3 REF
 $\frac{1}{4}'' = 1'-0''$
 LA-S-505 LA-S-504 LA-S-504A

NOTE:
 1. MID STATION FOUNDATION SHOWN IS FOR SOUTHWEST ARM, FOR SOUTHEAST ARM MID STATION FOUNDATION ORIENTATION SEE DETAIL 7 LA-S-506

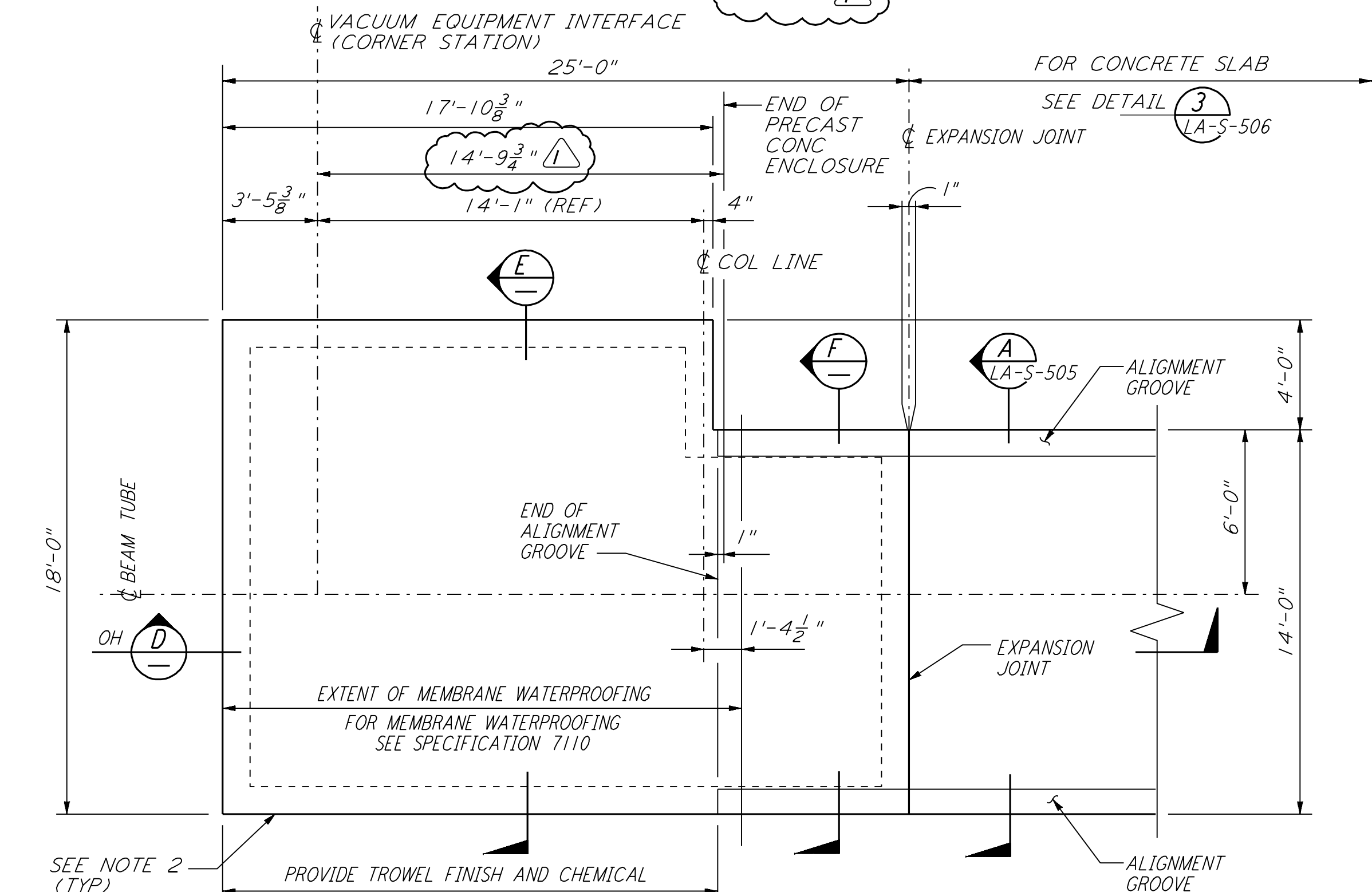

DETAIL 4 REF
 $\frac{1}{4}'' = 1'-0''$
 LA-S-505 LA-S-504 LA-S-504A

TYPICAL BEAM TUBE ENCLOSURE SLAB SECTION A REF
 $\frac{1}{2}'' = 1'-0''$
 LA-S-505 LA-S-506

SECTION B
 $\frac{1}{2}'' = 1'-0''$

NOTE:
 1. FOR GENERAL NOTES, ABBREVIATIONS AND LEGEND SEE DRAWING LA-S-501.
 2. ALL EXTERIOR VERTICAL SURFACES OF FOUNDATIONS SHALL BE FORMED.

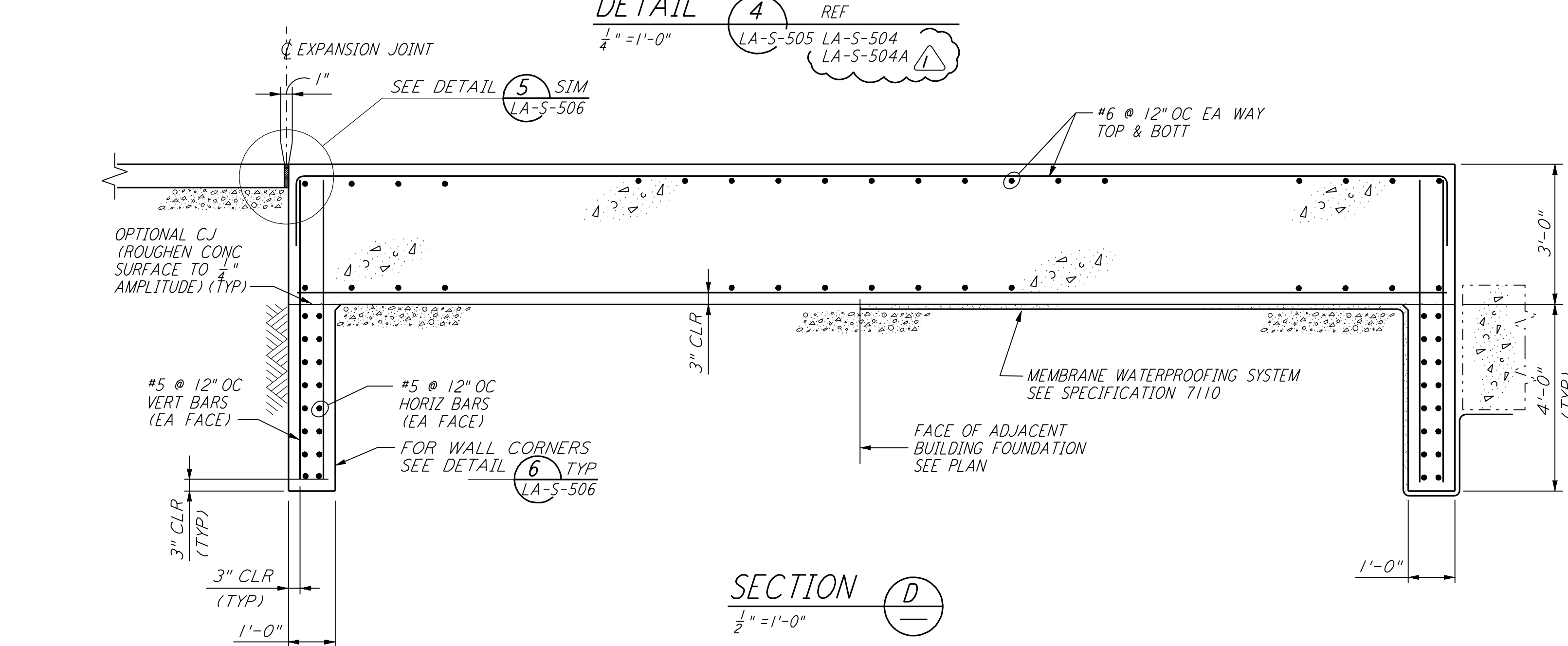
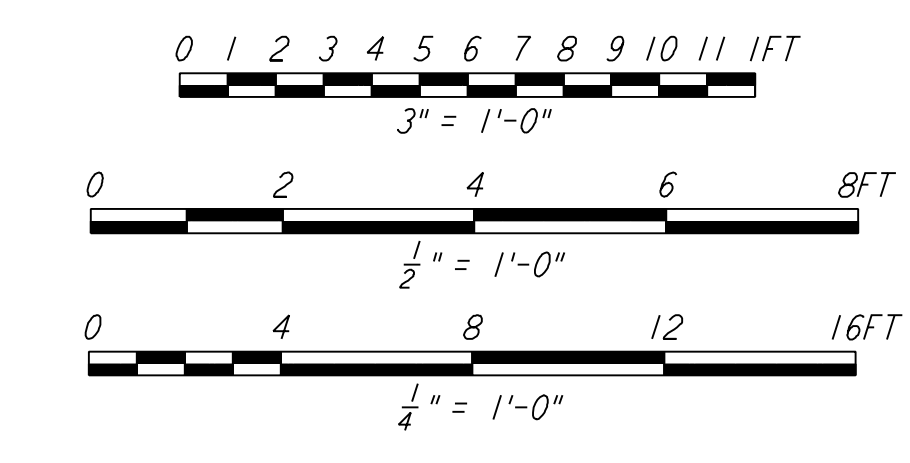

SECTION D
 $\frac{1}{2}'' = 1'-0''$

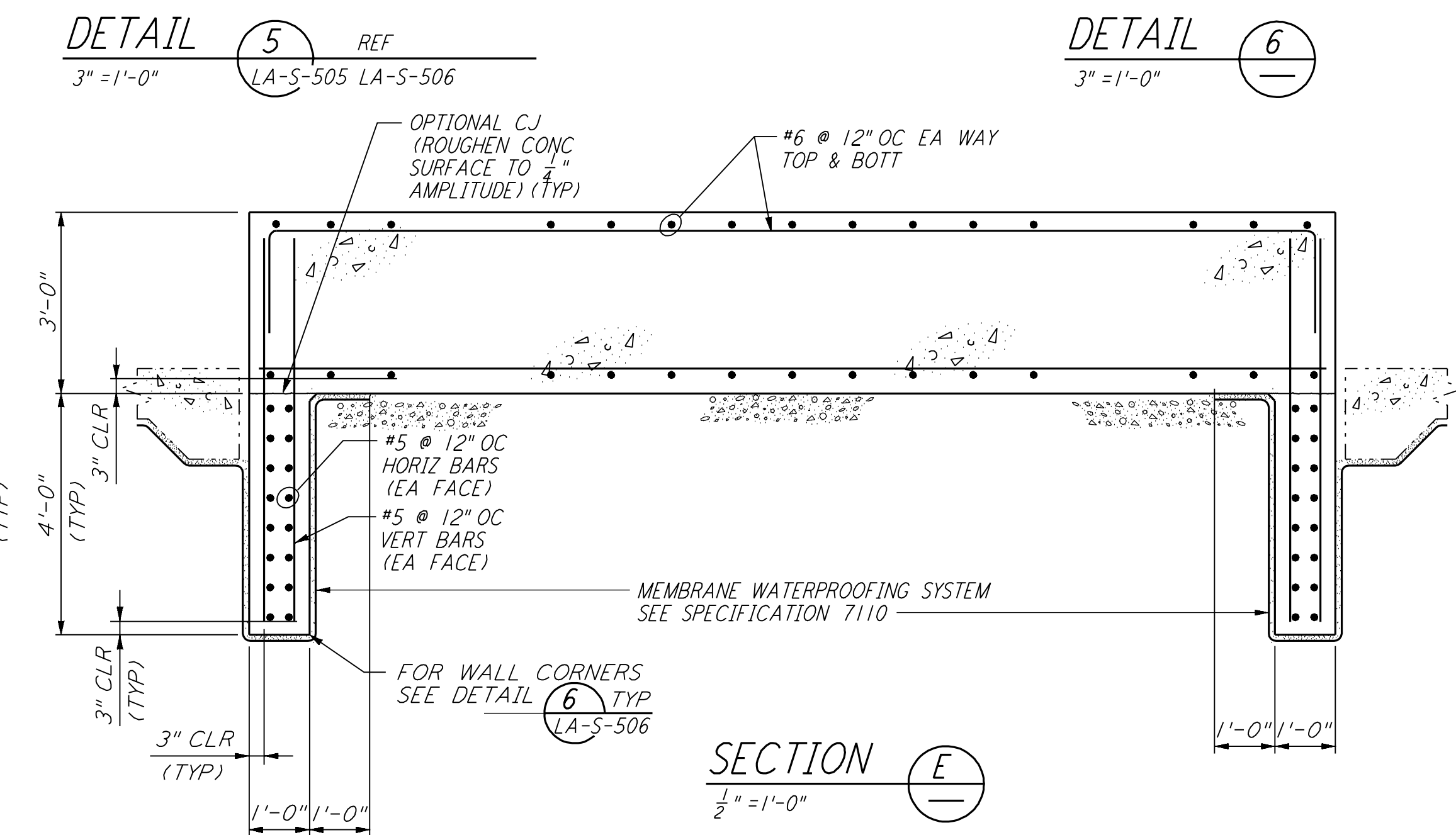

SECTION E
 $\frac{1}{2}'' = 1'-0''$

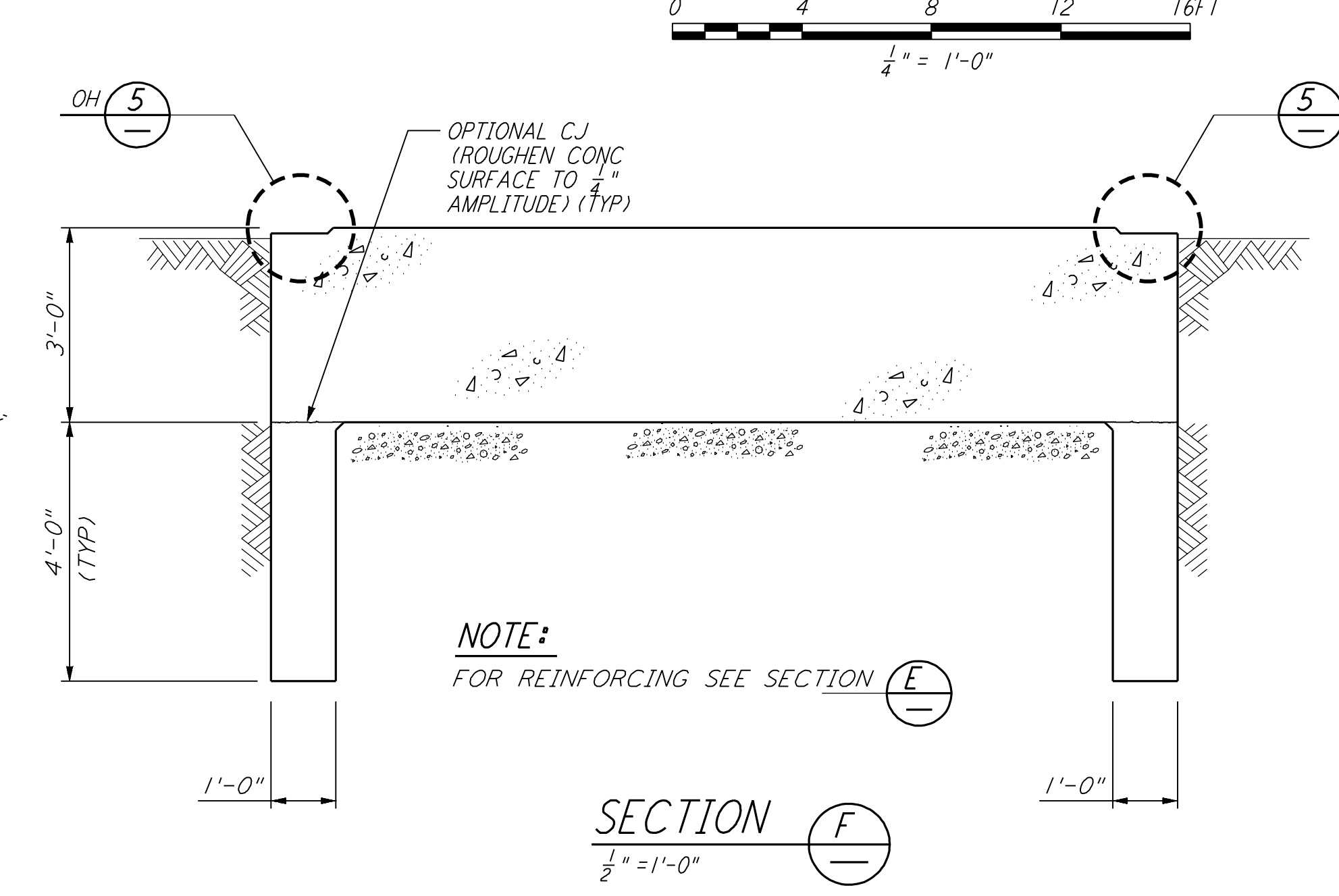

SECTION F
 $\frac{1}{2}'' = 1'-0''$

NOTE:
 FOR REINFORCING SEE SECTION E

This document and the design it covers are the property of PARSONS. They are loaned only with the borrower's expressed written agreement that they will not be reproduced, copied, loaned, exhibited, or used in any other way, except by written consent from PARSONS to the borrower.

REV	NO.	DATE	BY	CHKD	ENGR	PROJ	DESCRIPTION
1	2-28-97	GP					REV DIMS & REFS AT DET 1 THRU 4

ISSUED FOR CONSTRUCTION		
DRAWN	MCS	11-15-96
CHECKED	DDM	11-15-96
ENGINEER	BP	11-15-96
PROJ	TDM	11-15-96

PARSONS
 100 WEST WALNUT STREET
 PASADENA, CALIFORNIA

LIGO
 CALIFORNIA INSTITUTE OF TECHNOLOGY
 MASSACHUSETTS INSTITUTE OF TECHNOLOGY

LIGO-D961240-01-0
 LASER INTERFEROMETER
 GRAVITATIONAL-WAVE OBSERVATORY
 BEAM TUBE ENCLOSURE - LIVINGSTON, LA

TITLE	SCALE	CONTRACT NUMBER	PROJECT NUMBER
STRUCTURAL BEAM TUBE ENCLOSURE SECTIONS & DETAILS SHEET 1	AS NOTED	PP150969	8094
SHEET NUMBER	LA-S-505		