

NOTES:

1. SEE CIVIL DRAWING LA-C-541 FOR ACTUAL LOCATION OF ELECTRICAL VAULT.
2. SEE SPECIFICATION SECTION 16670 FOR LIGHTNING PROTECTION AND GROUNDING MATERIAL.
3. LARGE DIAMETER PVC CONDUIT ELBOW SHALL ACCOMMODATE 15 KV TERMINATION ELBOW (TERMINATOR BY OTHERS)
4. CONDUIT ELBOW STUB-UPS AT ELECTRICAL VAULT ARE BEING PROVIDED TO ACCOMMODATE FUTURE BAKE-OUT TRANSFORMERS BY OTHERS.
5. PROVIDE PULLROPE AND CONDUIT CAPS FOR ALL CONDUIT STUB-UPS.

This document and the design it covers are the property of PARSONS. They are loaned only with the borrower's expressed written agreement that they will not be reproduced, copied, loaned, exhibited, or used in any other way, except by written consent from PARSONS to the borrower.

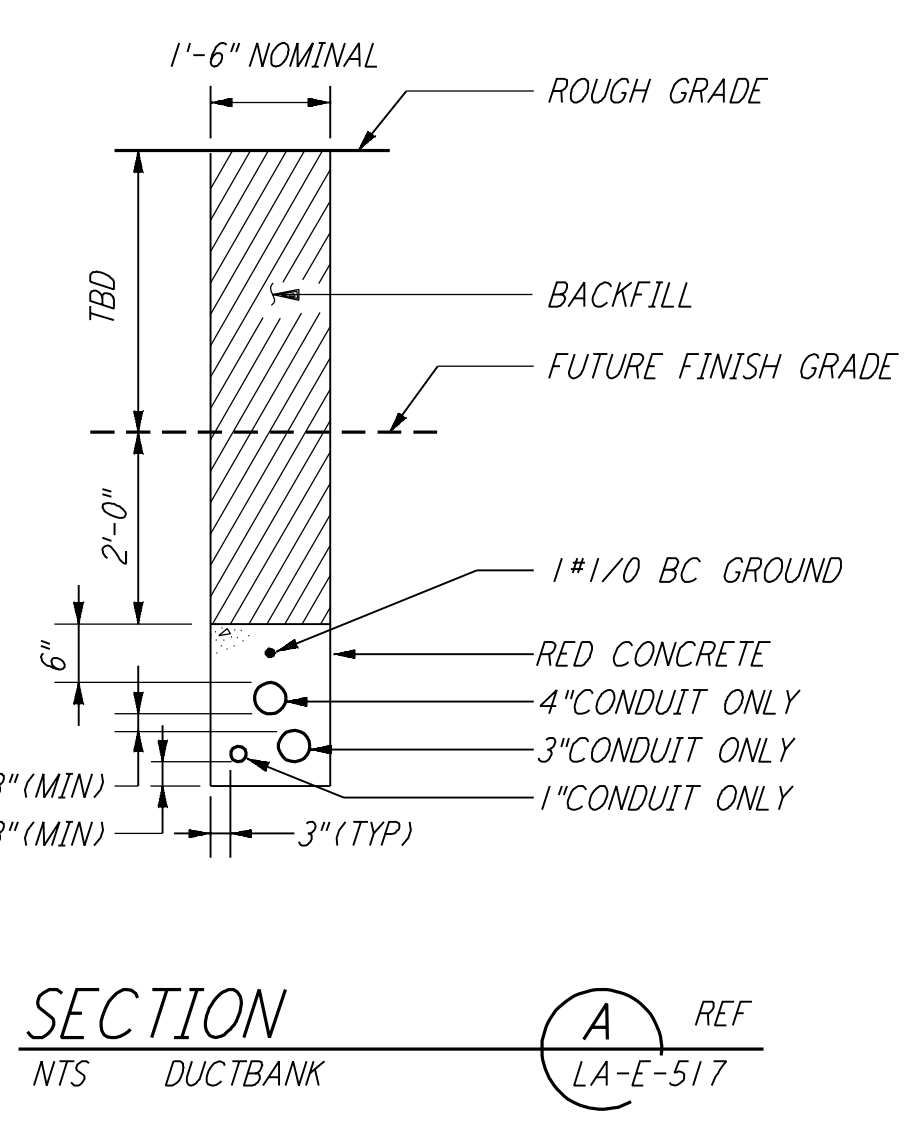
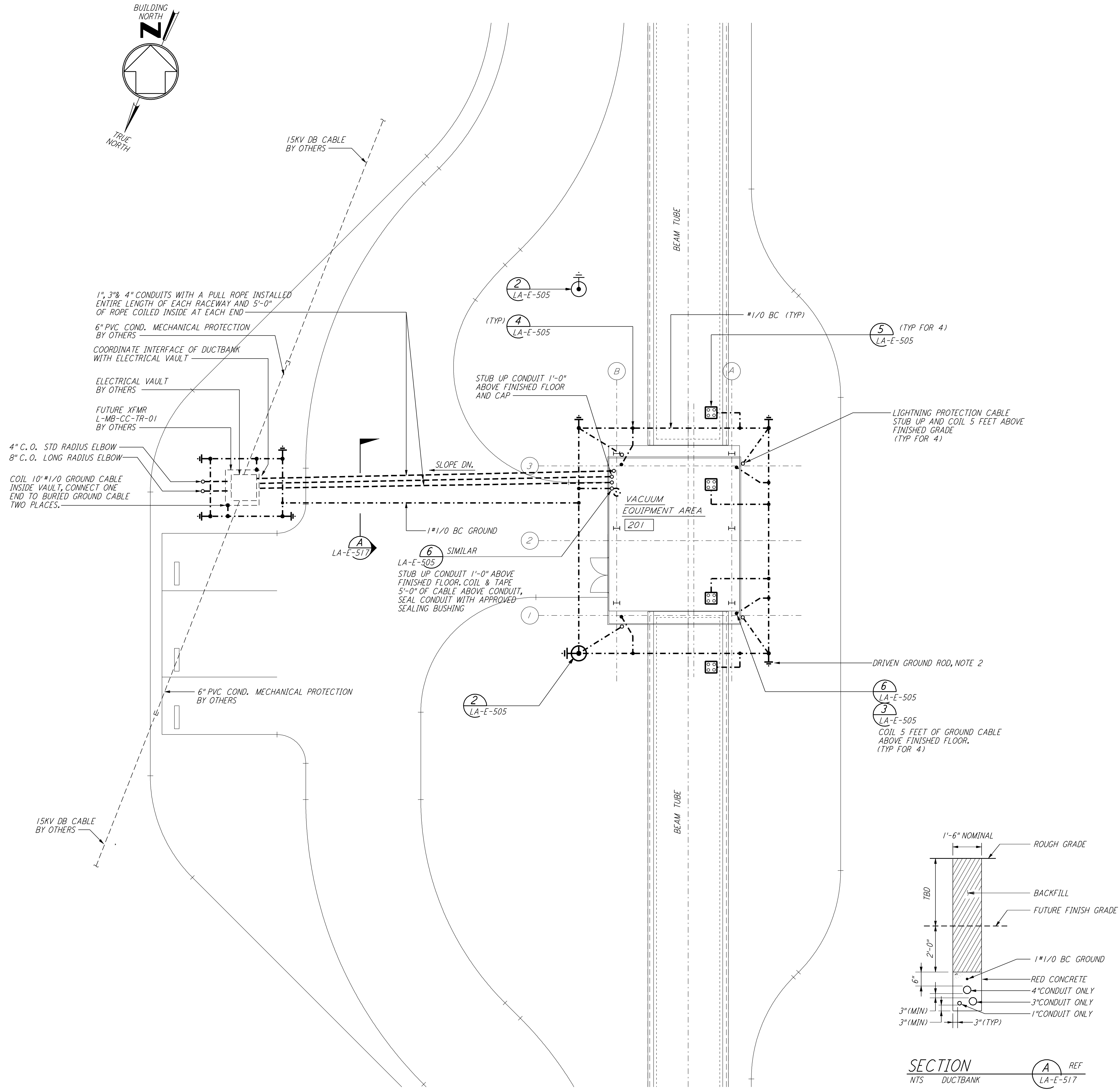

GROUNDING & UNDERGROUND PLAN

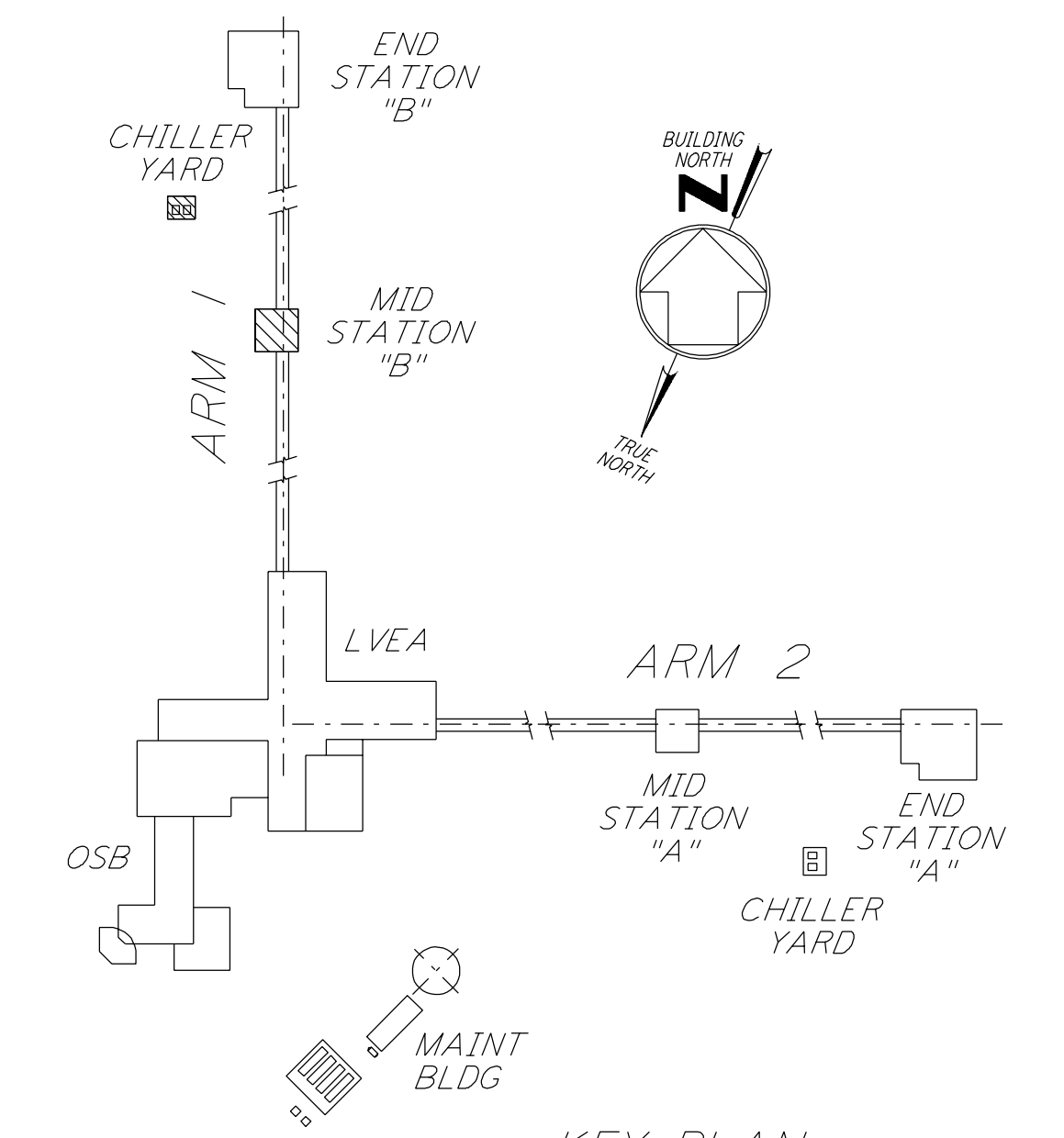
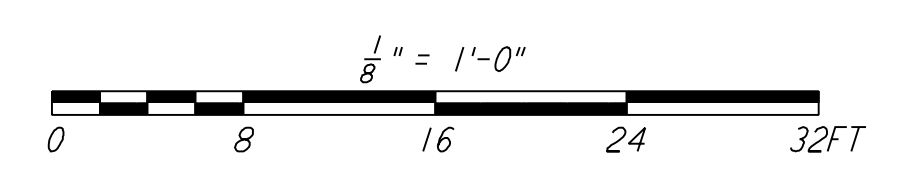

LIGO-D961245-00-0

NO.	DATE	BY	CHKD	ENGR	PROJ	DESCRIPTION

ISSUED FOR CONSTRUCTION	
DRAWN	M. M. 11-15-96
CHECKED	
ENGINEER	
PROJ	

PARSONS

100 WEST WALNUT STREET
PASADENA, CALIFORNIA

LIGO

CALIFORNIA INSTITUTE OF TECHNOLOGY
MASSACHUSETTS INSTITUTE OF TECHNOLOGY

LASER INTERFEROMETER
GRAVITATIONAL-WAVE OBSERVATORY
BEAM TUBE ENCLOSURE - LIVINGSTON, LA

**ELECTRICAL
MID STATION B
GROUNDING &
UNDERGROUND PLAN**

SCALE AS NOTED
CONTRACT NUMBER PP150969
PROJECT NUMBER 8094

SHEET NUMBER
LA-E-517