

NOTES:

1. SEE CIVIL DRAWING LA-C-541 FOR ACTUAL LOCATION OF ELECTRICAL VAULT.
2. SEE SPECIFICATION SECTION 16670 FOR LIGHTNING PROTECTION AND GROUNDING MATERIAL.
3. LARGE DIAMETER PVC CONDUIT ELBOW SHALL ACCOMMODATE 15 KV TERMINATION ELBOW (TERMINATOR BY OTHERS)
4. CONDUIT ELBOW STUB-UPS AT ELECTRICAL VAULT ARE BEING PROVIDED TO ACCOMMODATE FUTURE BAKE-OUT TRANSFORMERS BY OTHERS.
5. PROVIDE PULLROPES AND CONDUIT CAPS FOR ALL CONDUIT STUB-UPS.

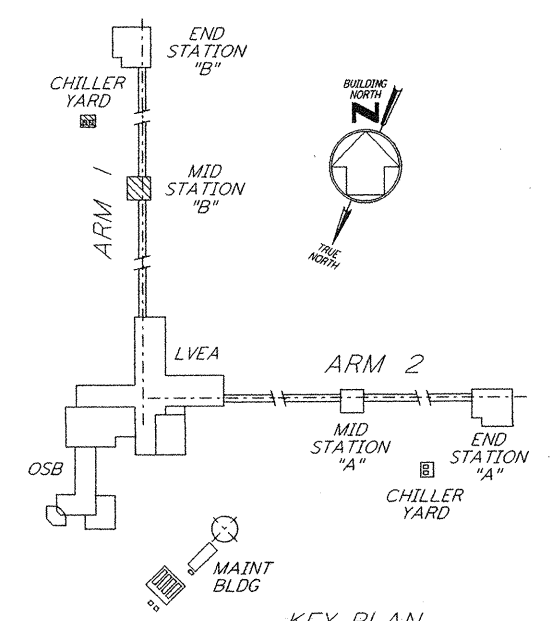

GROUNDING & UNDERGROUND PLAN

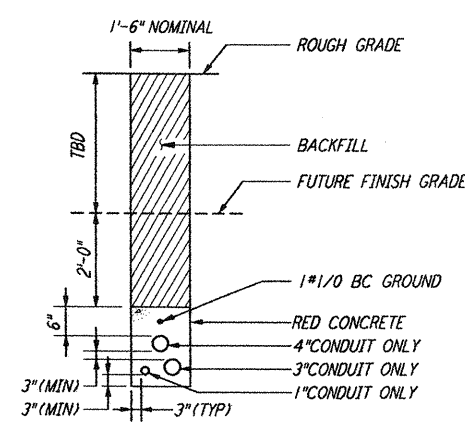
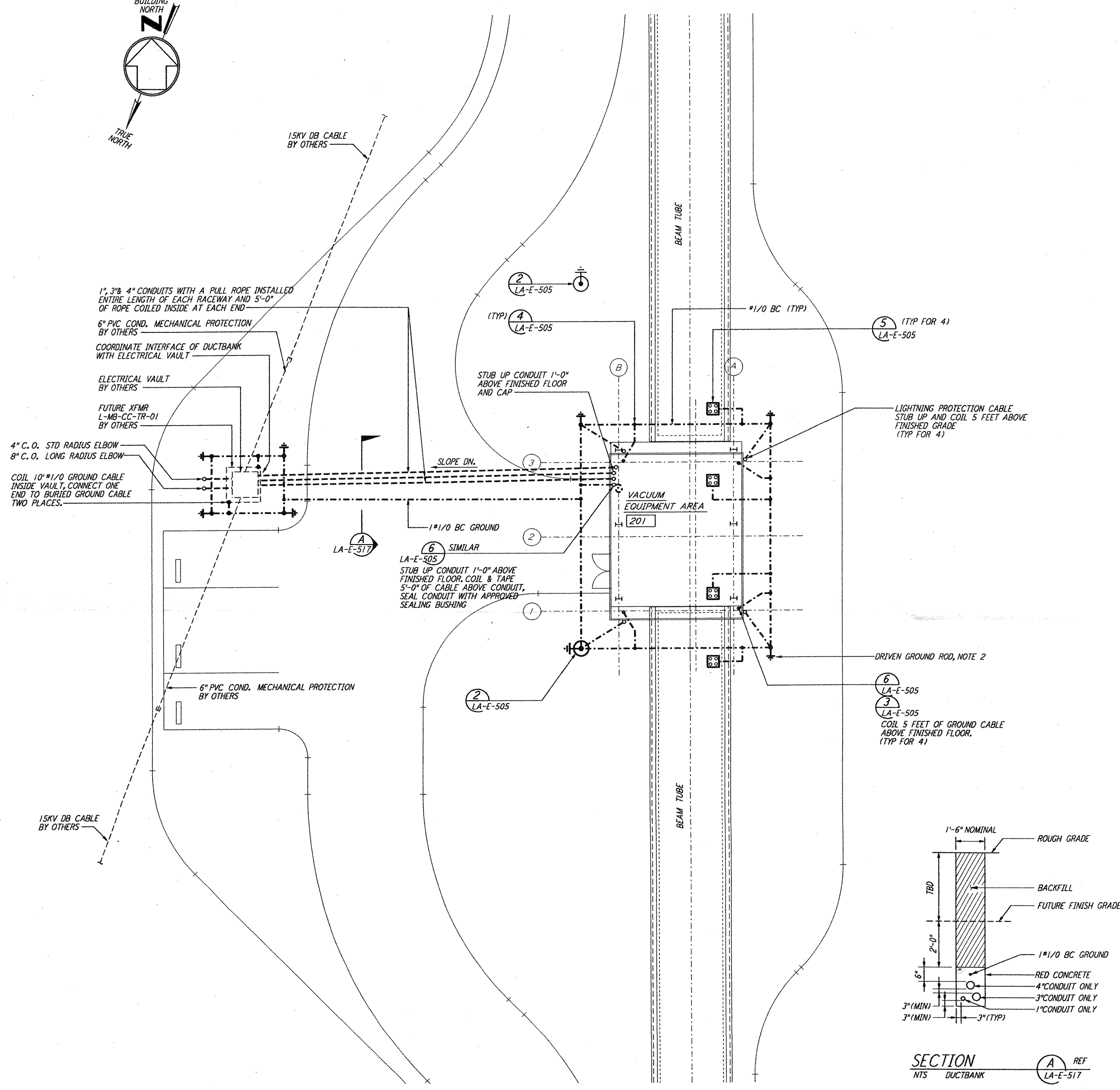
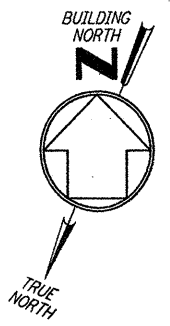
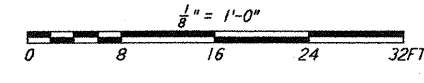

This document and the design it covers are the property of PARSONS. They are loaned only with the borrower's expressed written agreement that they will not be reproduced, copied, loaned, exhibited, or used in any other way, except by written consent from PARSONS to the borrower.

NO.	DATE	BY	CHKD	ENGR	PROJ	ISSUED FOR AS BUILT
1	1-15-99	MEI	--	--	MDW	ISSUED FOR AS BUILT

ISSUED FOR CONSTRUCTION
 DRAWN M. M. 11-15-96
 CHECKED
 ENGINEER
 PROJ

AS-BUILT DRAWINGS

PARSONS
 100 WEST WALNUT STREET
 PASADENA, CALIFORNIA

LIGO
 CALIFORNIA INSTITUTE OF TECHNOLOGY
 MASSACHUSETTS INSTITUTE OF TECHNOLOGY

LIGO-D961245-01-0
 LASER INTERFEROMETER
 GRAVITATIONAL-WAVE OBSERVATORY
 BEAM TUBE ENCLOSURE - LIVINGSTON, LA

**ELECTRICAL
 MID STATION B
 GROUNDING &
 UNDERGROUND PLAN**

SCALE: AS NOTED
 CONTRACT NUMBER: PP150969
 PROJECT NUMBER: 8094

SHEET NUMBER: **LA-E-517**

Thu Jan 14 15:28:42 1999 CAPLOT\GUE\33-9882.DWG 52885 KAV3682.wa57baprf LIGOLF3.BOR