

REVISIONS			
REV.	DESCRIPTION	APPROVED	DATE
A	RELEASED	AJL	10-25-96

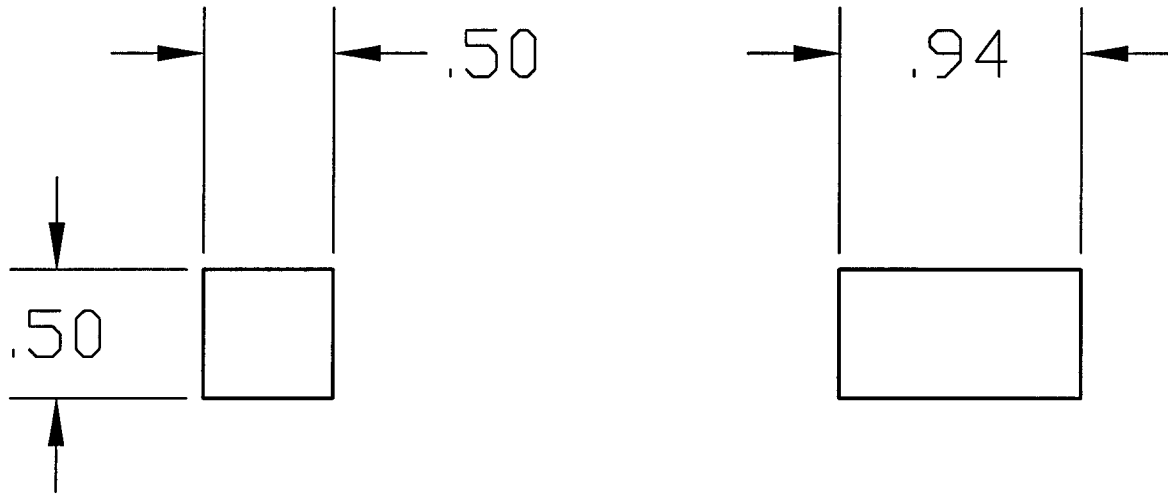

DEC 19 1996

PSI DWG # 1049-8-523

REV. A  
A  
DWG. NO. 103830

		1/2" SQUARE BAR	
ITEM	QTY.	PART NO.	DESCRIPTION
PART LIST			MATERIAL SPECIFICATION: 304 SST
<small>UNLESS OTHERWISE SPECIFIED DIMENSIONS ARE IN INCHES TOLERANCES ARE: DECIMALS ANGLES FINISH .XX ± .01 ± 1° 32/ .XXX ± .005</small>		<small>CONTRACT OR SALES ORDER NO.</small>  <small>APPRX. WT.</small>  <small>APPROVALS</small>	
<small>UNSPECIFIED FILLETS: R.015 BREAK EDGES .010 ± 45° REMOVE ALL BURRS</small>		<small>DATE</small>	
<small>THIRD ANGLE PROJECTION</small> 		<small>DRAFTER</small> AJL	<small>DATE</small> 10-25-96
<small>DO NOT SCALE DRAWING</small>		<small>CHECKER</small> 	<small>ENGINEER</small> 
<small>CADD FILE NAME</small> A103830A		<small>TITLE</small> SPACER BLOCK G44E, G48E	
<small>USED ON</small> B103305-02		<small>SCALE:</small> NONE	<small>DWG. NO.</small> 103830
		<small>SHEET</small> 1	<small>OF</small> 1

L190-D961639-A-V