

**NOTES:**  
 1. SEE SHEET RG-C-002 FOR GENERAL NOTES, LEGEND AND ABBREVIATIONS.

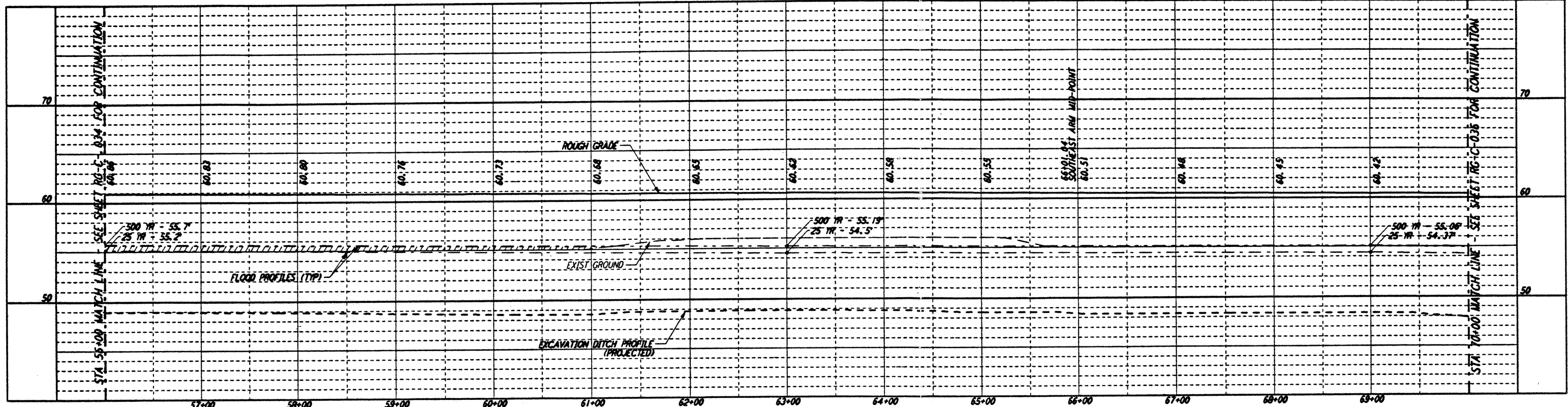

CURVE DATA				
Δ	RADIUS	LENGTH	TANGENT	
11	45°00'00"	39.00'	30.63'	16.18'
12	45°00'00"	25.00'	19.63'	10.36'

**PROFILE**  
 SCALES: HORIZ: 1" = 50'  
 VERT: 1" = 5'

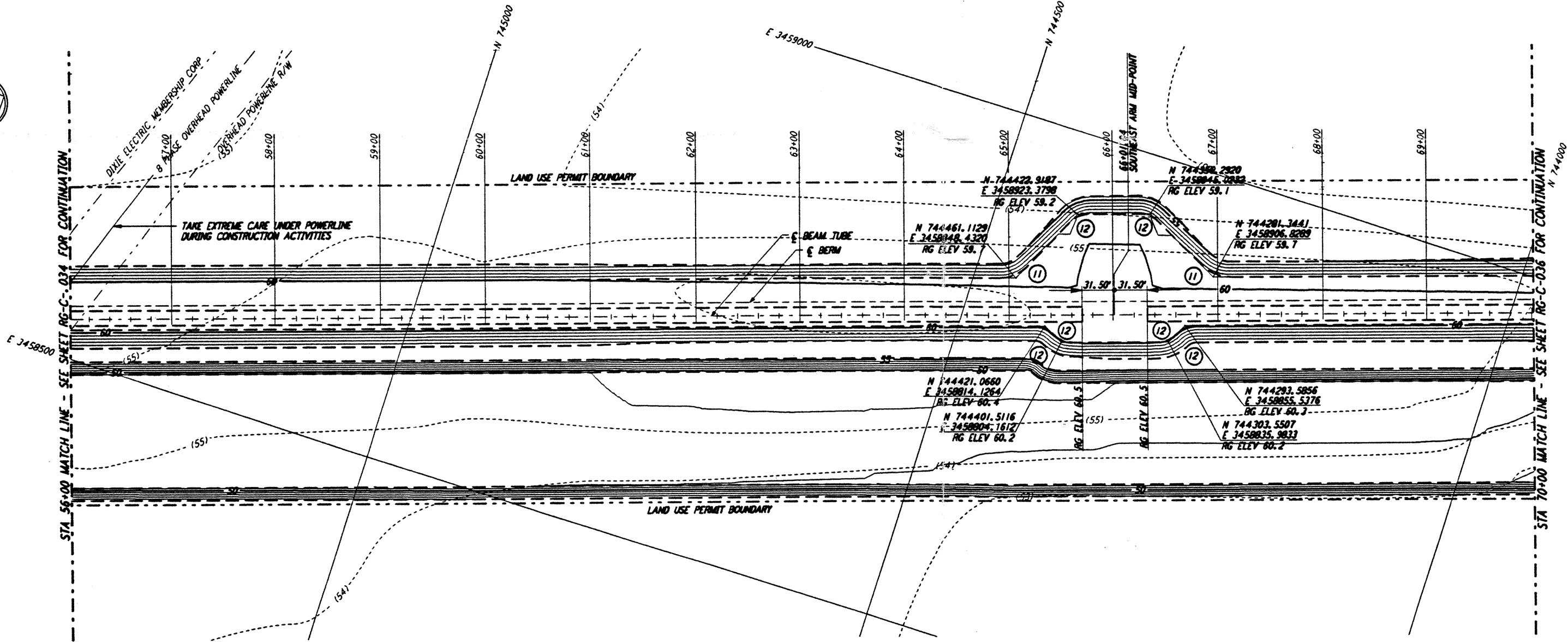

**PLAN**  
 SCALE: 1" = 50'

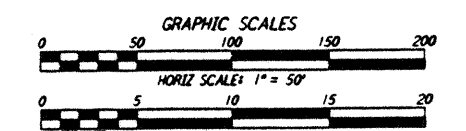
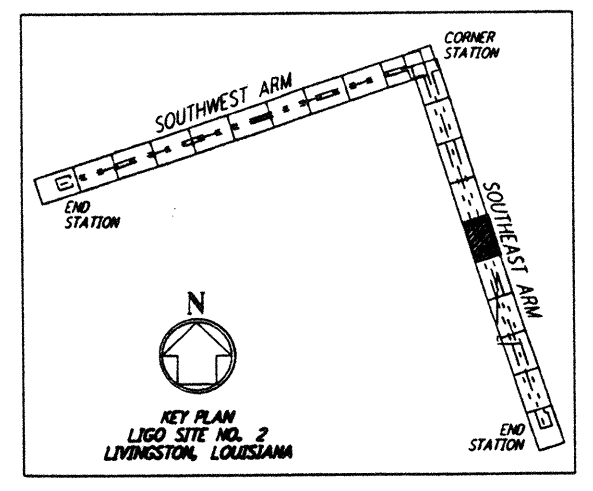

LIG0-0961740-00-0

not be reproduced, copied, loaned, exhibited, or used in any other way, except by written consent from PARSONS to the borrower.

This document and the design it covers are the property of PARSONS. They are loaned only with the borrower's expressed written agreement that they will

NO.	DATE	APPROVED BY	DESCRIPTION OF REVISION
9			
8			
7			
6			
5			
4			
3			
2			
1	8/28/95	TDm	ISSUED FOR BID

DATE	8/11/95
DRAWN	NRB 8/95
CHECKED	MCP 8/8/95
ENGINEER	3/24/95
PROJ MGR	8/23/95

**PARSONS**  
 100 WEST WALNUT STREET  
 PASADENA, CALIFORNIA

**LIGO**  
 CALIFORNIA INSTITUTE OF TECHNOLOGY  
 MASSACHUSETTS INSTITUTE OF TECHNOLOGY

LASER INTERFEROMETER  
 GRAVITATIONAL-WAVE OBSERVATORY  
 ROUGH GRADING - LIVINGSTON, LA

TITLE: ROUGH GRADING SOUTHEAST ARM PLAN AND PROFILE STA 56+00 TO STA 70+00

AS NOTED PP150969 8094

RG-C-035