

NOTES: (UNLESS OTHERWISE SPECIFIED)
 1. BREAK ALL SHARP EDGES.
 2. SEE NOTE 13 AT ASSEMBLY LEVEL TO ASSURE APPROPRIATE DIMENSION FOR FULL PENETRATION WELD.

| REV | DATE | DRAWN BY | CHECKED | DCC | DCN/DESCRIPTION |
|-----|---------|-----------|----------|-----|--------------------------------------|
| A | 8/18/98 | C. Conley | D. Coyne | | E980078-00/INITIAL RELEASE |
| B | 8/22/98 | C. Conley | | | E980230-00/REPLACED VENTING FEATURES |

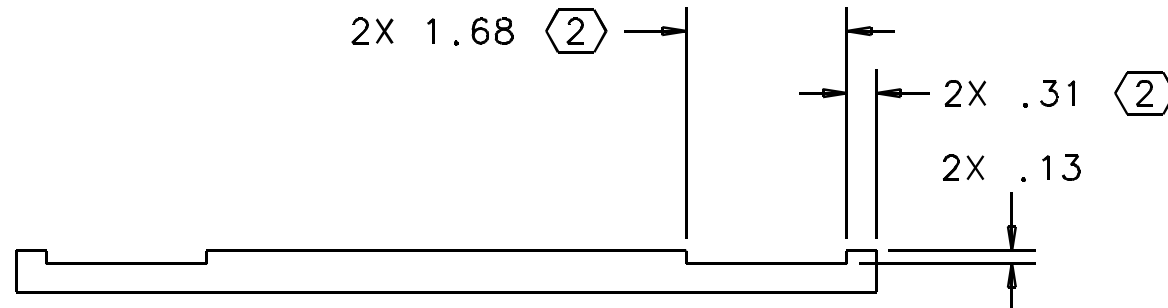
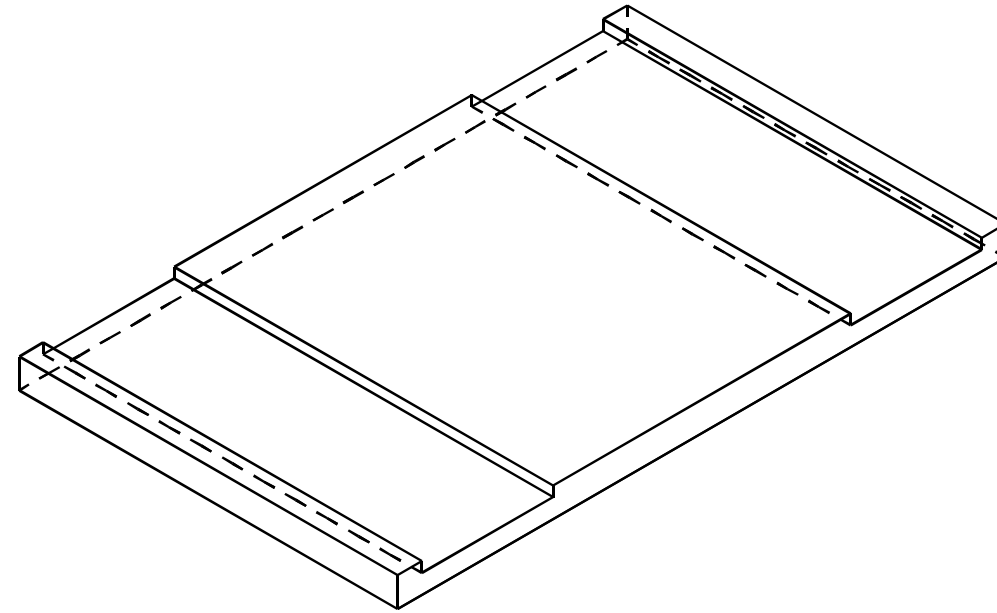
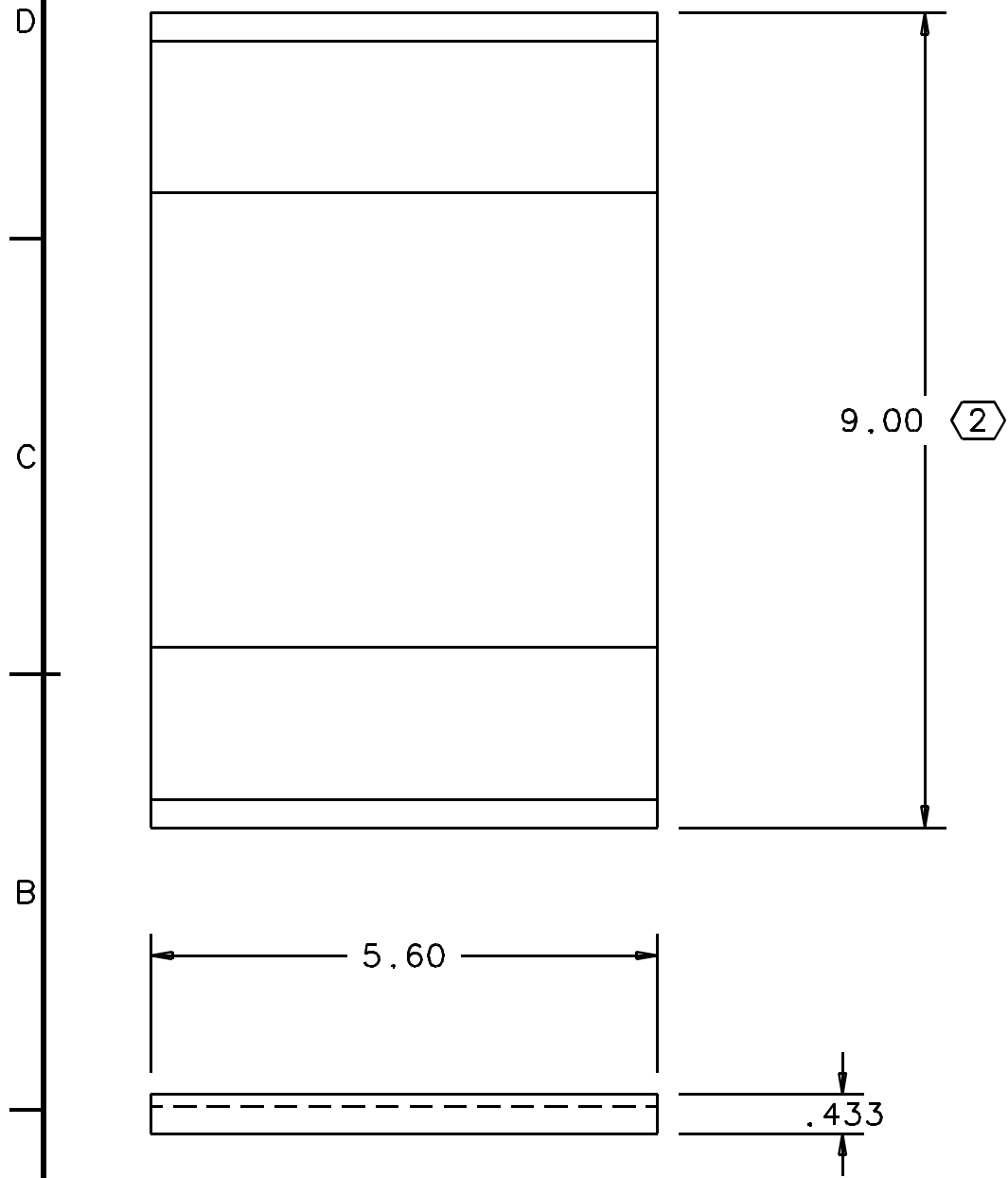

| QTY | REQD | FSCM NO | PART OR IDENTIFYING NO | PART | NOMENCLATURE OR DISCRPTION | MATERIAL SPECIFICATION | ITEM NO |
|---|-----------|---------|------------------------|---|----------------------------|------------------------|---------|
| - | - | - | - | - | - | 304 STAINLESS STEEL | - |
| PARTS LIST | | | | | | | |
| DRWN | C. Conley | DATE | 8/18/98 | CALIFORNIA INSTITUTE OF TECHNOLOGY MASSACHUSETTS INSTITUTE OF TECHNOLOGY | | | |
| CHKD | | | | LIGO PROJECT | | | |
| ENGR | | | | 1-Deas CAD file: D970549_B.dwg dcc file: D970549-B.pdf | | | |
| APPD | | | | TITLE | | | |
| UNLESS OTHERWISE SPECIFIED: DIMENSION UNITS ARE inch (mm) TOLERANCES ARE: X.XXX: ± 0.005 X.XX: ± 0.01 ANGLES: ± 0.5° | | | | LOS2 STIFFENER ADAPTER PLATE | | | |
| NEXT ASSEMBLY: D970506 | | | | SCALE: 1/2 | SIZE | DRAWING NUMBER | SHEET |
| | | | | B | D970549-B-D | | 1 OF 1 |