

8 7 6 5 4 3 2 1

REVISIONS			
REV.	DESCRIPTION	DATE	APPROVED

D

D

C

C

B

B

A

A

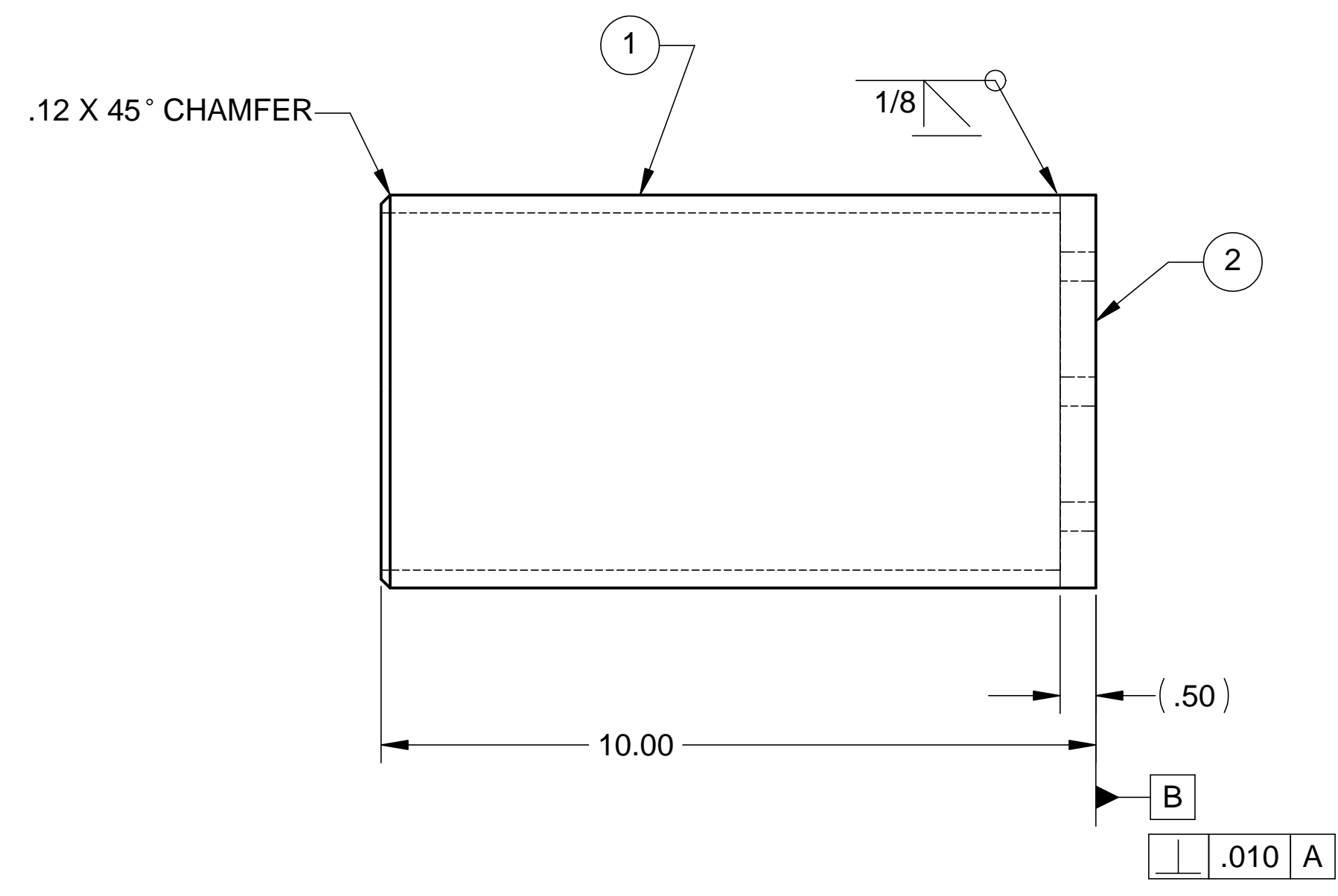
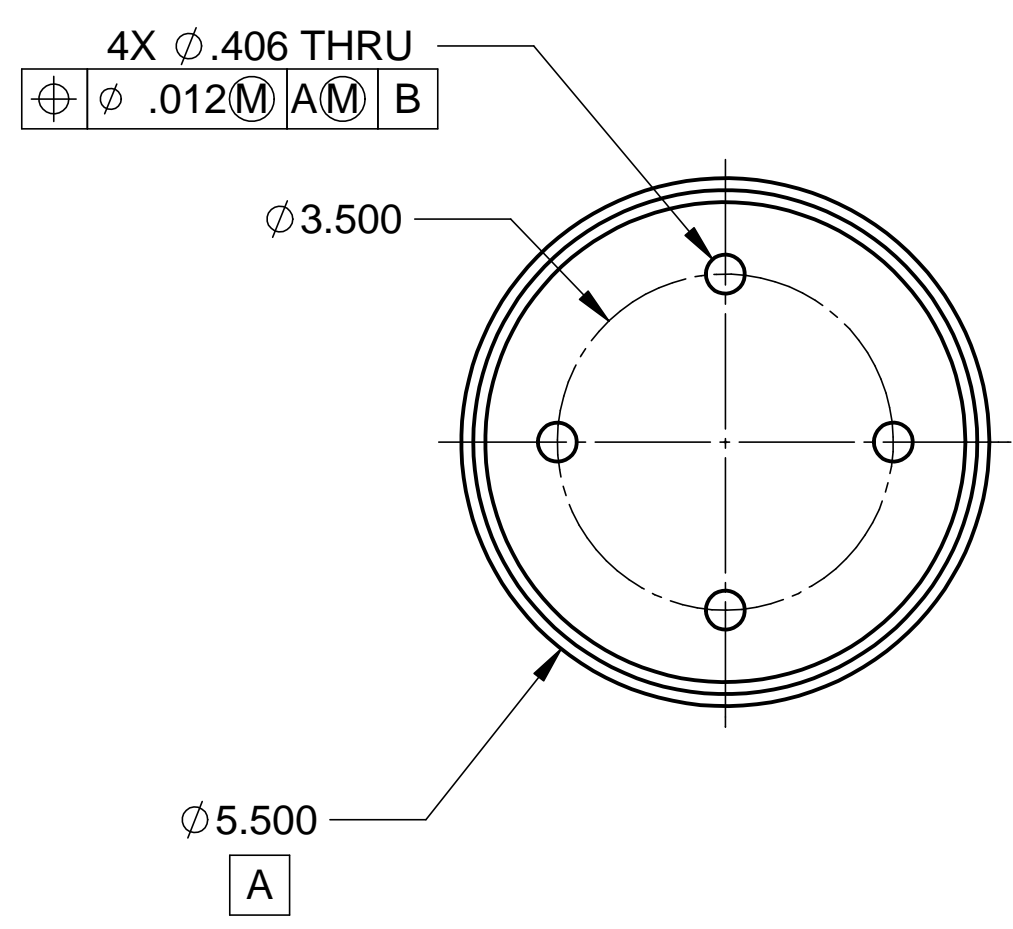

NOTES: UNLESS OTHERWISE SPECIFIED

- ALL DIMENSIONS IN INCHES
- DIMENSIONS AND TOLERANCING PER ASME Y14.5M-1994
- SURFACE TEXTURE PER ANSI/ASME B 46.1-1985
- REMOVE ALL BURRS AND BREAK SHARP EDGES TO A MAXIMUM OF .015
- ALL INSIDE CORNERS TO BE .015 RADIUS MAX
- COUNTERSINK 82 DEGREES ALL TAPPED HOLES TO MAJOR DIAMETER
- COUNTERSINK 82 DEGREES APPROXIMATELY .015 DEEP ALL DRILLED HOLES
- PART NUMBER (DRAWING NO. PLUS DASH NO.) TO BE CLEARLY MARKED ON THE PART ITSELF.
- NO SULFUR BASED CUTTING FLUIDS ALLOWED. APPROVED MACHINE LUBRICANT: ALUMICUT, MISTIC METAL MOVER, PRINCETON, IL.
- PART WEIGHS 5.0 Lbs.

ITEM NO.	QTY.	DESCRIPTION	MATERIAL
1	1	TUBING, 5.5 O.D X .25 WALL	6061-T6 ALUM.
2	1	PLATE, 1/2" THK	6061-T6 ALUM.

PARTS LIST			
UNLESS OTHERWISE SPECIFIED: DIMENSIONS ARE IN INCHES -TOLERANCES-		CAD GENERATED DRAWING, DO NOT MANUALLY UPDATE DO NOT SCALE DRAWING	
DECIMALS .XX = +/- .03 .XXX = +/- .010	ANGULAR = +/- .30° SURFACE FINISH = 250	<b>HYTEC, INC</b> TITLE <b>BSC BELLOWS            SUPPORT TUBE            SLEEVE</b>	
FINISH	SIGNATURE	DATE	DWG. NO. <b>D972456</b> SIZE <b>D</b> SHEET NO. <b>1 of 1</b> SCALE <b>1/2</b> REVISION
DESIGNED	W. K. MILLER	5-8-98	
DRAWN	W. K. MILLER	5-8-98	
CHECKED	HARRY SALAZAR	-	
PART NO. <b>D972456-1</b>	ENGR.	T. THOMPSON	-
	APPROVED	T. THOMPSON	-

8 7 6 5 4 3 2 1