

8 7 6 5 4 3 2 1

REVISIONS			
REV.	DESCRIPTION	DATE	APPROVED

D

D

C

C

B

B

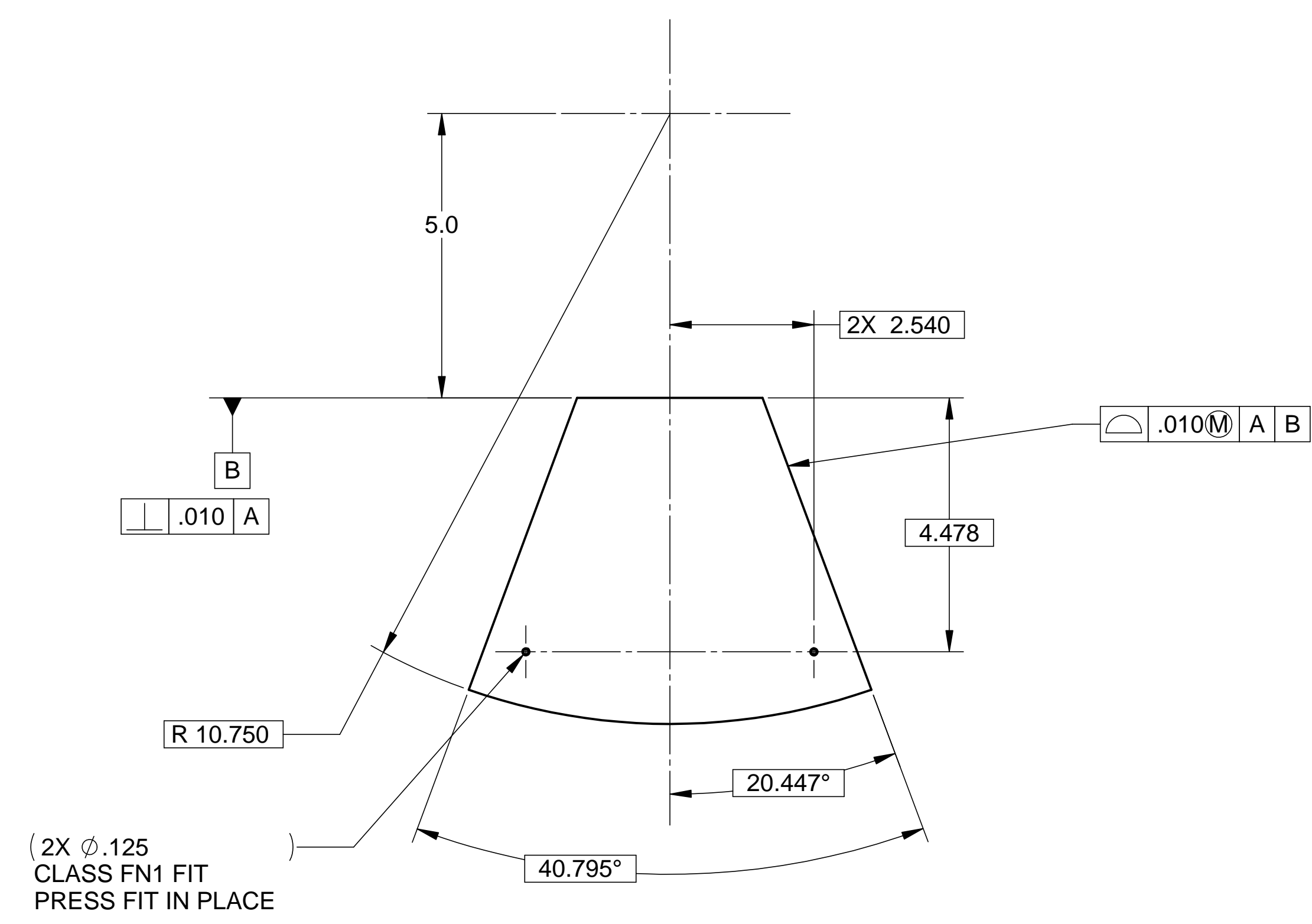

(2X ϕ .125
CLASS FN1 FIT
PRESS FIT IN PLACE)

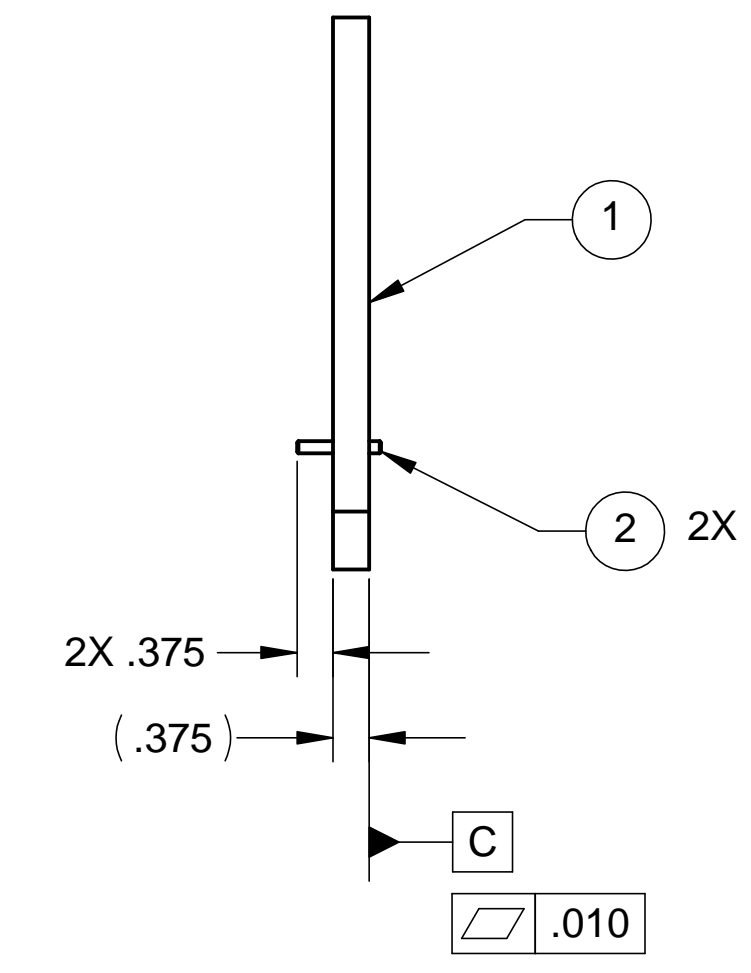

NOTES: UNLESS OTHERWISE SPECIFIED

- ALL DIMENSIONS IN INCHES
- DIMENSIONS AND TOLERANCING PER ASME Y14.5M-1994
- SURFACE TEXTURE PER ANSI/ASME B 46.1-1985
- REMOVE ALL BURRS AND BREAK SHARP EDGES TO A MAXIMUM OF .015
- ALL INSIDE CORNERS TO BE .015 RADIUS MAX
- COUNTERSINK 82 DEGREES ALL TAPPED HOLES TO MAJOR DIAMETER
- COUNTERSINK 82 DEGREES APPROXIMATELY .015 DEEP ALL DRILLED HOLES
- PART NUMBER (DRAWING NO. PLUS DASH NO. PLUS SERIAL NO.) TO BE CLEARLY MARKED ON THE PART ITSELF.
- NO SULFUR BASED CUTTING FLUIDS ALLOWED. APPROVED MACHINE LUBRICANT: ALUMICUT, MISTIC METAL MOVER, PRINCETON, IL.
- PART WEIGHS 1.0 Lbs.

ITEM NO.	QTY.	DESCRIPTION	MATERIAL
1	1	PLATE, 3/8" THK	6061-T6 ALUM
2	2	PIN, .125 DIA. X .875 LONG	McMASTER 98381A 474

PARTS LIST				TITLE	
UNLESS OTHERWISE SPECIFIED: DIMENSIONS ARE IN INCHES -TOLERANCES-		CAD GENERATED DRAWING, DO NOT MANUALLY UPDATE DO NOT SCALE DRAWING		HYTEC, INC	
DECIMALS .XX = +/- .03 .XXX = +/- .010	ANGULAR = +/- 30'	SURFACE FINISH = 250		HAM LEG ELEMENT STAGE 2 SPRING SPACER BLOCK	
FINISH	SIGNATURE	DATE	DWG. NO. D972966		
DESIGNED	W. K. MILLER	4/1/98	SIZE D	SHEET NO. 1 of 1	
DRAWN	W. K. MILLER	4/1/98	PART NO. D972966-1		
CHECKED	HARRY SALAZAR	-	REVISION		
ENGR.	T. THOMPSON	-	SCALE 1/2		
APPROVED	T. THOMPSON	-	REVISION		

8 7 6 5 4 3 2 1

A

A