

**NOTES:**  
 1. PROVIDE (9) BENCHMARKS INDICATED BY THIS SYMBOL AT LOCATIONS SHOWN.  
 2. ALL BENCH MARKS TO BE CENTERED ON CENTERLINE OF BEAM AXIS.

- LEGEND**
- [A] 3 WAY ANCHOR
  - [SG] SUPPORT/GUIDE (AXIALLY FLEXIBLE)
  - [S] VALVE SUPPORT
  - [ ] GATE VALVE ION PUMP LOCATION
  - [VS] VALVE SEAL SIDE

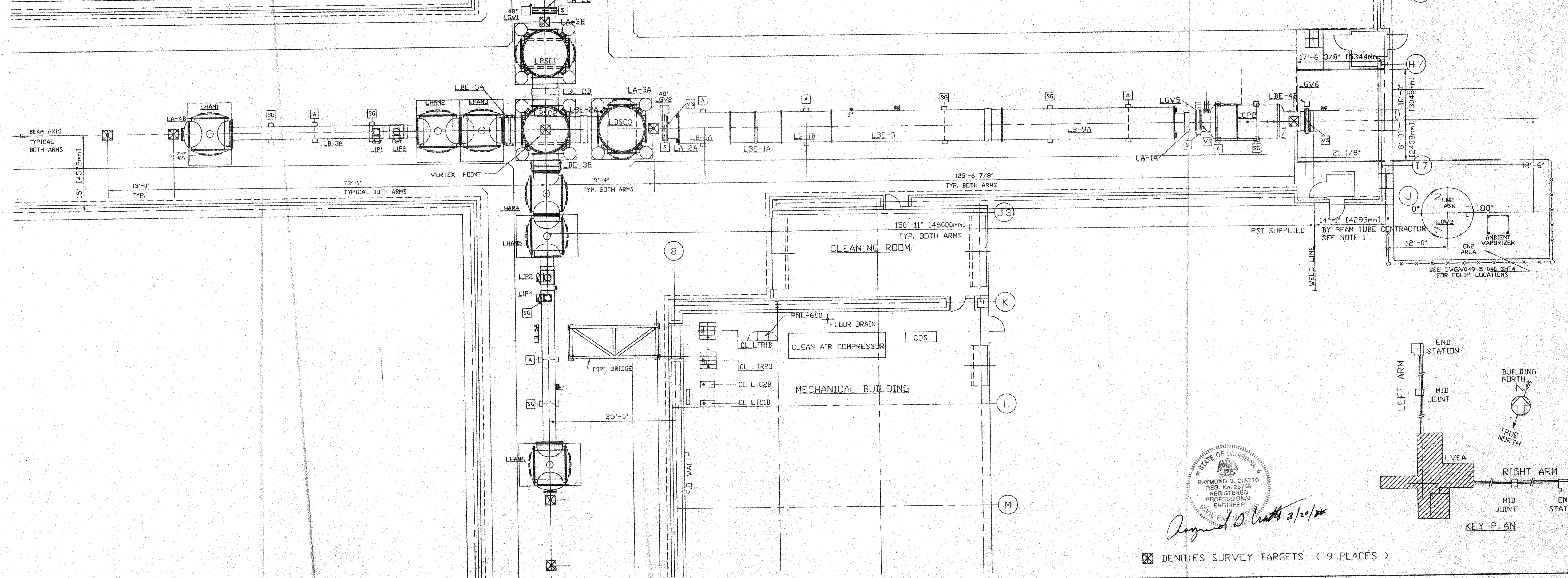

STATE OF LOUISIANA  
 RAYMOND D. CIATTO  
 REG. NO. 28750  
 REGISTERED PROFESSIONAL ENGINEER  
 CIVIL ENGINEERING  
 3/20/98

☒ DENOTES SURVEY TARGETS ( 9 PLACES )

<b>PROPRIETARY AND CONFIDENTIAL</b>			
THIS DOCUMENT CONTAINS PROPRIETARY INFORMATION BELONGING TO PROCESS SYSTEMS INTERNATIONAL, INC. OR ITS AFFILIATED COMPANIES AND SHALL BE USED ONLY FOR THE PURPOSE FOR WHICH IT WAS SUPPLIED. IT SHALL NOT BE COPIED, REPRODUCED OR OTHERWISE USED, NOR SHALL SUCH INFORMATION BE FURNISHED IN WHOLE OR IN PART TO OTHERS EXCEPT IN ACCORDANCE WITH THE TERMS OF ANY AGREEMENT UNDER WHICH IT WAS SUPPLIED OR WITH THE PRIOR WRITTEN CONSENT OF PROCESS SYSTEMS INTERNATIONAL, INC. AND SHALL BE RETURNED UPON REQUEST.			
DWG. NO.	DESCRIPTION	REFERENCE DRAWINGS	DESCRIPTION
V049-5-040	PIPING ARRANGEMENT PLAN - CORNER STATION		
V049-2-025	SPEC. FOR INSTALLATION & COMMISSIONING		
V049-0-001	P & ID LIGO VACUUM EQUIPMENT		
LA-A-101	PARSONS ARCHITECTURAL CORNER STATION LVEA FLOOR PLAN		
1101100	LIGO VACUUM EQUIPMENT CORNER STATION		

UNLESS OTHERWISE SPECIFIED DIMENSIONS ARE IN INCHES		TOLERANCES	
FRACTIONAL ±		ANGULAR ±	
DECIMAL ±		BEND ±	
THREE PLACE DECIMAL ±		FINISHED SURFACE RMS	
BREAK CORNERS IN		REMOVE ALL BURRS	
DD NOT SCALE THIS DRAWING	0	ISSUED FOR CONSTRUCTION	
USED ON:	REV	DESCRIPTION	
NEXT ASS'Y:		ISSUE DESCRIPTION	
		CHKD	DRWN
		REC	DATE
		DED#	

**PROCESS SYSTEMS INTERNATIONAL INC.**  
 20 WALKUP DR. WESTBOROUGH, MASSACHUSETTS 01581 USA

**SURVEY BENCHMARKS**  
 PLAN AREA 600  
 CORNER STATION LOUISIANA  
 LIGO VACUUM EQUIPMENT

CAD FILE: V0495053  
 SIZE: D  
 DWG. NO.: V049-5-053  
 SHEET: 1 OF 1

SCALE: 1"=10'

REV 0