

1. CLEAR ANODIZE PER MIL-A-8625

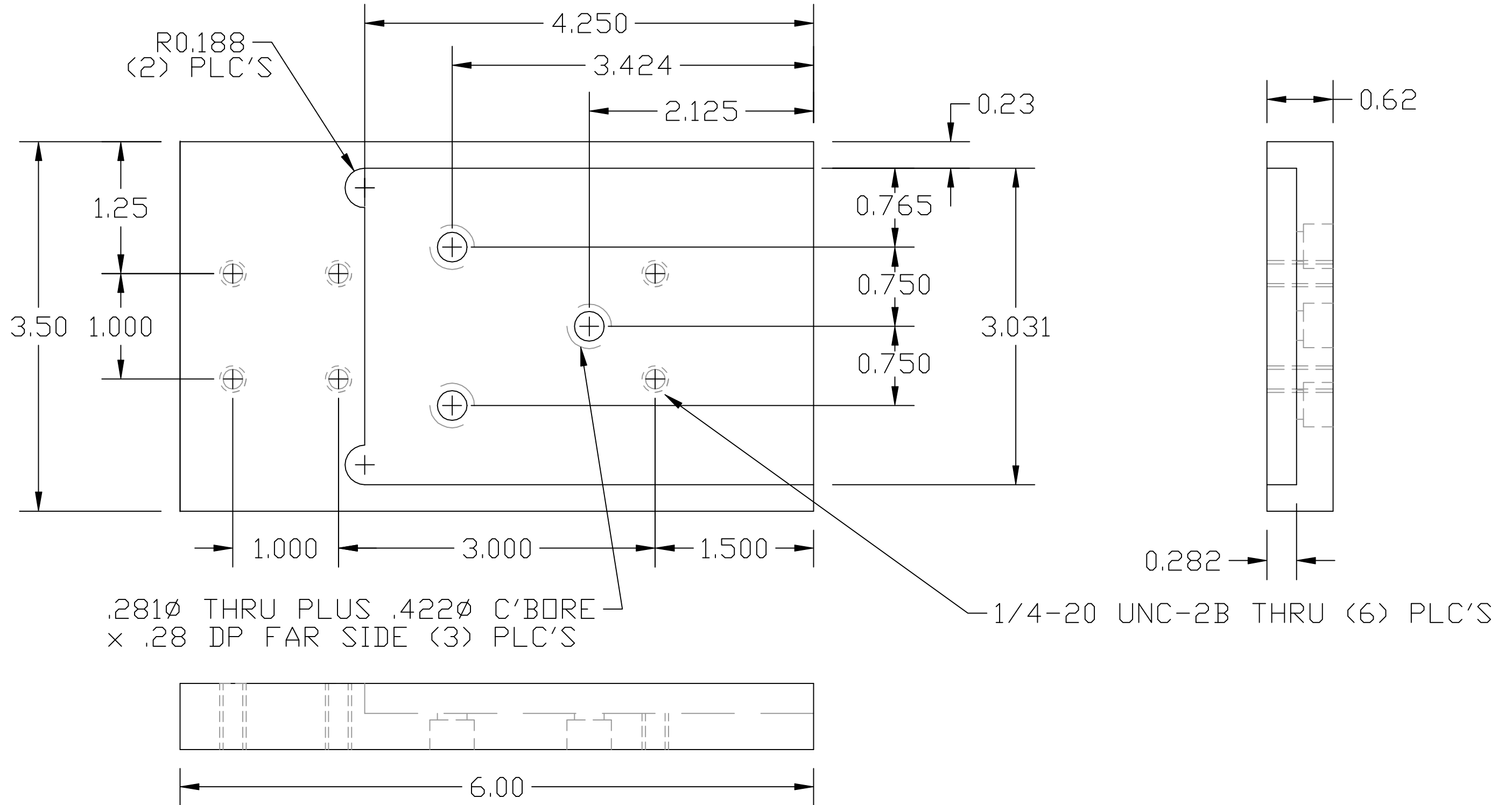

.281Ø THRU PLUS .422Ø C'BORE
 x .28 DP FAR SIDE (3) PLC'S

1/4-20 UNC-2B THRU (6) PLC'S

		UNLESS OTHERWISE SPECIFIED DIMENSIONS ARE IN INCHES														MIT CALIFORNIA INSTITUTE OF TECHNOLOGY MASSACHUSETTS INSTITUTE OF TECHNOLOGY					
		TOLERANCES: FRACTIONAL ±1/16(.16) ANGULAR ± 1° TWO PLACE DECIMAL ±.01(.025) THREE PLACE DECIMAL ±.005(.013)		FINISHED SURFACE RMS 63 BREAK CORNERS IN: OUT: .02 REMOVE ALL BURRS														VERTICAL PLATE PLX MOUNT ASC INITIAL ALIGNMENT			
		MATERIAL:	HEAT TREAT:	FINISH:													A MASON 1/10/00				
		6061-T6 ALUM.	-	SEE NOTE 1													K.MASON 12/10/98				
DWG. NO.		DESCRIPTION		USED ON: -		NEXT ASS'Y: -		A INITIAL RELEASE												CAD FILE	
REFERENCE DRAWINGS								00 PRE-RELEASE												D980473-Adwg	
								REV DESCRIPTION												SIZE DWG. NO.	
								DCC SYS DET CDS VE CC BT CHECK DRWN DATE												B D980473-A-D	
								ISSUE DESCRIPTION												SCALE	
																				FULL	
																				SHEET	
																				1 OF 1	