

1. CLEAR ANODIZE PER MIL-A-8625

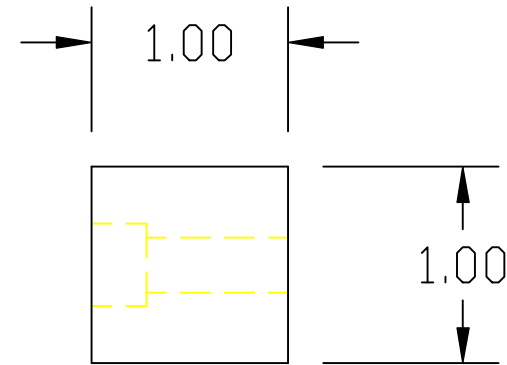
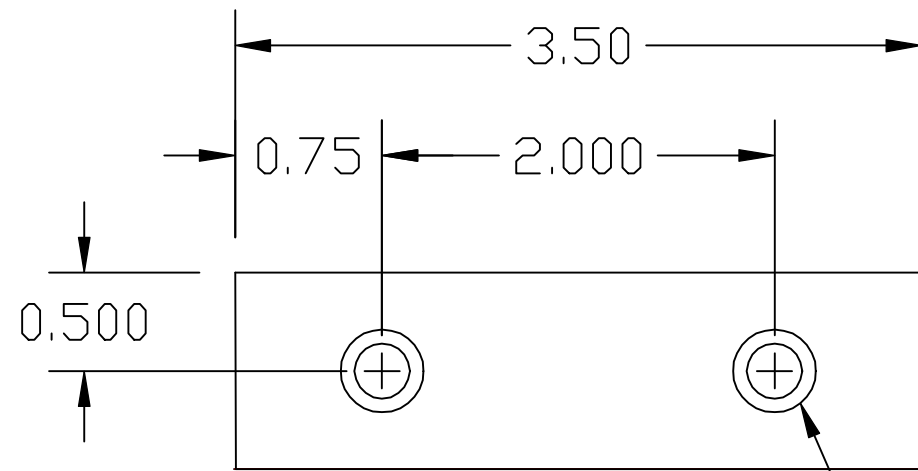

.281 ϕ THRU PLUS .422 ϕ x .28 DP C'BORE (2) PLC'S

		<p>UNLESS OTHERWISE SPECIFIED DIMENSIONS ARE IN INCHES</p> <p>TOLERANCES: FRACTIONAL $\pm 1/16(.16)$ FINISHED SURFACE RMS 63 ANGULAR $\pm 1^\circ$ BREAK CORNERS IN: OUT: .02 TWO PLACE DECIMAL $\pm .01(.025)$ REMOVE ALL BURRS THREE PLACE DECIMAL $\pm .005(.013)$</p>													<p>CALIFORNIA INSTITUTE OF TECHNOLOGY MASSACHUSETTS INSTITUTE OF TECHNOLOGY</p>					
		MATERIAL: 6061-T6 ALUM.	HEAT TREAT: -	FINISH: SEE NOTE 1											<p>MOUNTING FOOT PLX MOUNT ASC INITIAL ALIGNMENT</p>					
DWG. NO.	DESCRIPTION				REV	DESCRIPTION	DCC	SYS	DET	CDS	VE	CC	BT	CHECK	DRWN	DATE	CAD FILE	SIZE	DWG. NO.	
6	REFERENCE DRAWINGS	USED ON: - NEXT ASS'Y: -			A	INITIAL RELEASE											D980474-Adwg	B	D980474-A-D	
																	SCALE	FULL	SHEET	1 OF 1