

7 6 5 4 3 2 1

NOTES: (UNLESS OTHERWISE SPECIFIED)

~~Liquid contaminants/Machining Lubricants~~
 Liquids containing hydrocarbons or other contaminants, other than the machining fluids specified herein, shall not be allowed to come into contact with suspension material at any time. All machining fluids shall be water soluble and free of sulfur, chlorine and silicone; such as Cincinnati Milacron's Cintech 410 (stainless steel).

~~Identification Serial Number~~

A serial number shall be etched, or scribed on the part see note drawing note.

~~Serial Number Format~~

The Serial number shall be of the format: D99xxxx-x-001

Example: D990021-A-001
 The drawing number, The revision number, The sequential part number

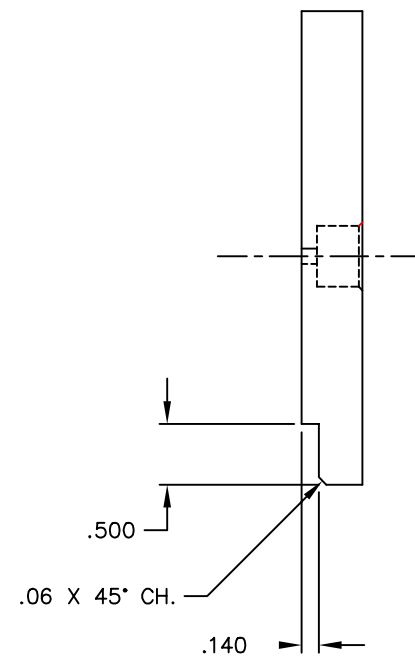
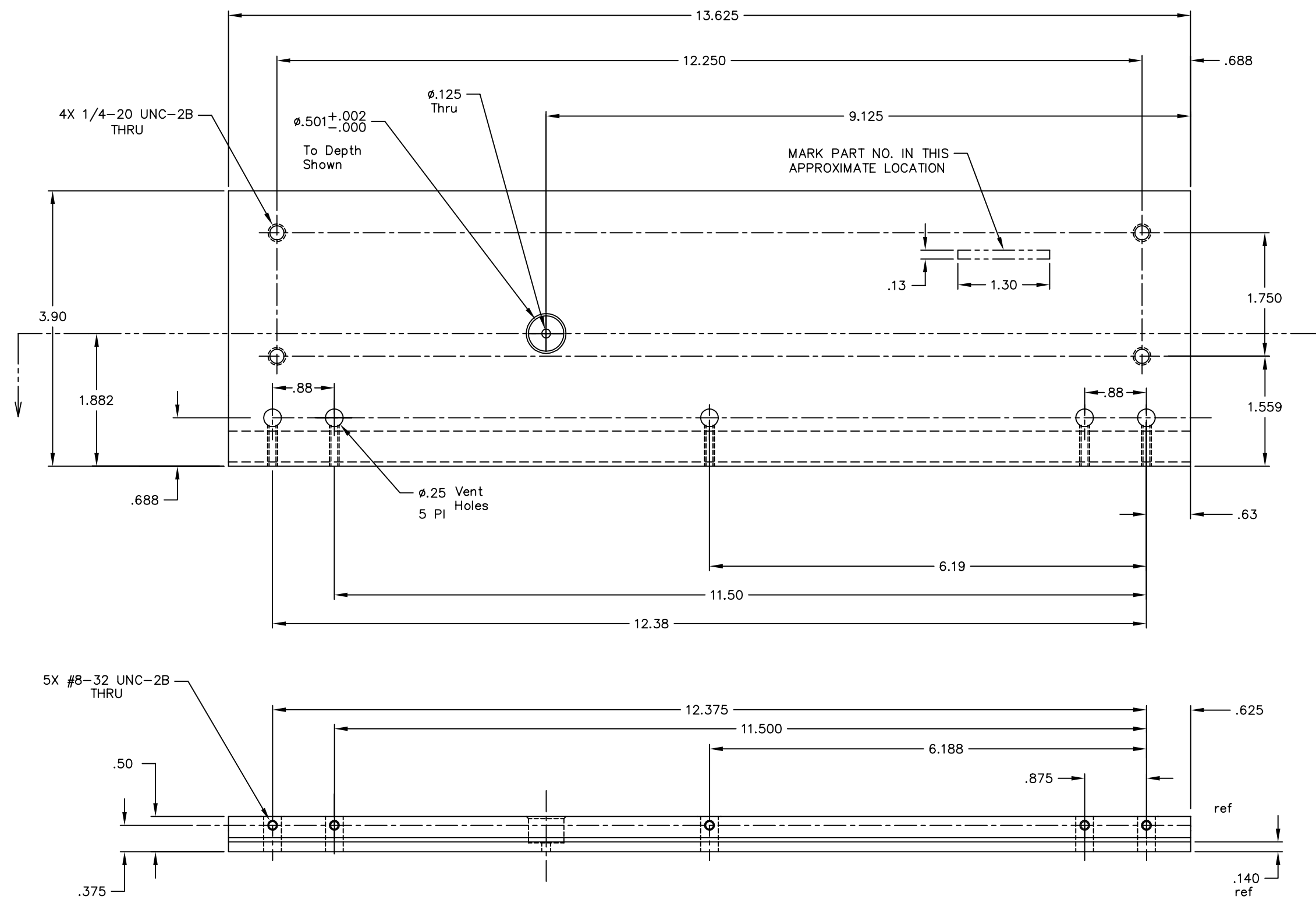
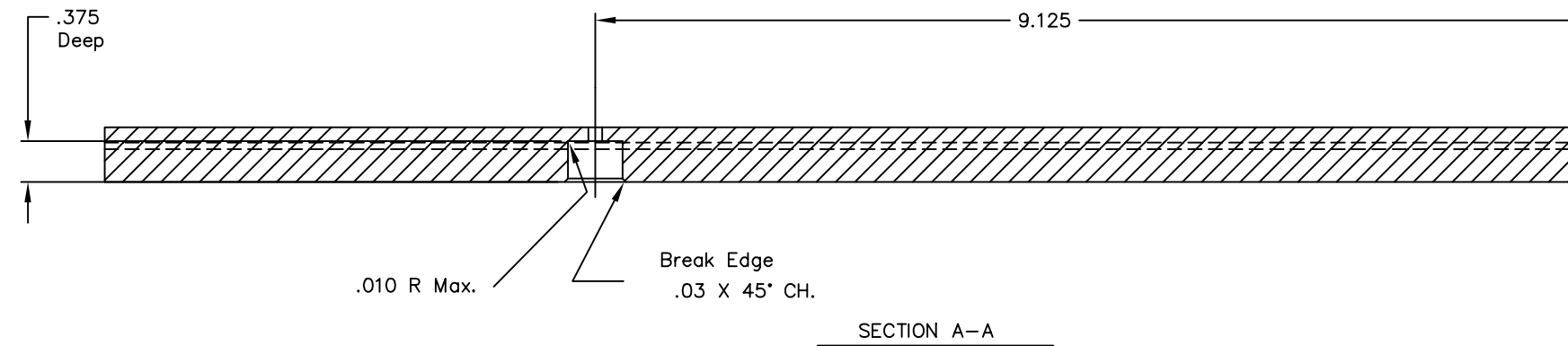

REF. MAKE 1 PER ASSEMBLY

REF	QTY	PART or DRWG No.	DESCRIPTION	MATERIAL
PARTS and MATERIAL LIST				
LIGO CALIFORNIA INSTITUTE OF TECHNOLOGY MASSACHUSETTS INSTITUTE OF TECHNOLOGY				
B			Bored Hole was .75" Dia	KENM 8-4-99
B			FDR FABRICATION	KENM 6-4-99
00			PRE-RELEASE	CHAPUT 11-2-98
REV		DESCRIPTION	DCN NUMBER	APPR'D CHECK DRWN DATE
ISSUE DESCRIPTION			SCALE	SHEET
			1 : 1	1 OF 1

UNLESS OTHERWISE SPECIFIED
 DIMENSIONS ARE IN INCHES

TOLERANCES:
 FRACTIONAL ± 1/16
 ANGULAR ± .25°
 ANGULAR MACH ± BEND ±
 TWO PLACE DECIMAL ± .01

THREE PLACE DECIMAL ± .005
 FINISHED SURFACE RMS 63
 BREAK CORNERS IN .015 OUT .015
 REMOVE ALL BURRS

MATERIAL: ALUMINUM TOOLING PLATE
 HEAT TREAT: /
 FINISH: /

USED ON: XXX
 NEXT ASS'Y: XXX

7 6 5 4 3 2 1