

NOTES: (UNLESS OTHERWISE SPECIFIED)

~~Liquid contaminants/Machining Lubricants~~
 Liquids containing hydrocarbons or other contaminants, other than the machining fluids specified herein, shall not be allowed to come into contact with suspension material at any time. All machining fluids shall be water soluble and free of sulfur, chlorine and silicone; such as Cincinnati Milacron's Cuttech 410 (stainless steel).

Identification Serial Number

A serial number shall be etched, or scribed on the part see note drawing note.

Serial Number Format

The Serial number shall be of the format: D99xxxx-x-001

Example: D990021-A-001

The drawing number, The revision number, The sequential part number

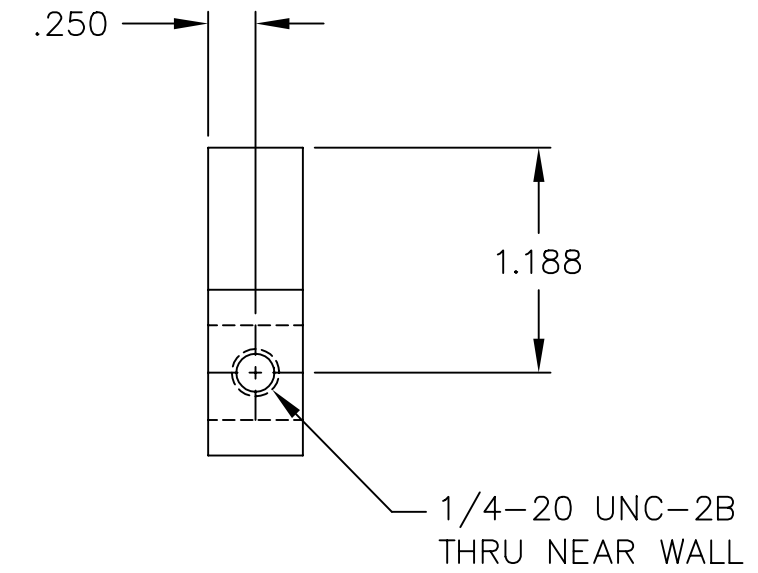
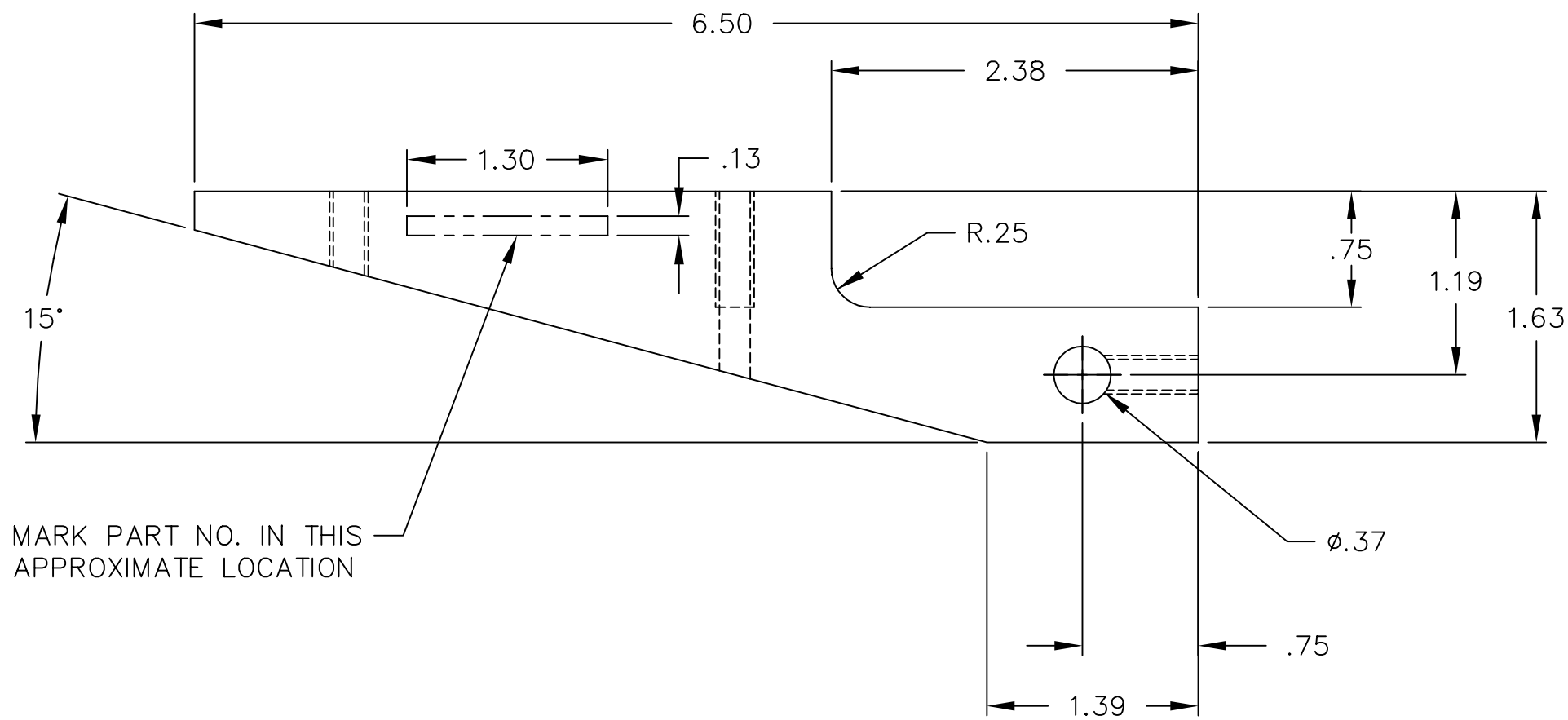
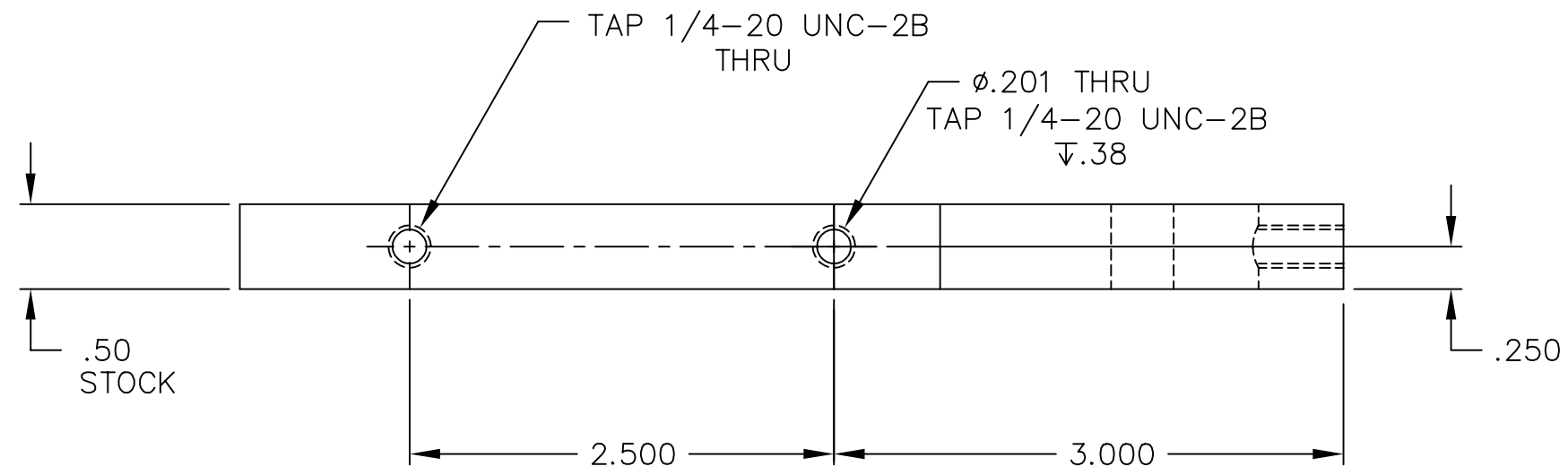

MARK PART NO. IN THIS APPROXIMATE LOCATION

ref. make 2 per assembly

REF	QTY	PART or DRWG No.	DESCRIPTION					MATERIAL
PARTS and MATERIAL LIST								
LIGO CALIFORNIA INSTITUTE OF TECHNOLOGY MASSACHUSETTS INSTITUTE OF TECHNOLOGY								
GUSSET, FRONT, FRONT SUPPORT								
XXX	XXX					kenm	6-8-99	
DWG. NO.	DESCRIPTION	MATERIAL:	HEAT TREAT:	FINISH:		CHAPUT	11-3-98	
6	REFERENCE DRAWINGS	6061 T-6 ALUM.	/	/				
5	USED ON: XXX		NEXT ASS'Y: XXX					
4								
3								
2								
1								
SCALE							1 : 1	SHEET 1 OF 1

UNLESS OTHERWISE SPECIFIED
 DIMENSIONS ARE IN FEET (cm)
 TOLERANCES:
 FRACTIONAL ± 1/16
 ANGULAR ± .25°
 ANGULARMACH ± BEND ±
 TWO PLACE DECIMAL ± .01
 THREE PLACE DECIMAL ± .005
 FINISHED SURFACE RMS 63
 BREAK CORNERS IN: .015 OUT: .015
 REMOVE ALL BURRS