

6 5 4 3 2 1

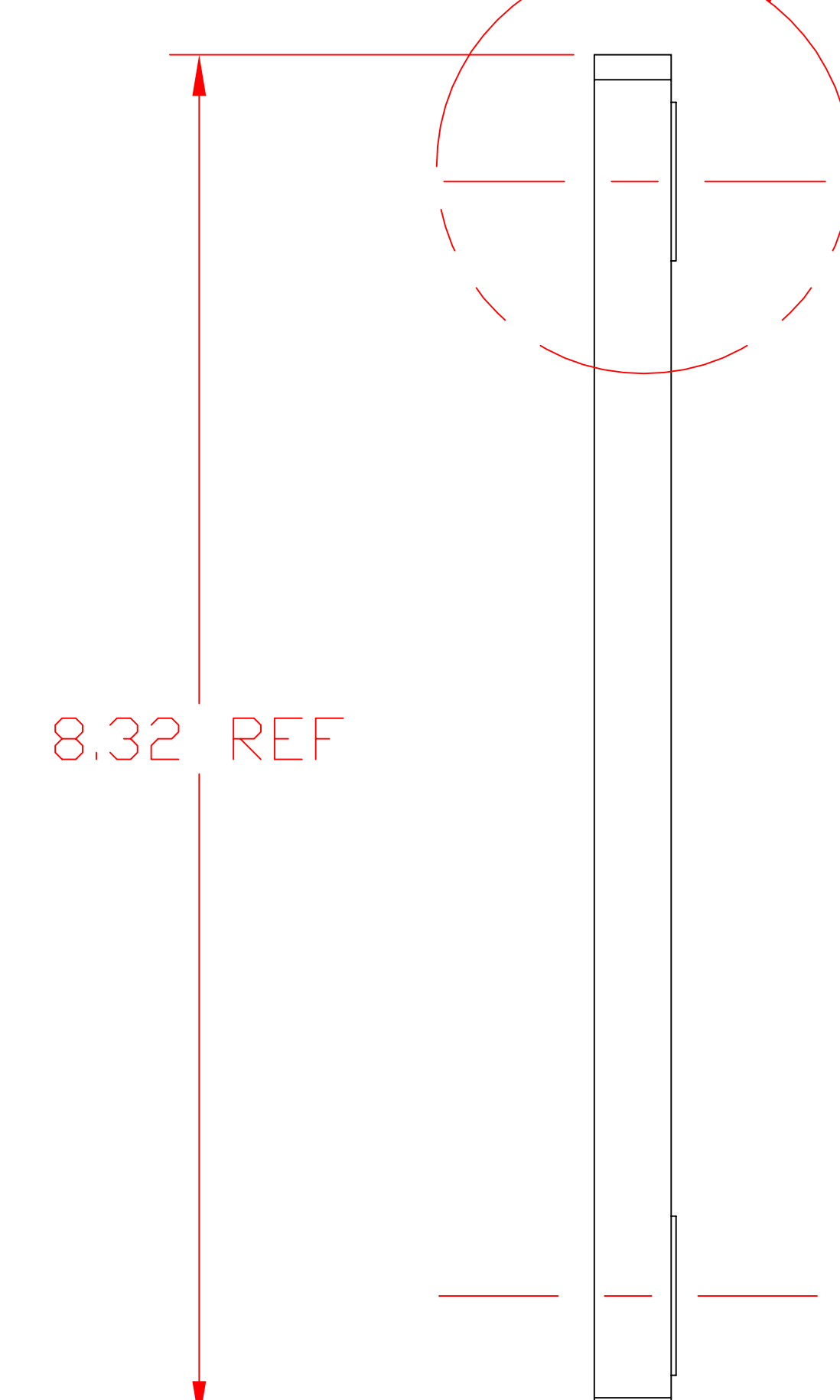

.031 DEEP VENT RELIEF REF

FAR SIDE

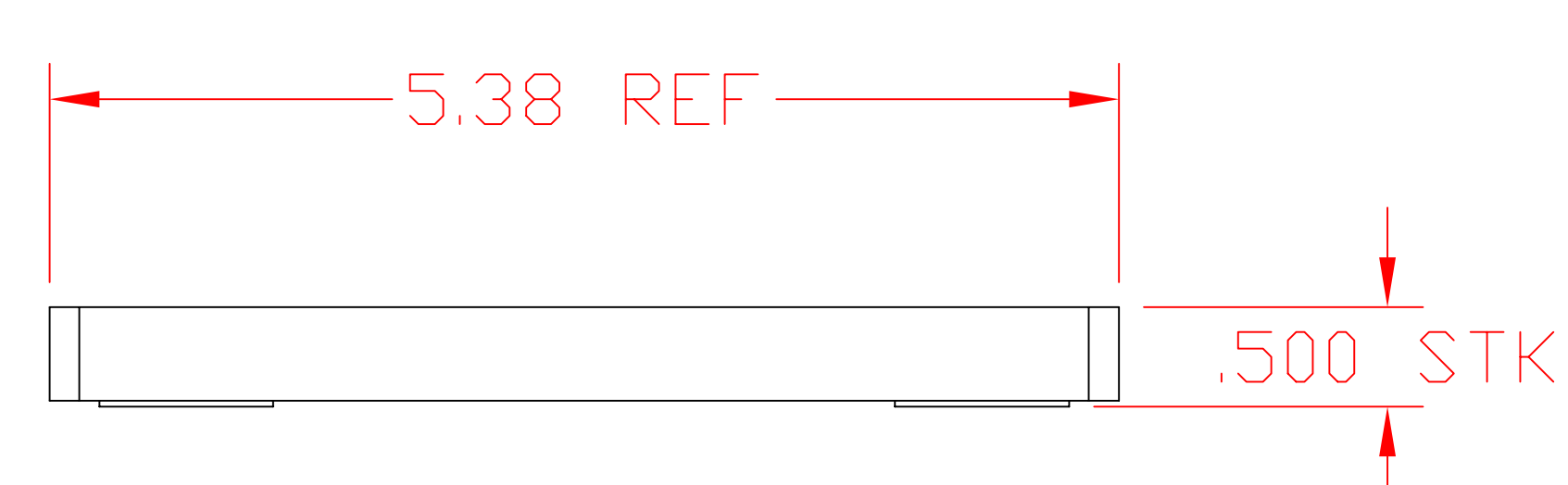
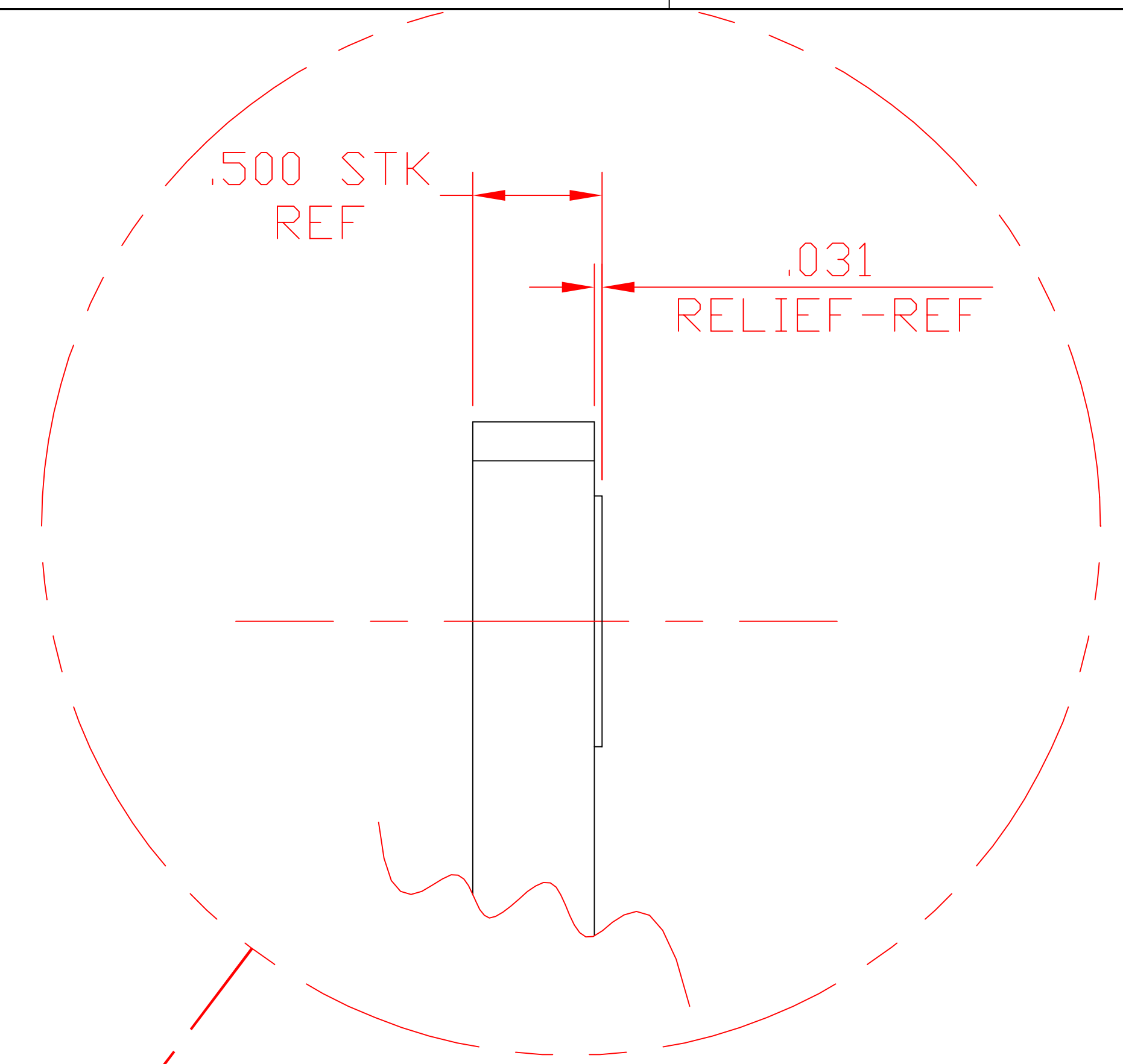
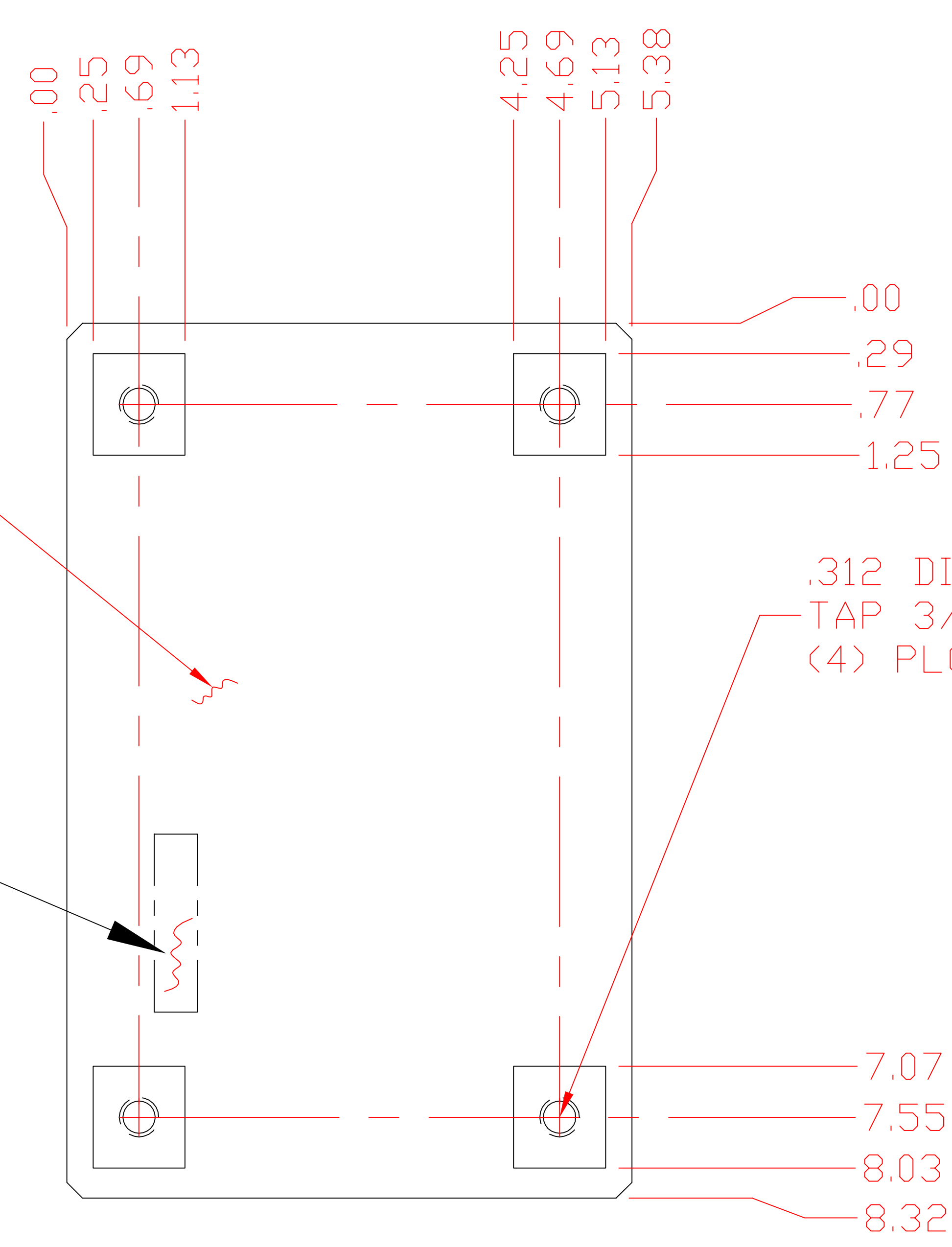

NOTES: (UNLESS OTHERWISE SPECIFIED)

- CUTTING FLUIDS TO BE WATER SOLUBLE AND FREE OF SULFUR, CHLORINE, & SILICONE.
- STEEL STAMP OR ENGRAVE THE DRAWING PART NUMBER ON NOTED FACE OF PART FOLLOWED BY "S/N", THEN A THREE DIGIT SERIAL NUMBER. SERIAL NUMBERS TO START AT 001 FOR FIRST PART AND PROCEED IN A CONSECUTIVE MANNER TO A MAXIMUM OF 999, FOR EACH SUCCEEDING PART PRODUCED. USE 0.13 HIGH CHARACTERS. EXAMPLE: D990038-A S/N 001

		UNLESS OTHERWISE SPECIFIED DIMENSIONS ARE IN INCHES							LIGO CALIFORNIA INSTITUTE OF TECHNOLOGY MASSACHUSETTS INSTITUTE OF TECHNOLOGY						
		TOLERANCES: FRACTIONAL ± 1/64 ANGULAR ± 1/2° ANGULARMACH ± BEND ± TWO PLACE DECIMAL ±.02			THREE PLACE DECIMAL ±.010 FINISHED SURFACE RMS BREAK CORNERS IN: OUT: .005-.010 REMOVE ALL BURRS					CAVITY BEAM DUMP MOUNTING BRACKET BACKPLATE 1					
		MATERIAL: 6061-T6 ALUMINUM	HEAT TREAT:	FINISH:	B RELEASE E990200 Conley 5-6-99					CAD FILE D990151-B.dwg	SIZE DWG. NO. B D990151-B				
DWG. NO.		DESCRIPTION		USED ON:	NEXT ASS'Y: D990143	A RELEASE E990108 Conley 3-23-99	REV	DESCRIPTION	DCN	APPR'D	CHECK	DRWN	DATE	SCALE NTS	SHEET 1 OF 1
REFERENCE DRAWINGS															

6 5 4 3 2 1