

# Methods of Adjustment used in the Controls Prototype Mode Cleaner Suspension at Caltech

1. VERTICAL
2. PITCH, ROLL and YAW
3. LONG, TRANSVERSE and YAW

Calum Torrie, CALTECH  
Mike Perreur-Lloyd UNI of GLASGOW

**ALUK GLASGOW MEETING AUGUST 2003**

# MODE CLEANER SUSPENSION

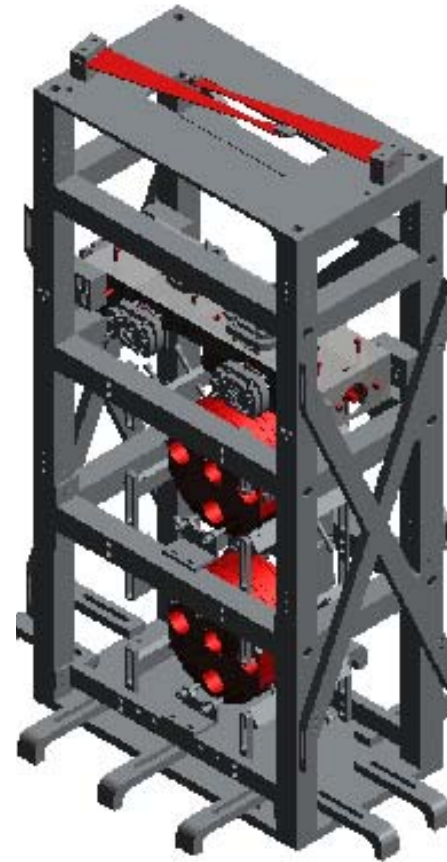
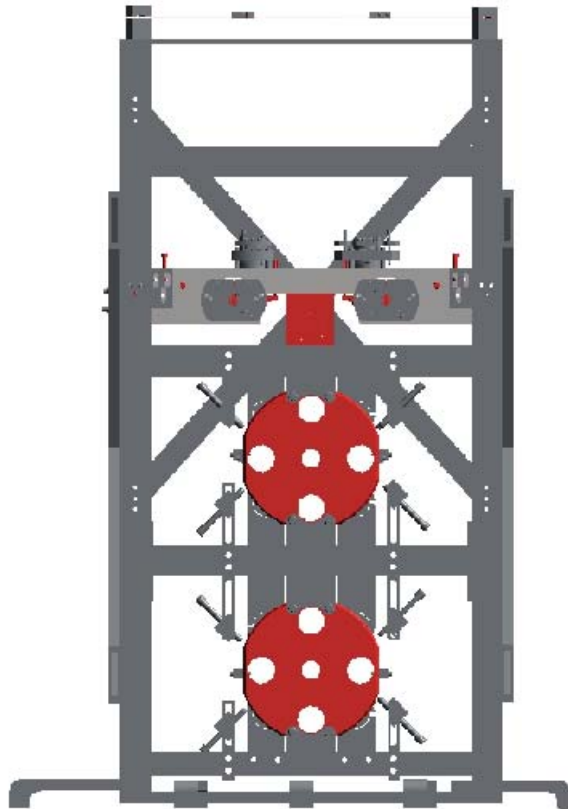

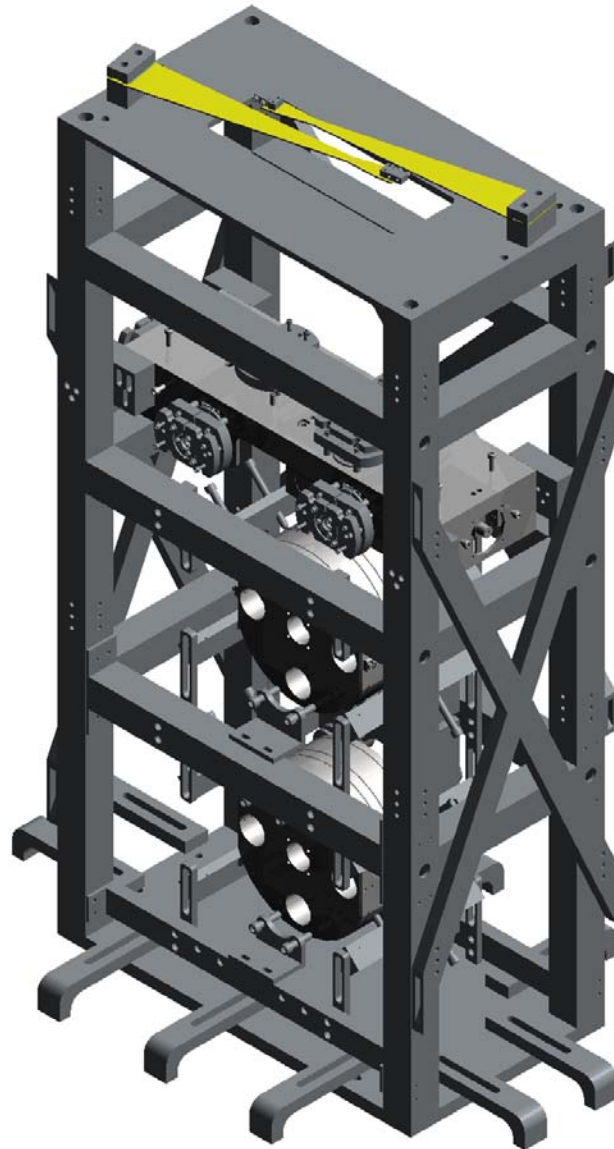

LIGO-G030388-02

ALUKGLA0034aAUG03

3

UPPER CANTILEVER BLADES

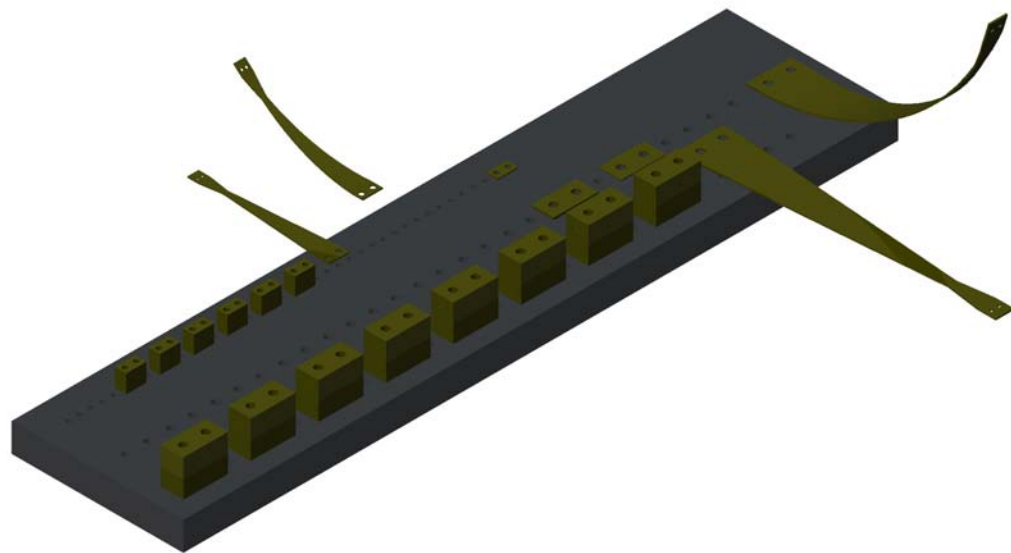

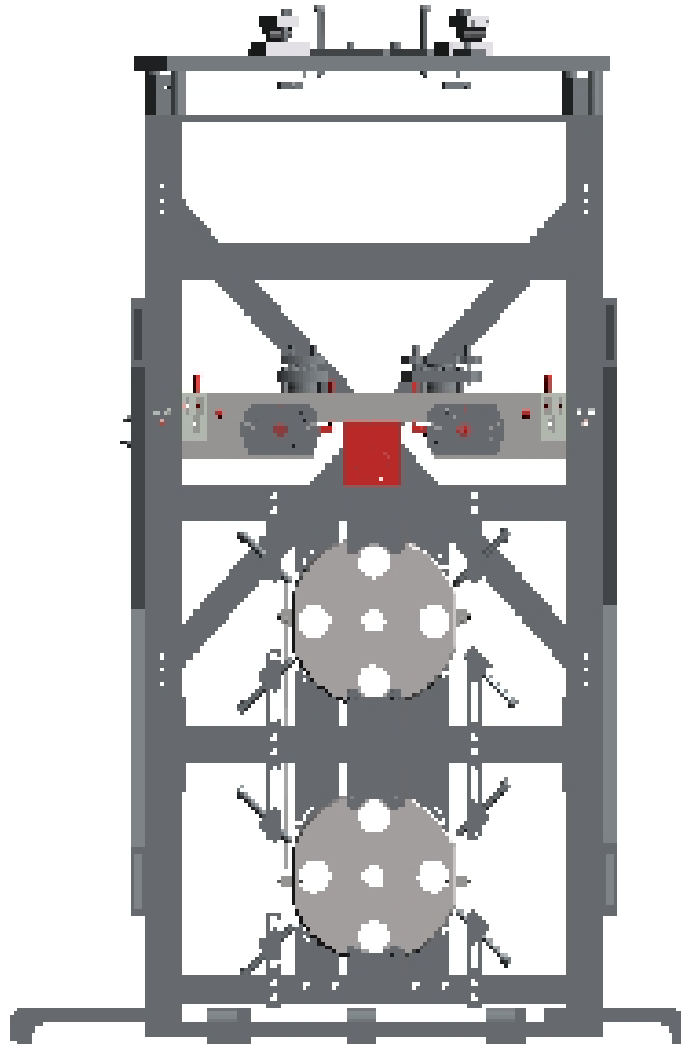

LIGO-G030388-02

ALUKGLA0034aAUG03

5  
UPPER MASS, 3kg

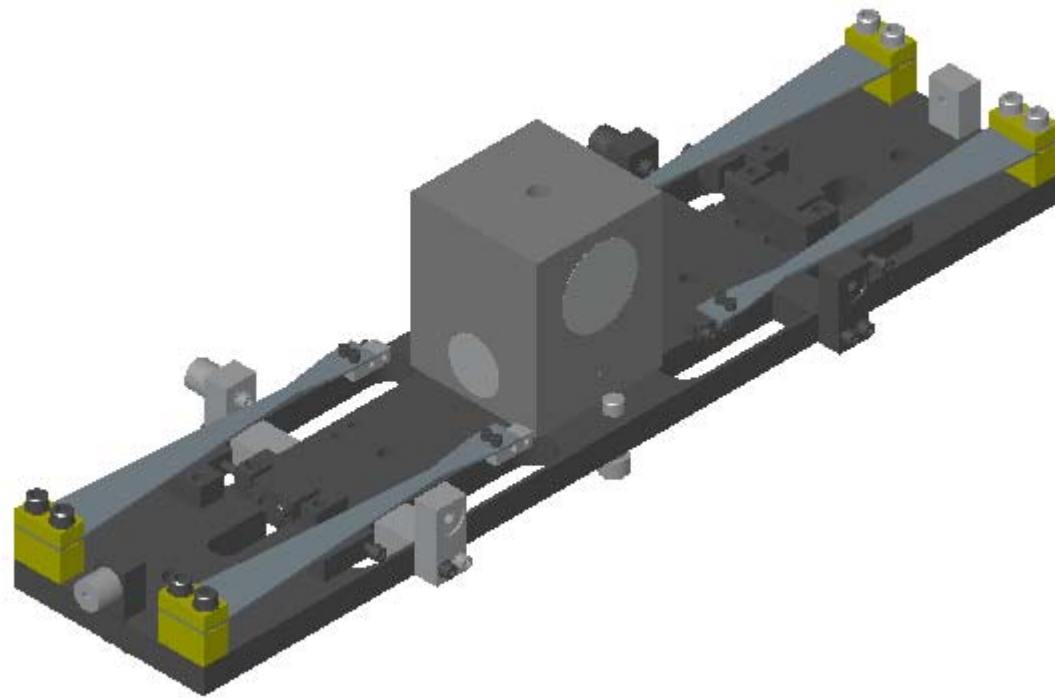

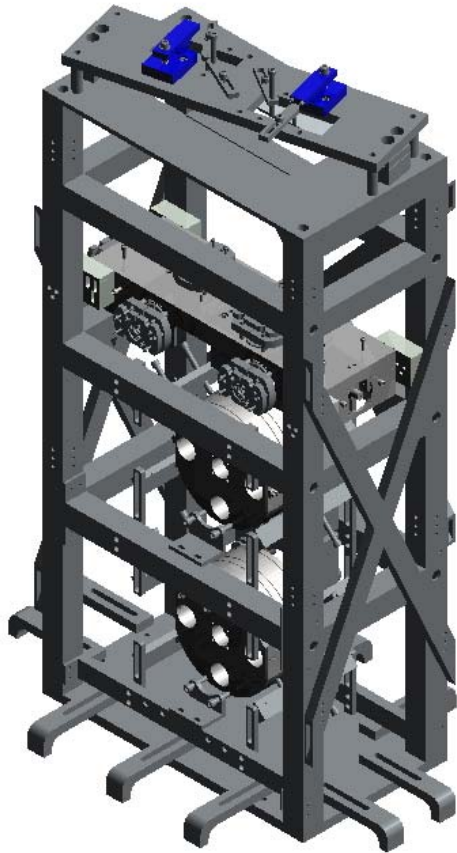

LIGO-G030388-02

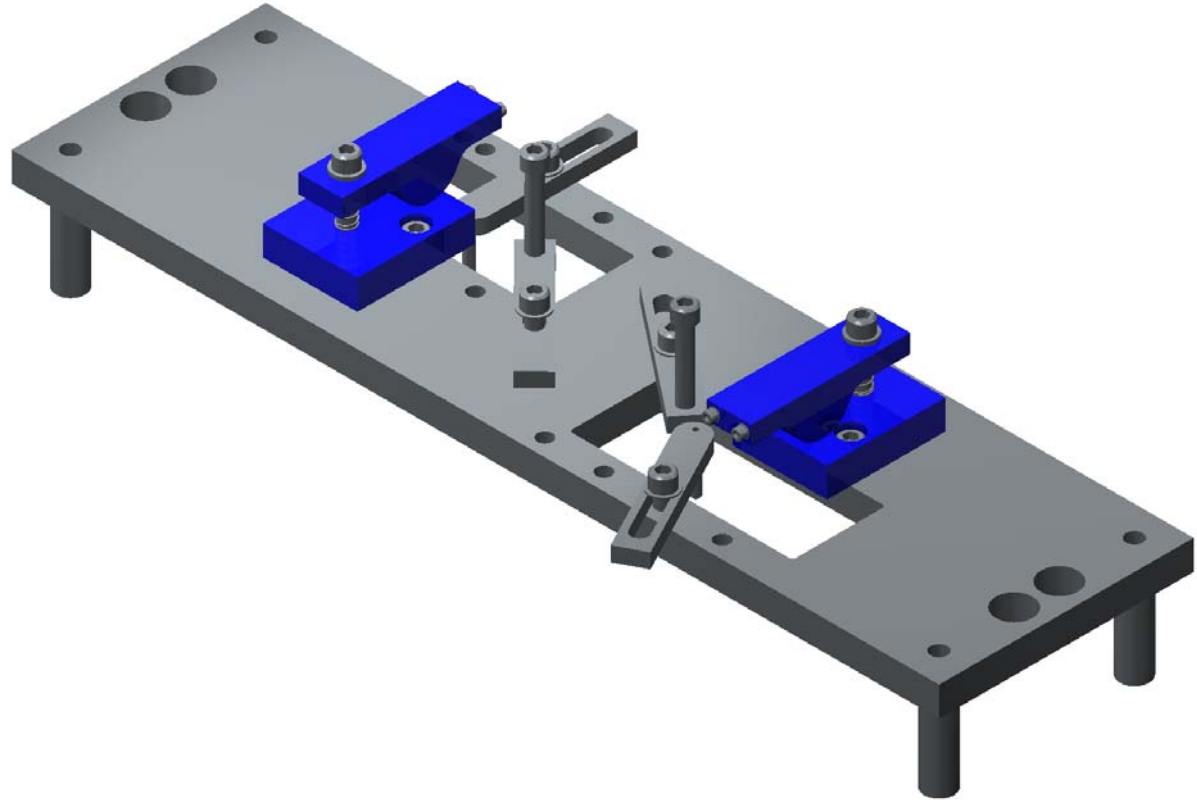

ALUKGLA0034aAUG03

UPPER WIRE WINCH (SHORTEN ONLY)

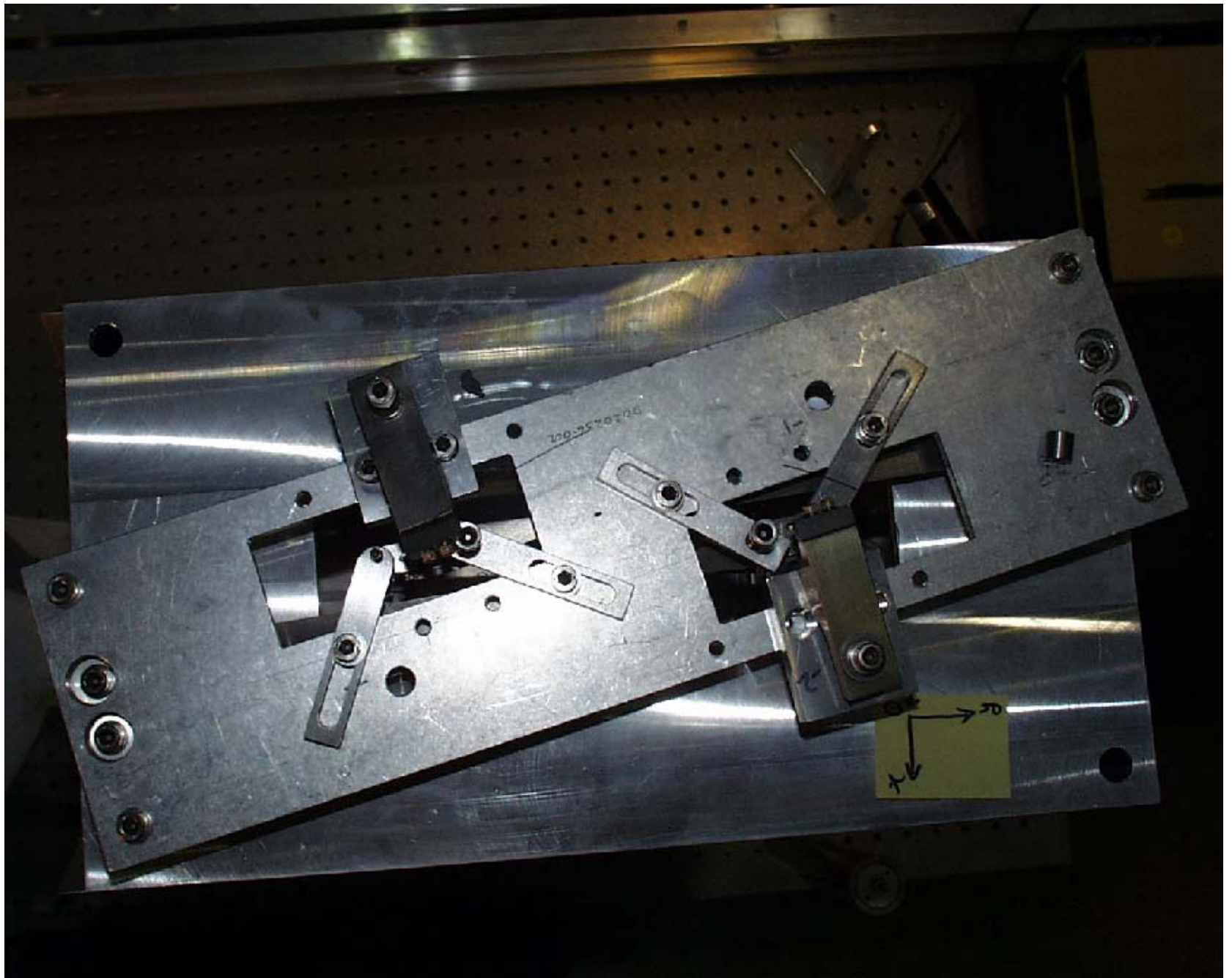



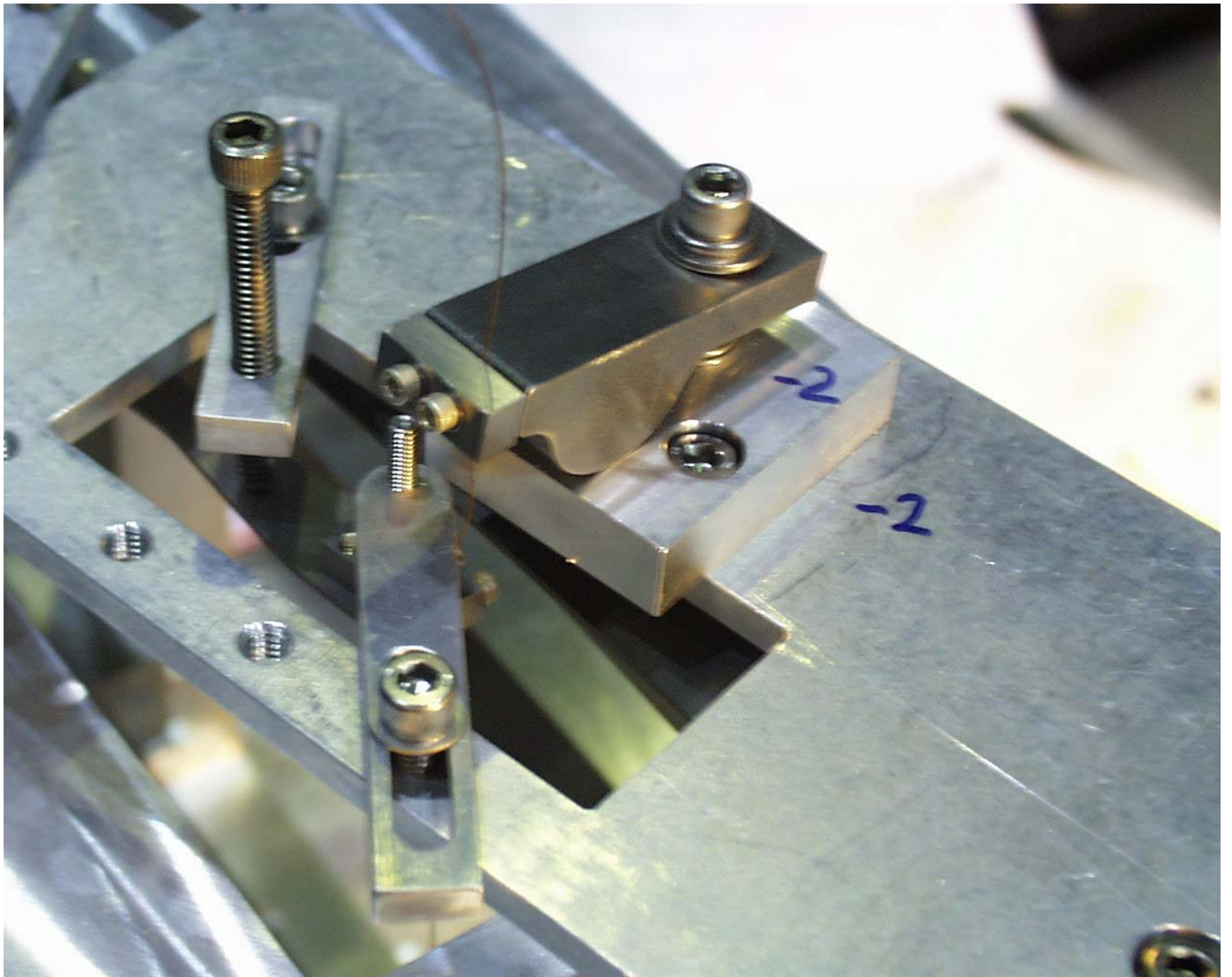

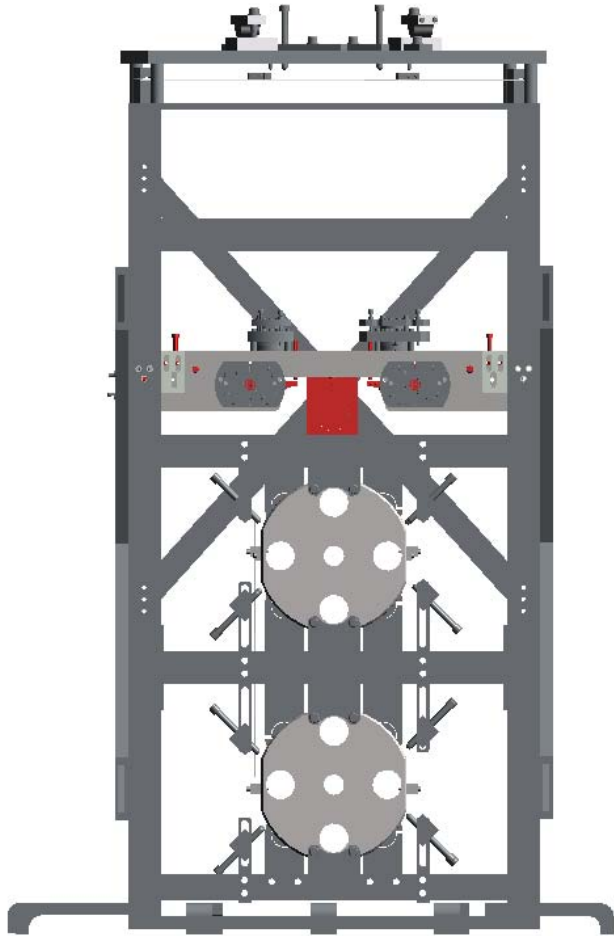

LIGO-G030388-02

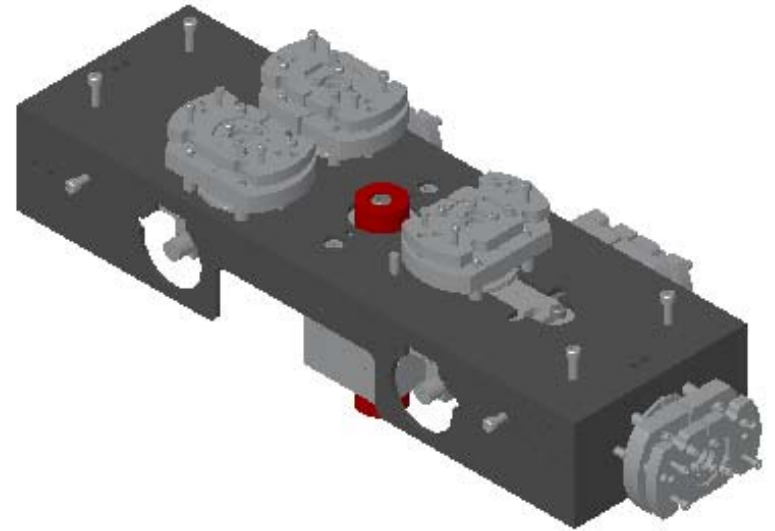

ALUKGLA0034aAUG03

10

**FIXED MASS ON UPPER MASS**

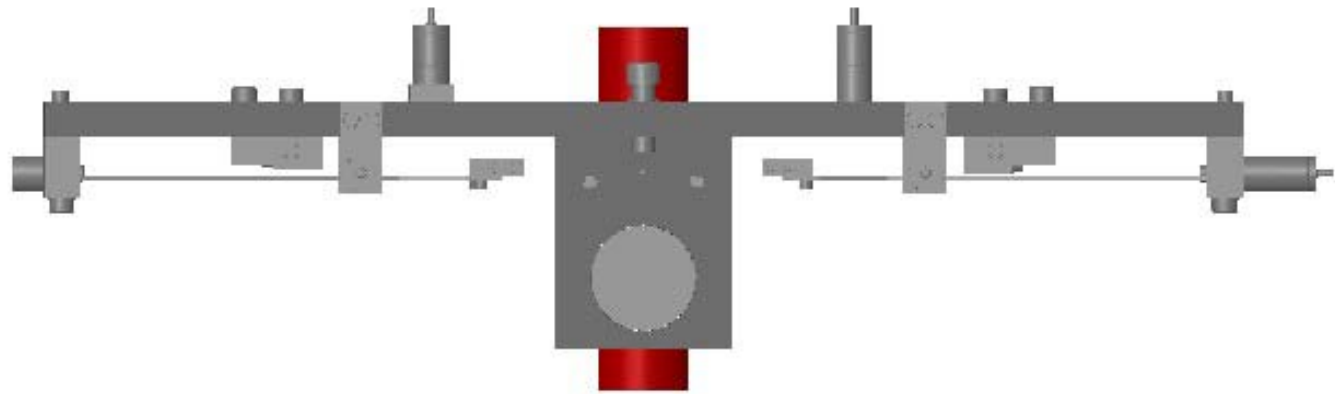

LIGO-G030388-02

**FIXED MASS ON UPPER MASS**

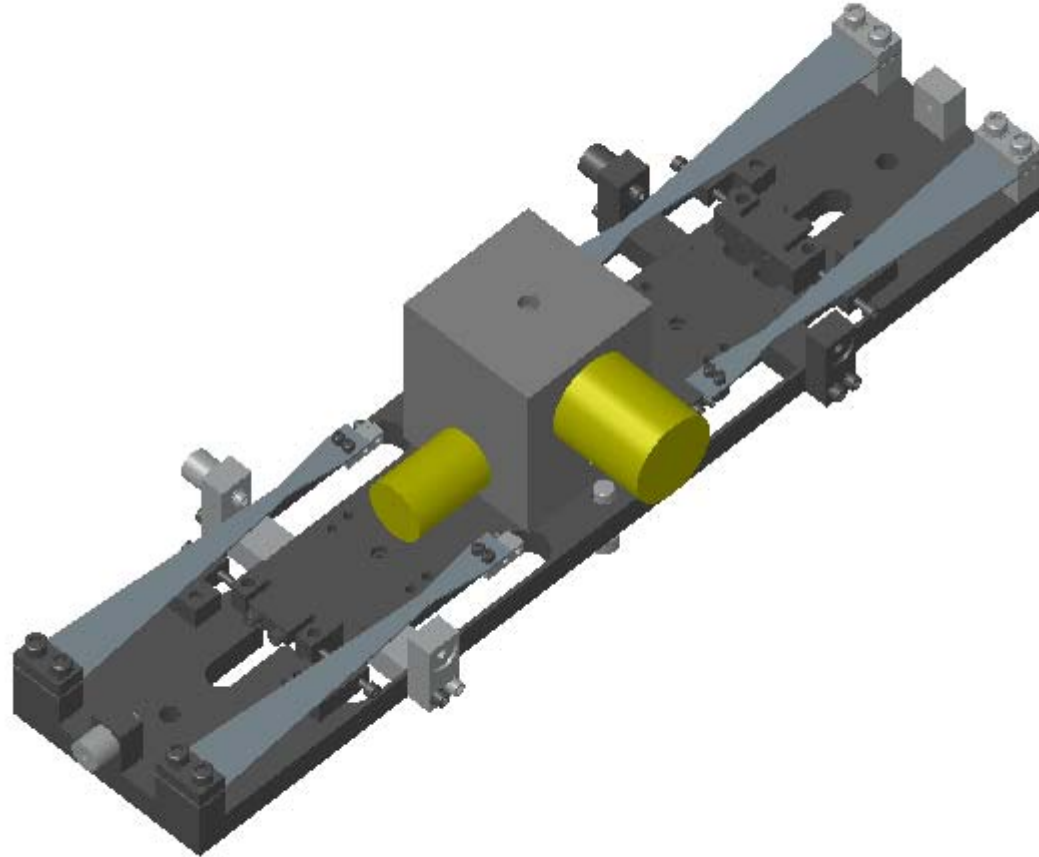

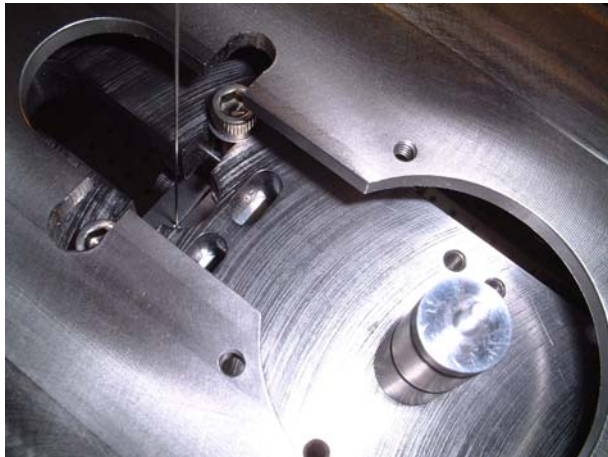
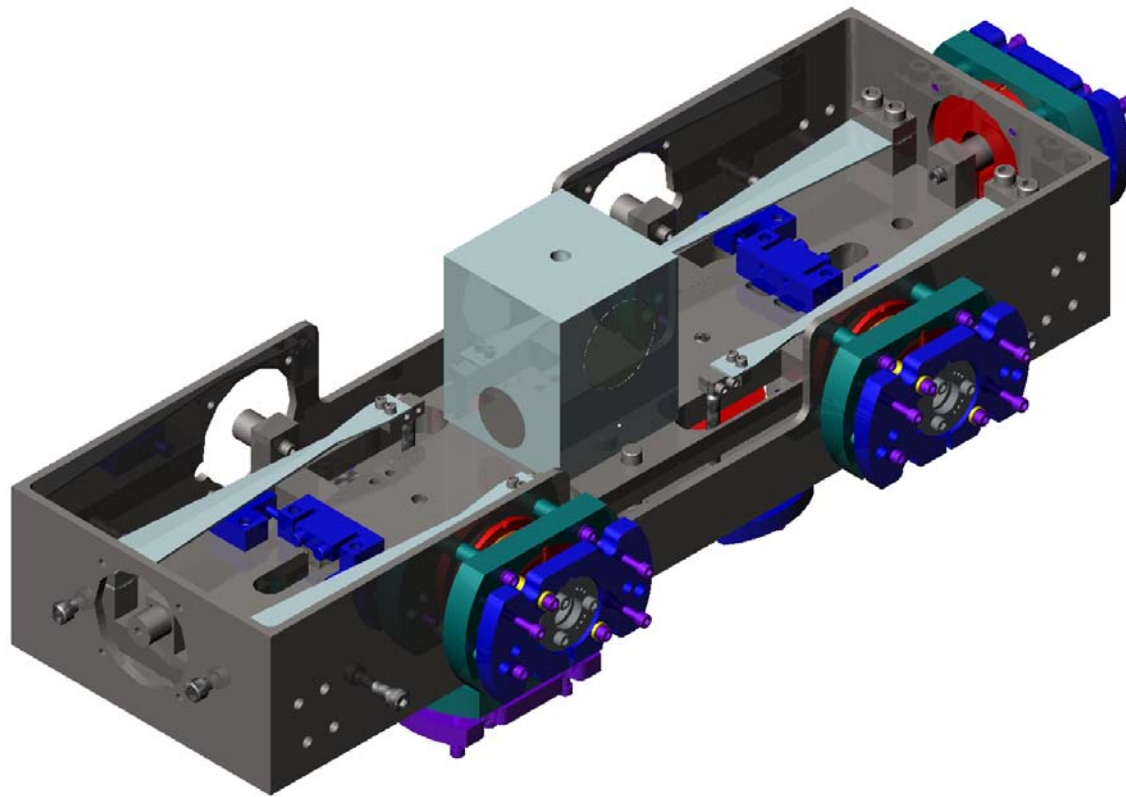

LIGO-G030388-02



ALUKGLA0034aAUG03

## FINE PITCH ADJUSTMENT



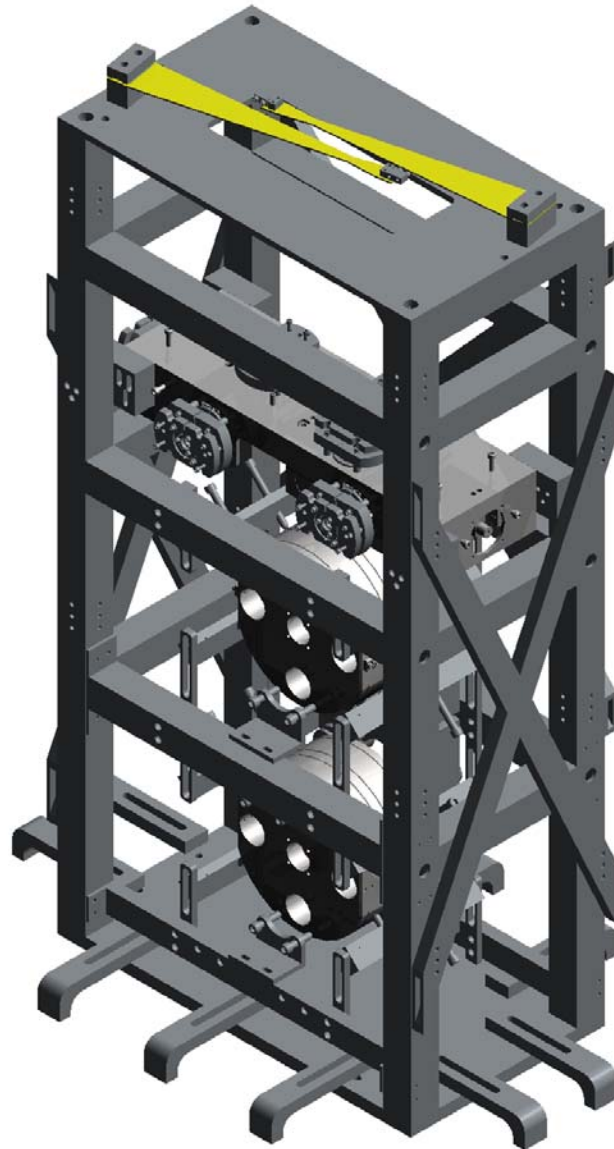

LIGO-G030388-02

ALUKGLA0034aAUG03

15

**UPPER CANTILEVER BLADES**

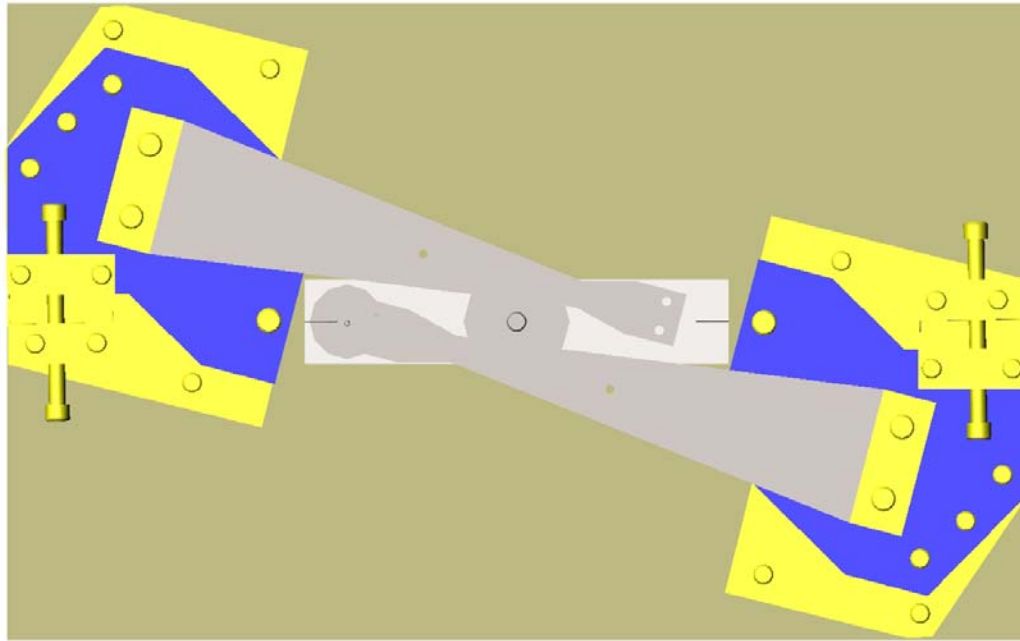



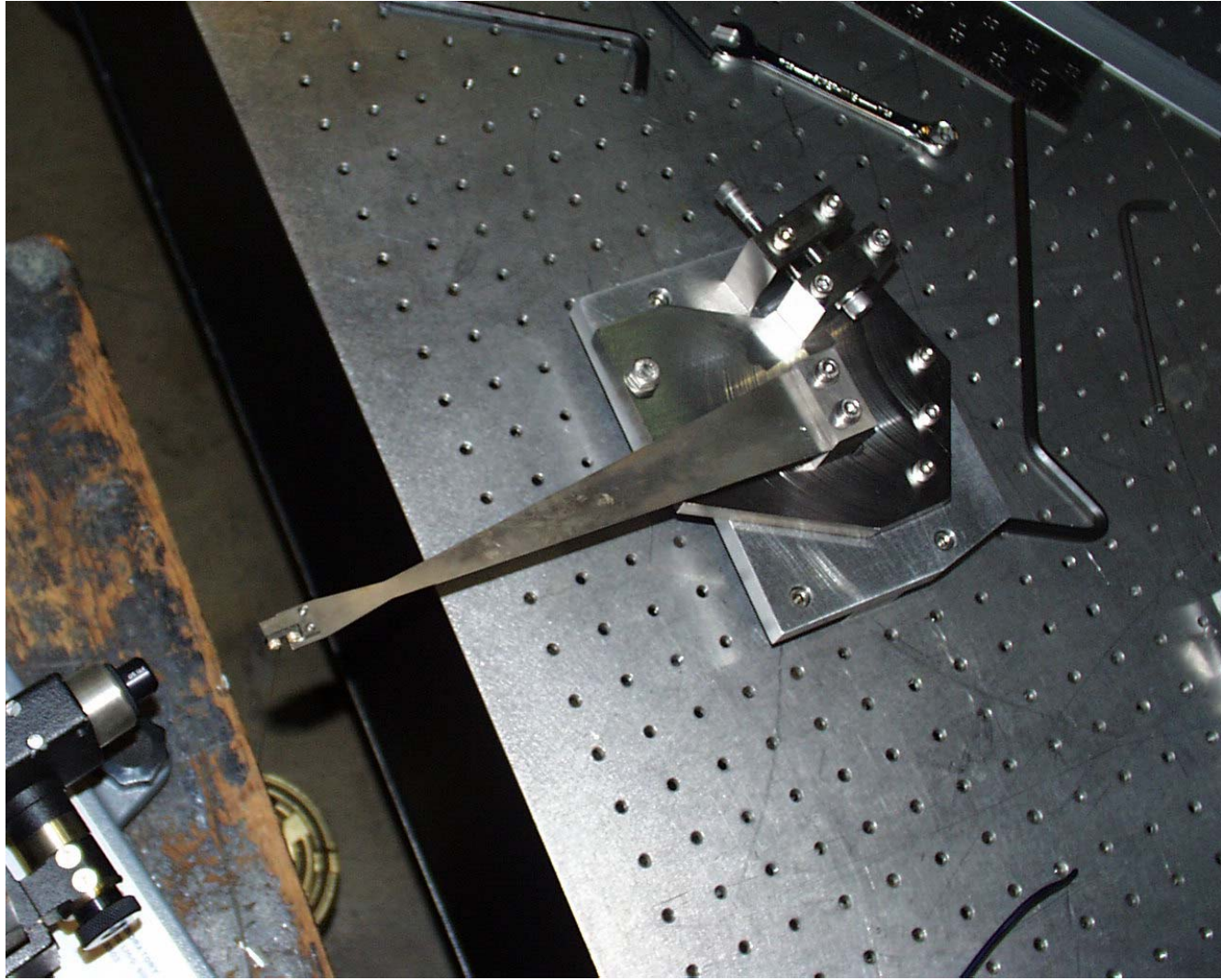

LIGO-G030388-02

ALUKGLA0034aAUG03

17

**PROTOTYPE YAW ADJUSTMENT**

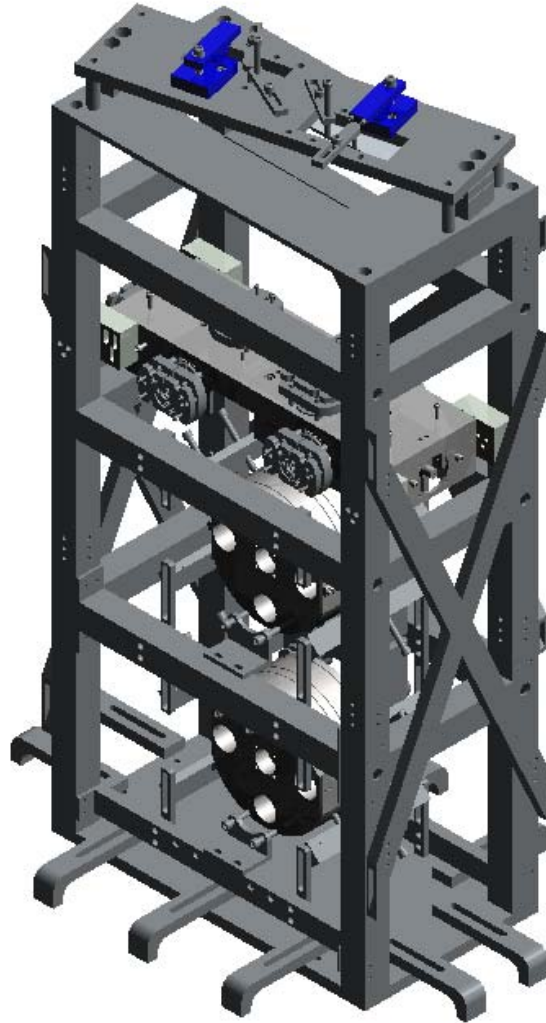

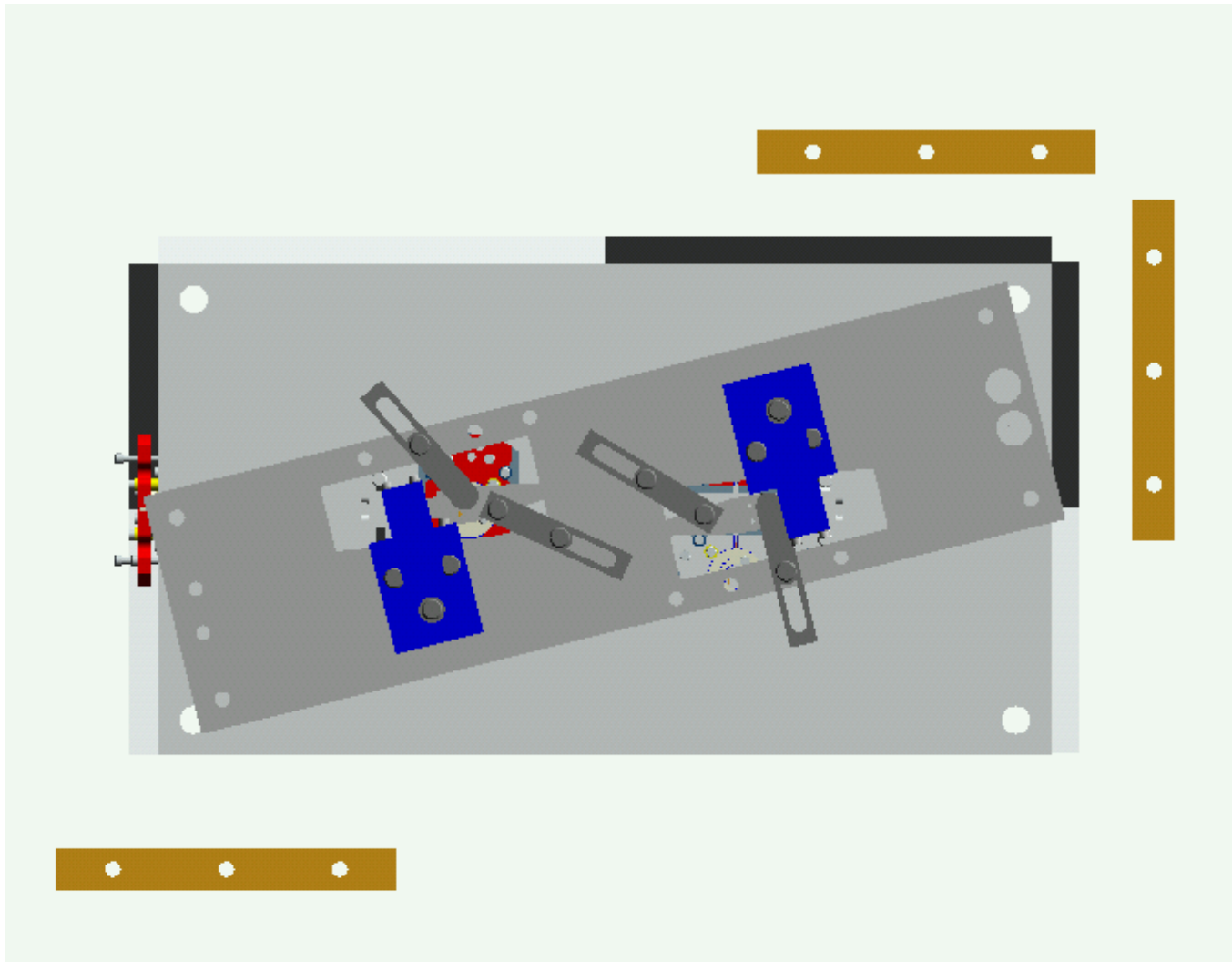

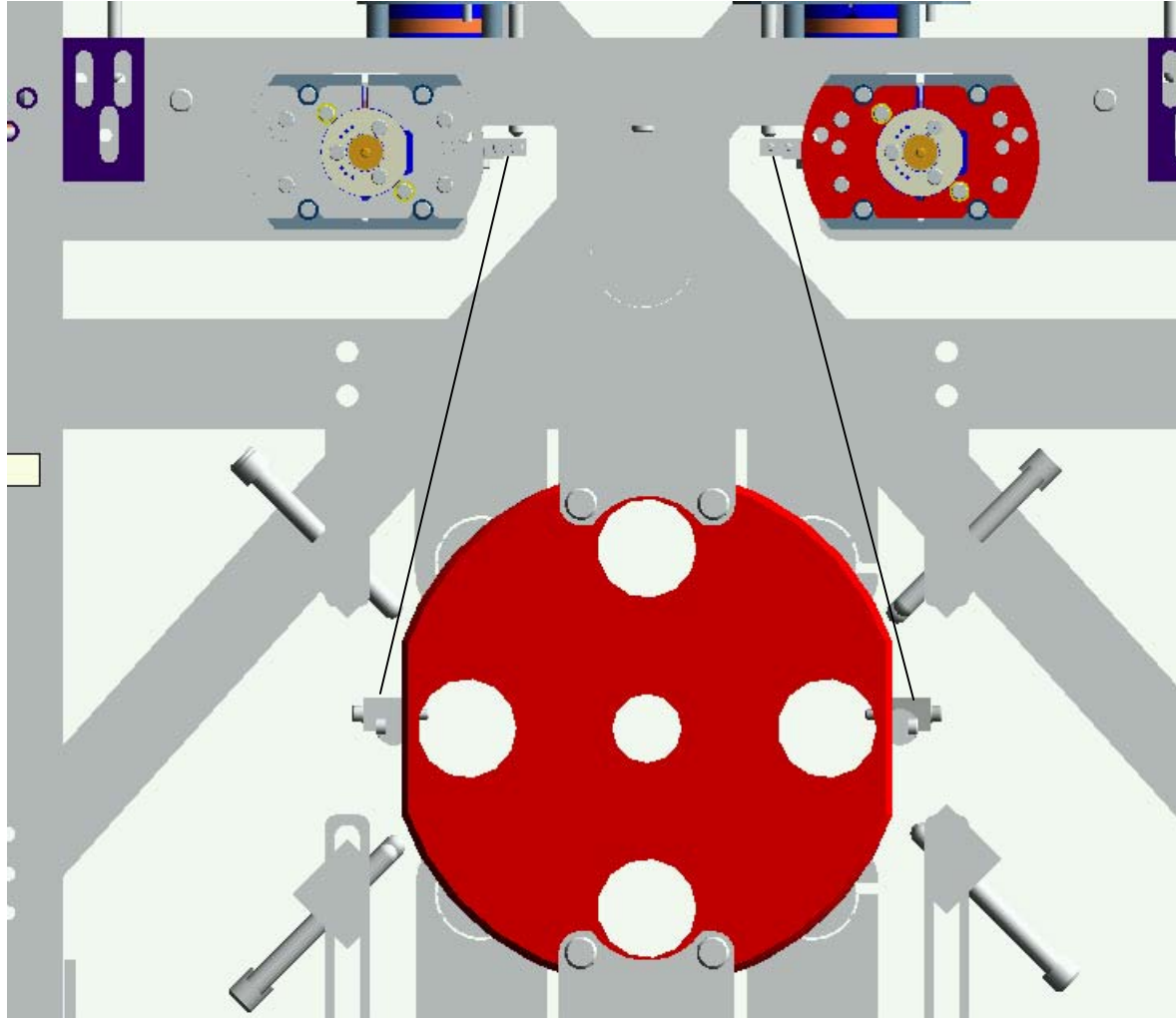

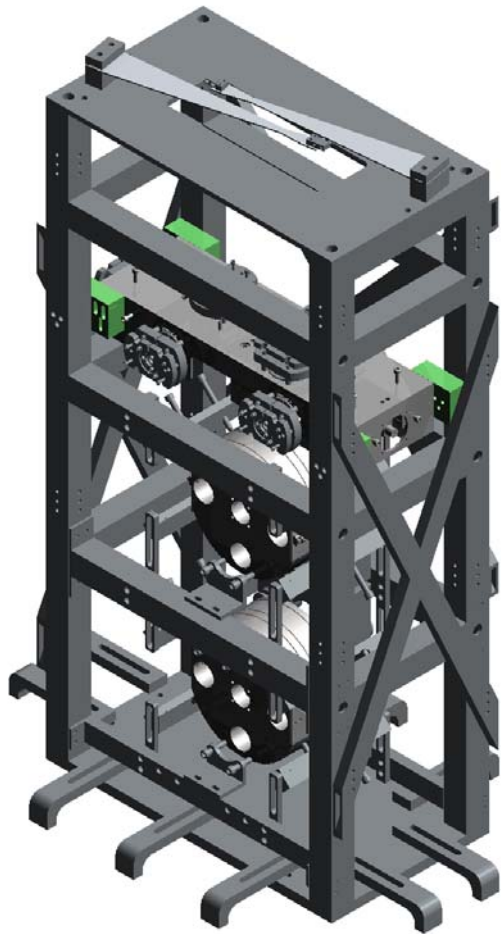

LIGO-G030388-02

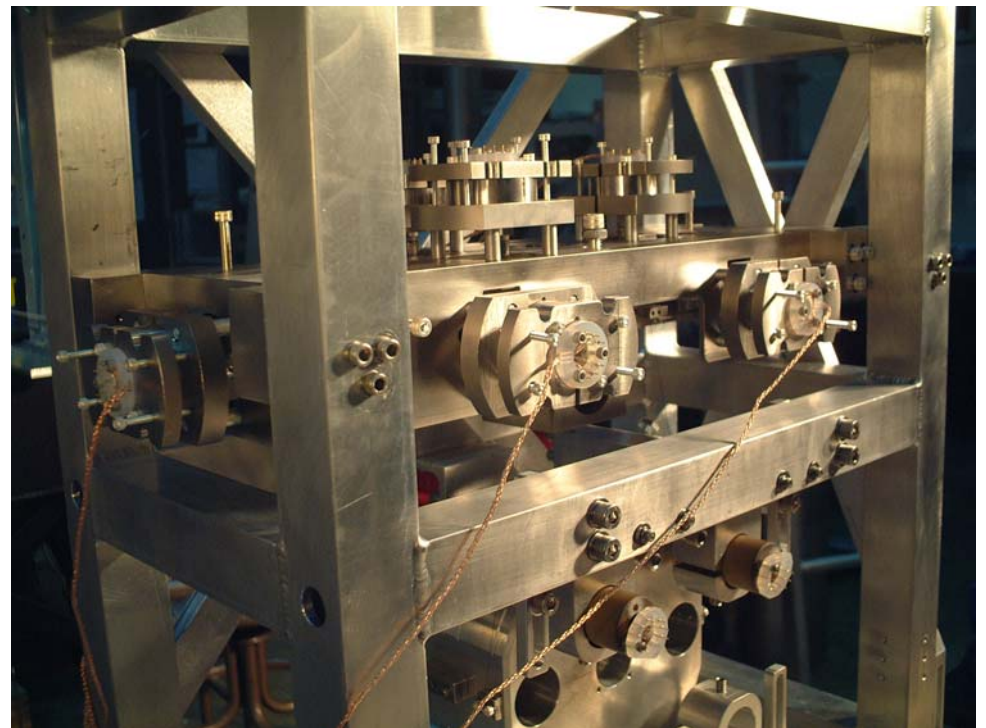

ALUKGLA0034aAUG03

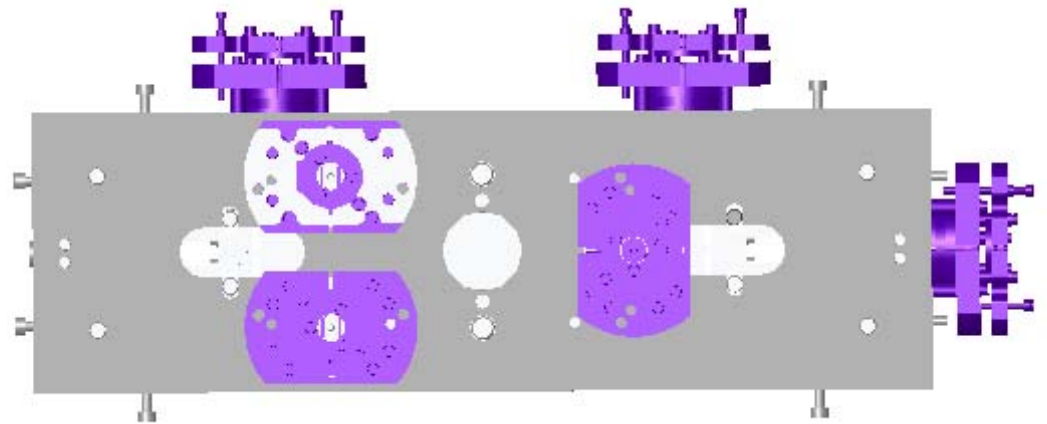
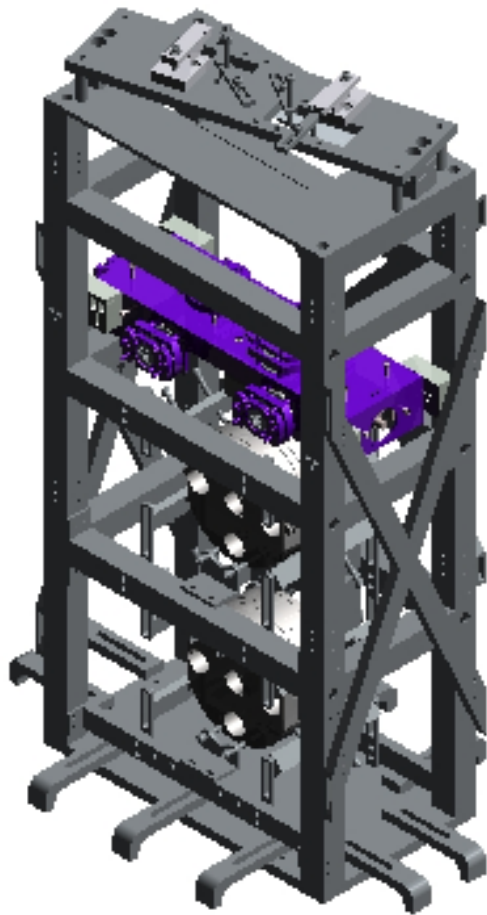

LIGO-G030388-02

SWITCH TO TALK ON COILS & ECDs

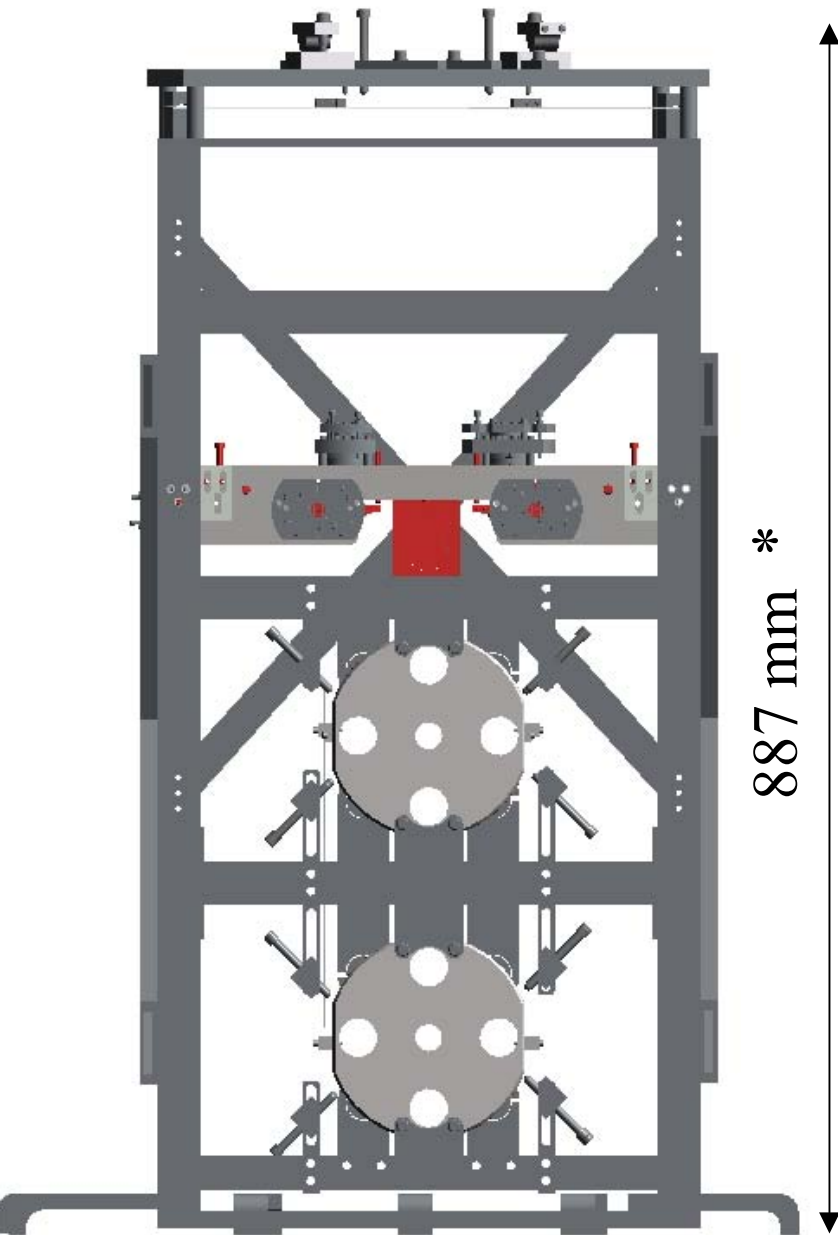

\* NO SHIM UNDER STRUCTURE

