

D1100453\_Enhanced Aluminum Mirror, CO2P VP ENCLOSURE, PART PDM REV: X-013, DRAWING PDM REV: X-007

**NOTES CONTINUED:**  
⑤ SCRIBE, ENGRAVE, LASER MARK OR MECHANICALLY STAMP (NO DYES OR INKS) A UNIQUE THREE DIGIT SERIAL NUMBER & REVISION NUMBER ON EACH PART. SERIAL NUMBERS START AT 001 FOR THE FIRST ARTICLE AND PROCEED CONSECUTIVELY. BAG AND TAG PARTS WITH THEIR DRAWING PART NUMBER, REVISION, VARIANT OR "TYPE" (IF APPLICABLE), AND QUANTITY. IF PARTS ARE TOO SMALL TO SCRIBE, BAGGING AND TAGGING ALONE IS SUFFICIENT.  
EXAMPLE (PART): 001-v1  
EXAMPLE (TAG): DXXXXXX-VY, TYPE-XX, QTY: TBD

- ⑥ DIAMETER (mm), 101.60  
DIAMETER TOLERANCE (mm), +0.0/-1.0
- THICKNESS (mm), 8.0  
THICKNESS TOLERANCE (mm), ±.5
- SURFACE ACCURACY, LAMBDA 1/10 @ 10.6um  
SURFACE QUALITY, 60-40
- SUBSTRATE, FUSED SILICA OR ZERODUR®  
COATING, ENHANCED, ALUMINUM
- ROHS, COMPLIANT
- APPROXIMATE WEIGHT = 0.347 LB (157.4 g)

REV.	DATE	DCN #	DRAWING TREE #
v1	25 JUL 2011	E1100655-v1	E1100656-v1
v2	04 OCT 2011	E1100983-v1	E1100656-v2
-	-	-	-

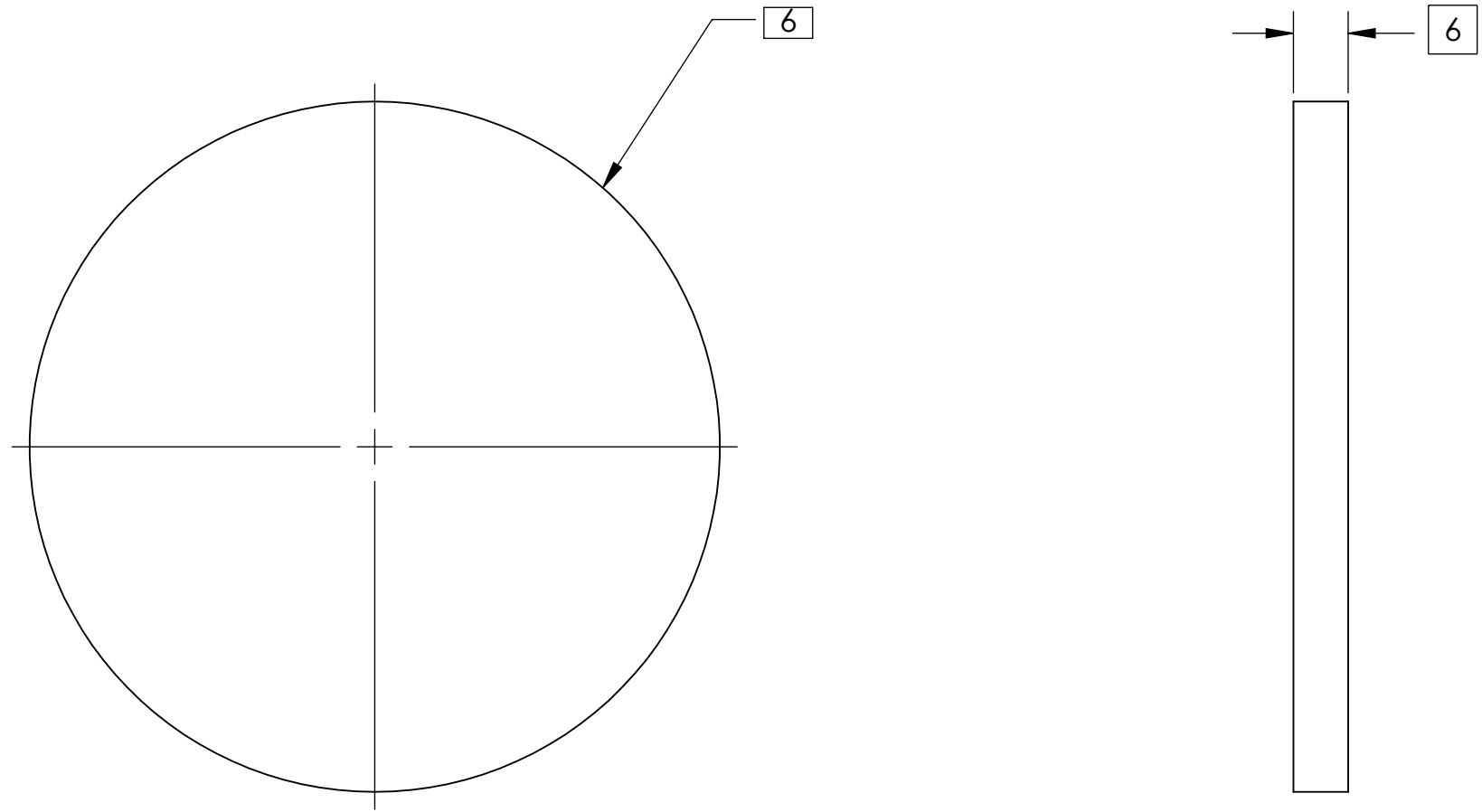

NOTES AND TOLERANCES: (UNLESS OTHERWISE SPECIFIED)	
DIMENSIONS ARE IN INCHES	1. INTERPRET DRAWING PER ASME Y14.5-1994.
TOLERANCES:	2. REMOVE ALL SHARP EDGES, .005-.015, FOR MACHINED PARTS. ROUND ALL EDGES APPROXIMATELY R.02 FOR SHEET METAL PARTS.
.XX ± .01	3. DO NOT SCALE FROM DRAWING.
.XXX ± .005	4. ALL MACHINING FLUIDS MUST BE FULLY SYNTHETIC, FULLY WATER SOLUBLE AND FREE OF SULFUR, SILICONE, AND CHLORINE.
ANGULAR ± 1.0°	
MATERIAL	SEE NOTE ⑥
FINISH	⑥

CALIFORNIA INSTITUTE OF TECHNOLOGY MASSACHUSETTS INSTITUTE OF TECHNOLOGY		PART NAME	
ADVANCED LIGO		ENHANCED ALUMINUM MIRROR, 4 IN DIA	
SYSTEM	SUB-SYSTEM	DESIGNER	DATE
	AOS	A. LANGLEY	23 MAR 2011
NEXT ASSY	D1101145	DRAFTER	DATE
		A. LANGLEY	23 MAR 2011
		CHECKER	DATE
		M. JACOBSON	25 JUL 2011
		APPROVAL	DATE
		A. BROOKS	03 OCT 2011
SIZE DWG. NO.		REV.	
B D1100453		v2	
SCALE: 1:1		PROJECTION:	
		SHEET 1 OF 1	