

D1101256_Enhanced Aluminum Mirror, CO2P VP ENCLOSURE, PART PDM REV: X-008, DRAWING PDM REV: X-004

NOTES CONTINUED:
5 SCRIBE, ENGRAVE, LASER MARK OR MECHANICALLY STAMP (NO DYES OR INKS) A UNIQUE THREE DIGIT SERIAL NUMBER & REVISION NUMBER ON EACH PART. SERIAL NUMBERS START AT 001 FOR THE FIRST ARTICLE AND PROCEED CONSECUTIVELY. BAG AND TAG PARTS WITH THEIR DRAWING PART NUMBER, REVISION, VARIANT OR "TYPE" (IF APPLICABLE), AND QUANTITY. IF PARTS ARE TOO SMALL TO SCRIBE, BAGGING AND TAGGING ALONE IS SUFFICIENT.
EXAMPLE (PART): 001-v1
EXAMPLE (TAG): DXXXXXX-VY, TYPE-XX, QTY: TBD

- D 6 DIAMETER [mm], 50.80
DIAMETER TOLERANCE [mm], +0.0/-1.0

THICKNESS [mm], UP TO 12.70
THICKNESS TOLERANCE [mm], ±1.5

SURFACE ACCURACY, BROADBAND LAMBDA 1/10
SURFACE QUALITY, 60-40

SUBSTRATE, FUSED SILICA OR ZERODUR®
COATING, ENHANCED, ALUMINUM

ROHS, COMPLIANT
- 7 APPROXIMATE WEIGHT = 0.14 LB

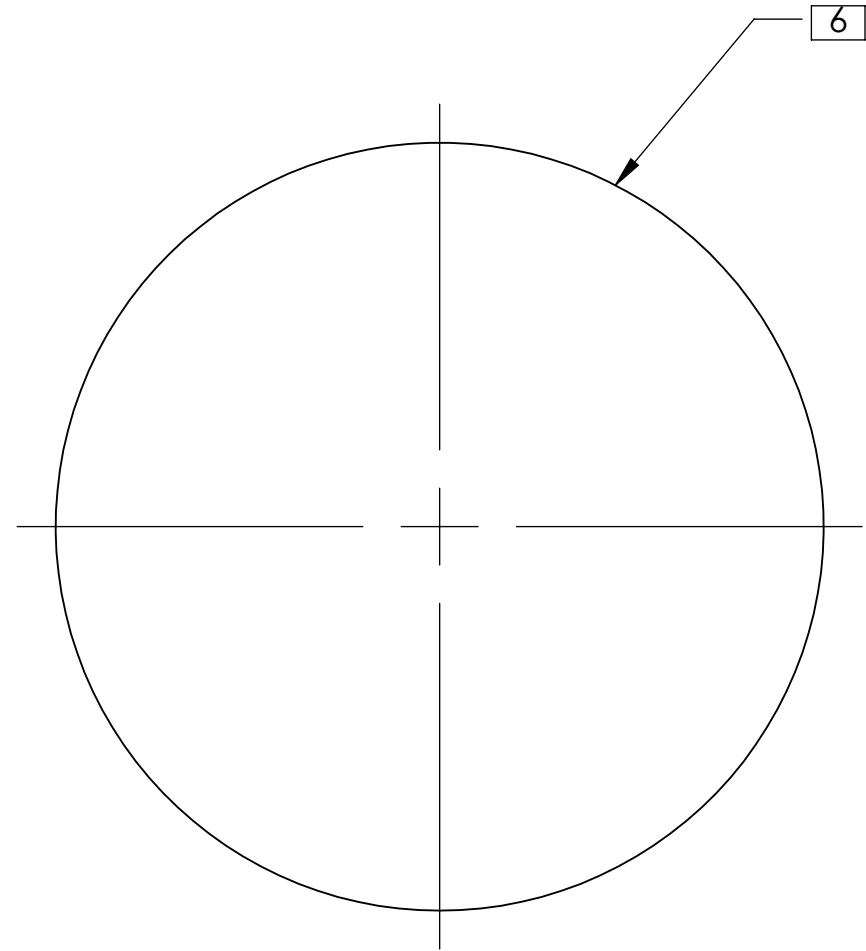

| REV. | DATE | DCN # | DRAWING TREE # |
|------|-------------|-------------|----------------|
| v1 | 20 JUL 2011 | E1100655-v1 | E1100656-v1 |
| v2 | 04 OCT 2011 | E1100983-v1 | E1100656-v2 |
| - | - | - | - |

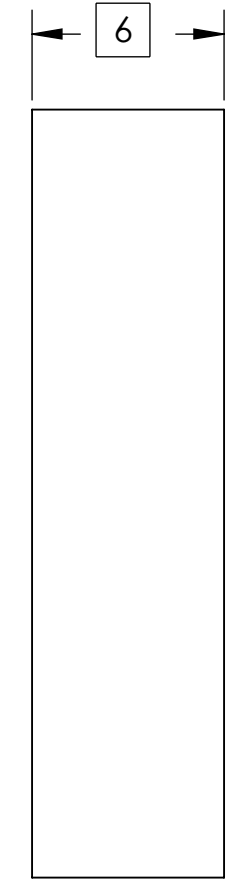

| NOTES AND TOLERANCES: (UNLESS OTHERWISE SPECIFIED) | |
|---|---|
| DIMENSIONS ARE IN INCHES [MM] | 1. INTERPRET DRAWING PER ASME Y14.5-1994. 2. REMOVE ALL SHARP EDGES, .005-.015, FOR MACHINED PARTS. ROUND ALL EDGES APPROXIMATELY R.02 FOR SHEET METAL PARTS. 3. DO NOT SCALE FROM DRAWING. 4. ALL MACHINING FLUIDS MUST BE FULLY SYNTHETIC, FULLY WATER SOLUBLE AND FREE OF SULFUR, SILICONE, AND CHLORINE. |
| TOLERANCES: .XX ± .01 .XXX ± .005 ANGULAR ± 1.0° | MATERIAL SEE NOTE 6 FINISH 6 μinch |

| | | | |
|---|-------------------|--|---------------------------|
| CALIFORNIA INSTITUTE OF TECHNOLOGY MASSACHUSETTS INSTITUTE OF TECHNOLOGY | | PART NAME 2" DIA, ENHANCED AI MIRROR, CO2P VP ENCLOSURE | |
| SYSTEM ADVANCED LIGO | SUB-SYSTEM AOS | DESIGNER A. LYNCH | 5 JUL 2011 |
| CHECKER M. JACOBSON | 20 JUL 2011 | SIZE DWG. NO. B | D1101256 |
| APPROVAL A. BROOKS | 02 OCT 2011 | SCALE: 2:1 | PROJECTION: SHEET 1 OF 1 |
| REV. | v2 | | |

8 7 6 5 4 3 2 1

C B A

D C B A

8 7 6 5 4 3 2 1