

D1101548 aLIGO, Uncoated high quality, non-wedged, 6in Viewport, Optic, PART PDM REV: X-001, DRAWING PDM REV: X-002

NOTES CONTINUED:

⑤ PERMANENTLY MARK DRAWING PART NUMBER, REVISION AND SERIAL NUMBER AT NOTED LOCATION. NO INKS OR DYES ARE TO BE USED. SERIAL NUMBERS START AT 01. USE MINIMUM .12" HIGH CHARACTERS. EXAMPLE: D1101548-V1, SN 01

- 6. APPROXIMATE WEIGHT = 1.7 LB.
- 7. MANUFACTURED IN ACCORDANCE WITH LIGO SPECIFICATION E1100733

REV.	DATE	DCN #	DRAWING TREE #
v1	2 AUG 2011	-	-
-	-	-	-
-	-	-	-

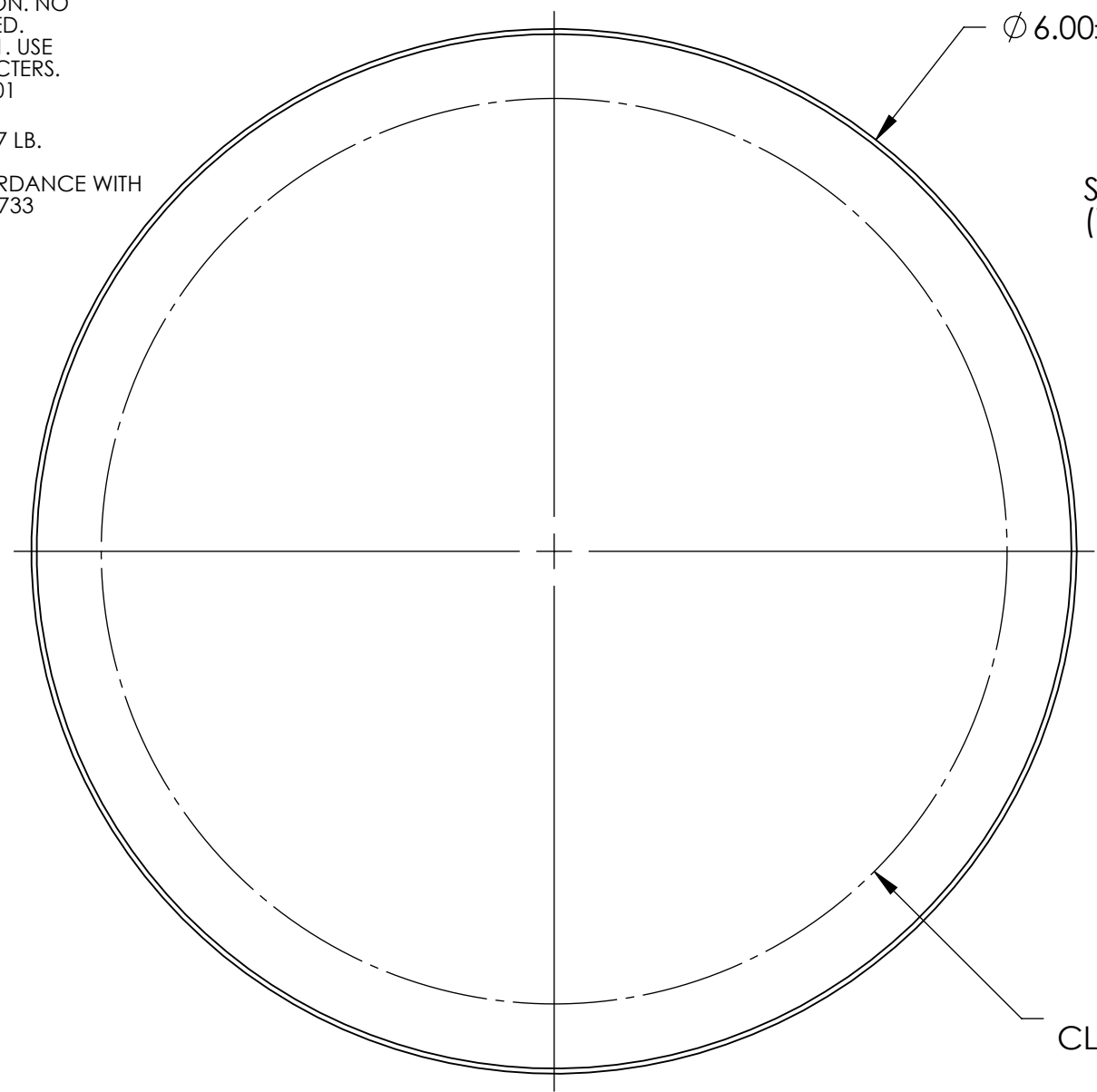

SIDE 1 (VACCUUM)

SIDE 2 (AIR)

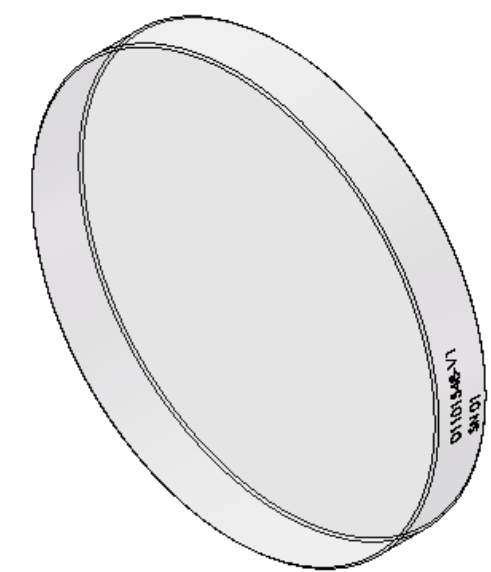
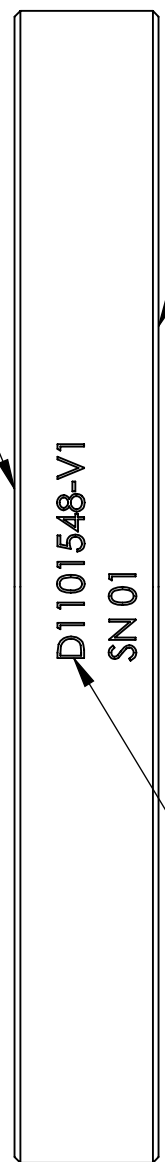

ETCH PART & SERIAL NUMBERS ON BARREL, SEE NOTES 5.

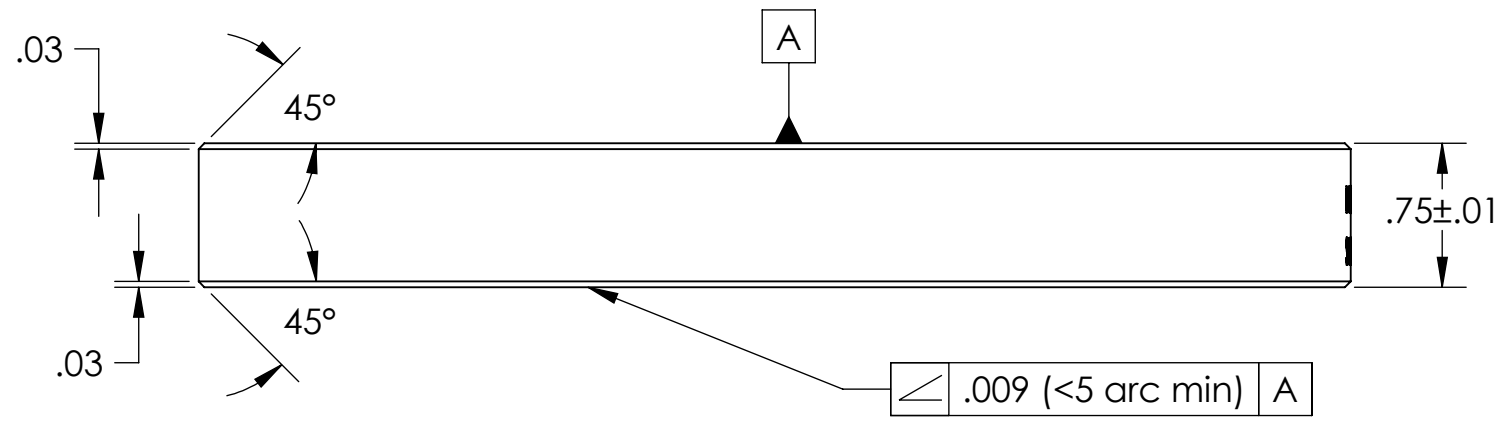

NOTES AND TOLERANCES: (UNLESS OTHERWISE SPECIFIED)	
DIMENSIONS ARE IN INCHES	
TOLERANCES: .XX ± .01 .XXX ± .005 ANGULAR ± 1.0°	
1. INTERPRET DRAWING PER ASME Y14.5-1994. 2. REMOVE ALL SHARP EDGES, .005-.015, FOR MACHINED PARTS. ROUND ALL EDGES APPROXIMATELY R.02 FOR SHEET METAL PARTS. 3. DO NOT SCALE FROM DRAWING. 4. ALL MACHINING FLUIDS MUST BE FULLY SYNTHETIC, FULLY WATER SOLUBLE AND FREE OF SULFUR, SILICONE, AND CHLORINE.	
MATERIAL	FINISH
FUSED SILICA	63 Raµinch

CALIFORNIA INSTITUTE OF TECHNOLOGY MASSACHUSETTS INSTITUTE OF TECHNOLOGY	PART NAME		Uncoated High Quality 6in, non-wedged Viewport Optic	
	DESIGNER	Dennis Coyne	8 JUN 2011	SIZE DWG. NO.
SYSTEM	AOS	SUB-SYSTEM	SLC	D1101548
DRAFTER	TQ. NGUYEN	2 AUG 2011	REV.	v1
CHECKER	M. SMITH		SCALE:	1:1
APPROVAL	see DCN		PROJECTION:	1ST ANGLE
			SHEET	1 OF 1