

NOTES CONTINUED:
 5. SCRIBE, ENGRAVE (A VIBRATORY TOOL MAY BE USED), LASER MARK OR MECHANICALLY STAMP (NO INKS OR DYES) DRAWING PART NUMBER, REVISION (AND VARIANT OR "TYPE" IF APPLICABLE) ON NOTED SURFACE OF PART FOLLOWED ON THE NEXT LINE WITH A THREE DIGIT SERIAL NUMBER. SERIAL NUMBERS START AT 001 FOR THE FIRST ARTICLE AND PROCEED CONSECUTIVELY. USE MINIMUM 0.12" HIGH CHARACTERS, UNLESS THE SIZE OF THE PART DICTATES SMALLER CHARACTERS. EXAMPLE: DXXXXXX-VY, TYPE-XX, S/N XXX

REV.	DATE	DCN #	DRAWING TREE #
v1	17JAN2012	E1200052	-
v2	18 SEP 2013	E1300716-x0	-
-	-	-	-

- D
- 6. APPROXIMATE WEIGHT = 1.0 LB.
 - 7. MACHINE ALL SURFACES TO REMOVE OXIDES AND MILL FINISH. USE OF ABRASIVE REMOVAL TECHNIQUES IS NOT ALLOWED. REFER TO LIGO-E0900364
 - 8. ALL PARTS SHALL BE MANUFACTURED IN ACCORDANCE WITH LIGO SPECIFICATION E0900364.
5. LABEL HOLES AS SHOWN.

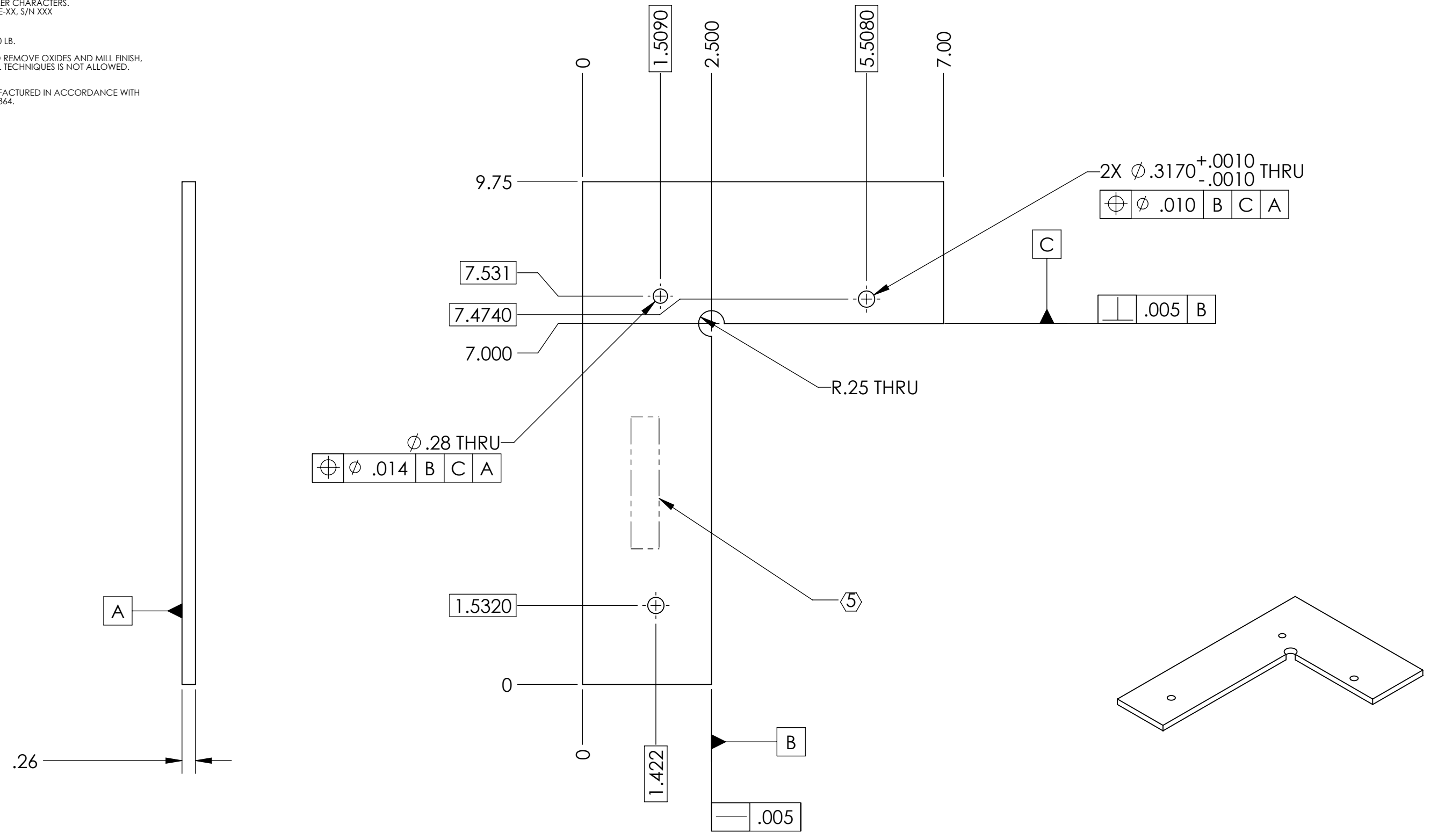

D1102451 LIGO SUS L1 H1 HAM5 HLTS PRE INSTALLATION PLATE, PART PDM REV: X-005, DRAWING PDM REV: X-003

HAM5-L1

(SEE SHEET 2 FOR H1 LAYOUT)

NOTES AND TOLERANCES: (UNLESS OTHERWISE SPECIFIED)	
DIMENSIONS ARE IN INCHES	
TOLERANCES: .XX ± .01 .XXX ± .005 ANGULAR ± 0.5°	
MATERIAL	6061-T6 Al
FINISH	63 μinch

CALIFORNIA INSTITUTE OF TECHNOLOGY MASSACHUSETTS INSTITUTE OF TECHNOLOGY		PART NAME	
SYSTEM ADVANCED LIGO		SUB-SYSTEM SUS	
DESIGNER	sbarnum	5 Jan 2012	SIZE DWG. NO.
DRAFTER	SBARNUM	29 Dec 2011	B
CHECKER	DBRIDGES		D1102451
APPROVAL	MMEYER		REV. v2
NEXT ASSY		D1102449	SCALE: 1:2
			PROJECTION:
			SHEET 1 OF 2

HAM5-H1

(SEE SHEET 1 FOR L1 LAYOUT)

D1102451 CALIGO SUS L1 H1 HAM5 HLTS PRE INSTALLATION PLATE, PART PDM REV: X-005, DRAWING PDM REV: X-003

D
C
B
A

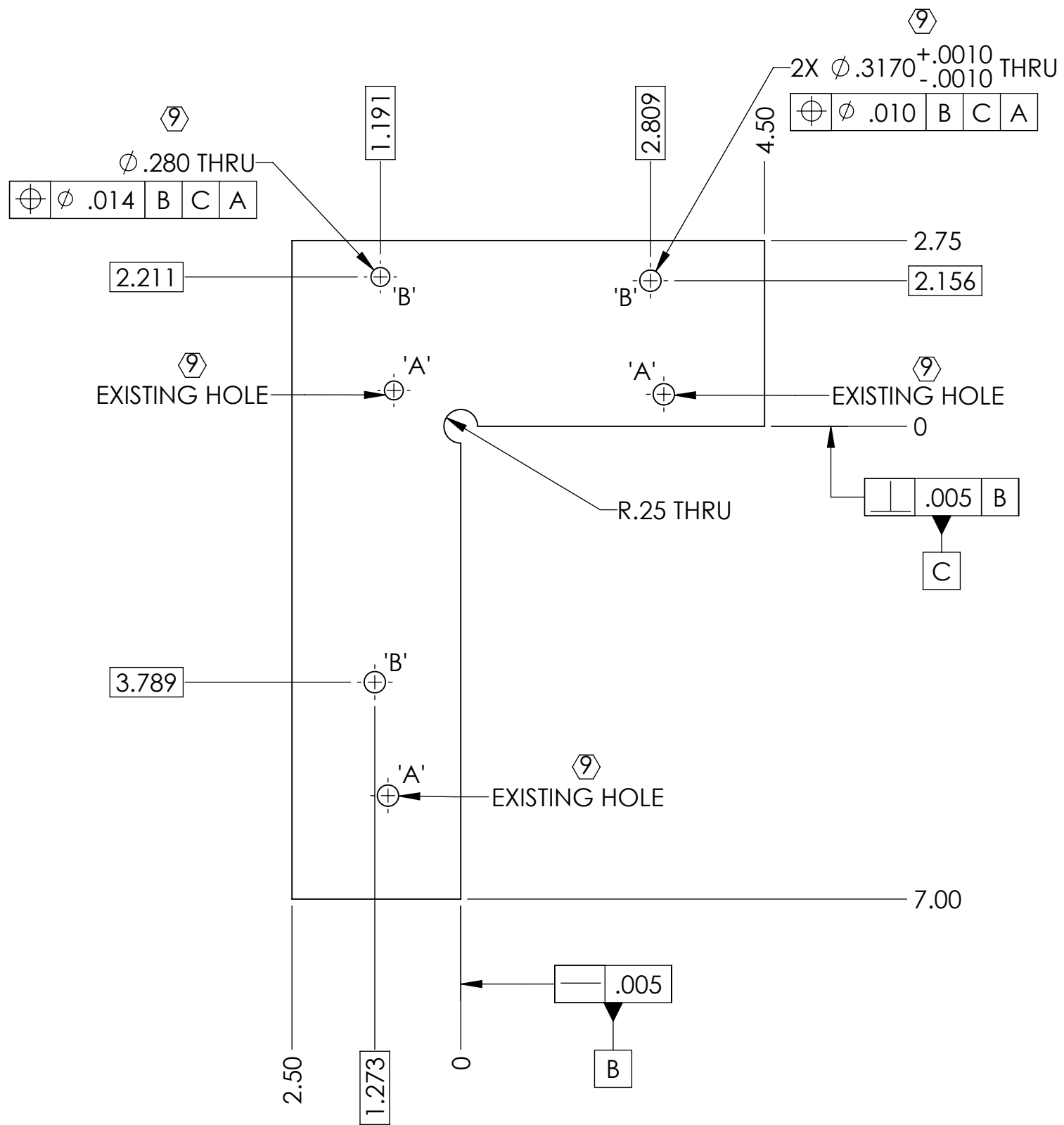
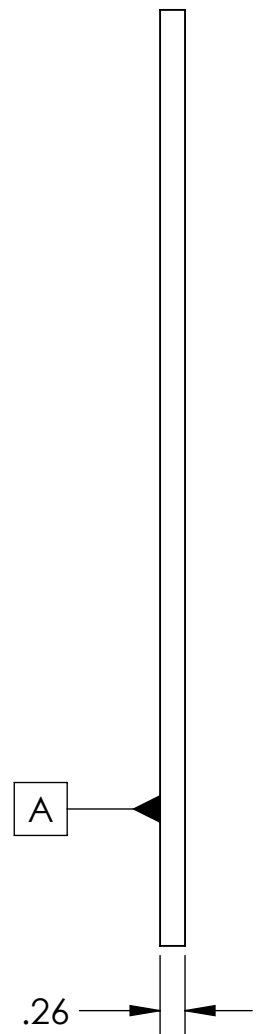

 CALIFORNIA INSTITUTE OF TECHNOLOGY MASSACHUSETTS INSTITUTE OF TECHNOLOGY		
SIZE	DWG. NO.	REV.
B	D1102451	v2
SCALE: 1:2	PROJECTION: 	SHEET 2 OF 2

8 7 6 5 4 3 2 1